



Day & Co
ESTATE AGENTS

28 Cavendish Street

Keighley

BD21 3RG



Laurel House, Woodville Road,
Keighley, West Yorkshire, BD20
6JB

£350,000

T: 01535 664609

W: www.dayandcoestateagents.co.uk

E: keighley@dayandcoestateagents.co.uk

- DETACHED FAMILY HOUSE
 - TWO RECEPTION ROOMS
 - GARDENS, AMPLE PARKING
- FOUR DOUBLE BEDROOMS
 - DOUBLE GARAGE
 - EPC RATING D

SUMMARY

** Individual Detached House, Four Double Bedrooms, En-Suite to Bed 1, Two Reception Rooms, Breakfast Kitchen, Utility Room, Double Garage, Ample Parking, Gardens, EPC Rating D **

FULL DESCRIPTION

Day & Co are pleased to be marketing for sale this individual, four double bedroom detached house situated in a popular suburb of Keighley. This property has a good sized front garden, double garage, ample parking and a viewing is advised to fully appreciate the accommodation on offer.

In brief the accommodation which is arranged over two floors comprises -

Ground Floor Entrance Hallway, Spacious Living Room with windows to the front elevation and patio doors to the rear. Dining Room with double doors from the hallway. Breakfast Kitchen with a range of wall and base units, worktops, sink. Utility Room with rear entrance door, internal door giving access to the garage. Ground Floor W.c.

First Floor - Landing, Four Double Bedrooms the largest having an en-suite Shower Room, Completing the accommodation is the house bathroom which has a modern suite comprising of a bath with shower over and screen, vanity wash hand basin with storage, w.c..

Gas central heating and double glazing.

Outside - Gated access, large front garden, driveway providing ample parking and giving access to a double garage. Smaller patio/garden area to the rear.

EPC Rating D

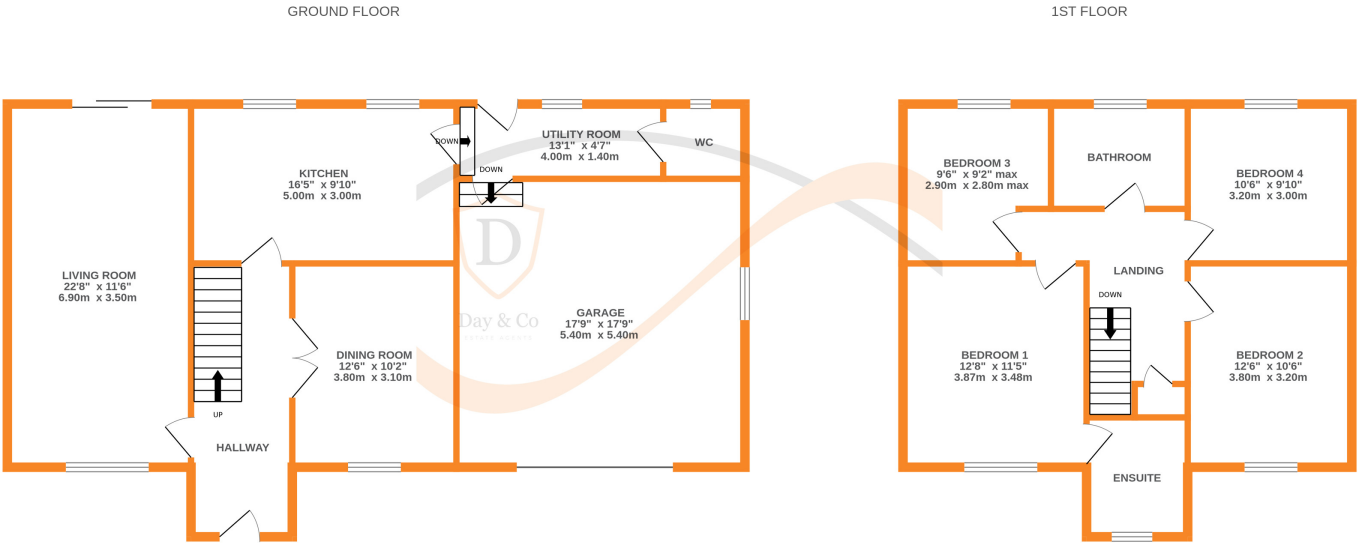

Whilst every attempt has been made to ensure the accuracy of the floorplan contained here, measurements of doors, windows, rooms and any other items are approximate and no responsibility is taken for any error, omission or mis-statement. This plan is for illustrative purposes only and should be used as such by any prospective purchaser. The services, systems and appliances shown have not been tested and no guarantee as to their operability or efficiency can be given.
Made with Metropix ©2025