



15 Ingrams Avenue, Bexhill-on-Sea, East
Sussex, TN39 5AT

£312,950



- Four Bed Semi Detached House
- Two Good Size Reception Rooms
- Modern Fitted Kitchen
- Three First Floor Bedrooms
- Ground Floor Bedroom (Bed 4)
- Central Heated & D.Glazed
- Modern First Floor Shower Room
- Ground Floor Shower Room.
- Separate Front Entrance (Annex Potential)
- Large South Facing Rear Garden
- Rear Access Drive & Garage
- Close To Sidley High Street
- Viewing Highly Recommended.
- Sold With No Onward Chain



GROUND FLOOR
520 sq.ft. (48.3 sq.m.) approx.

1ST FLOOR
388 sq.ft. (36.0 sq.m.) approx.

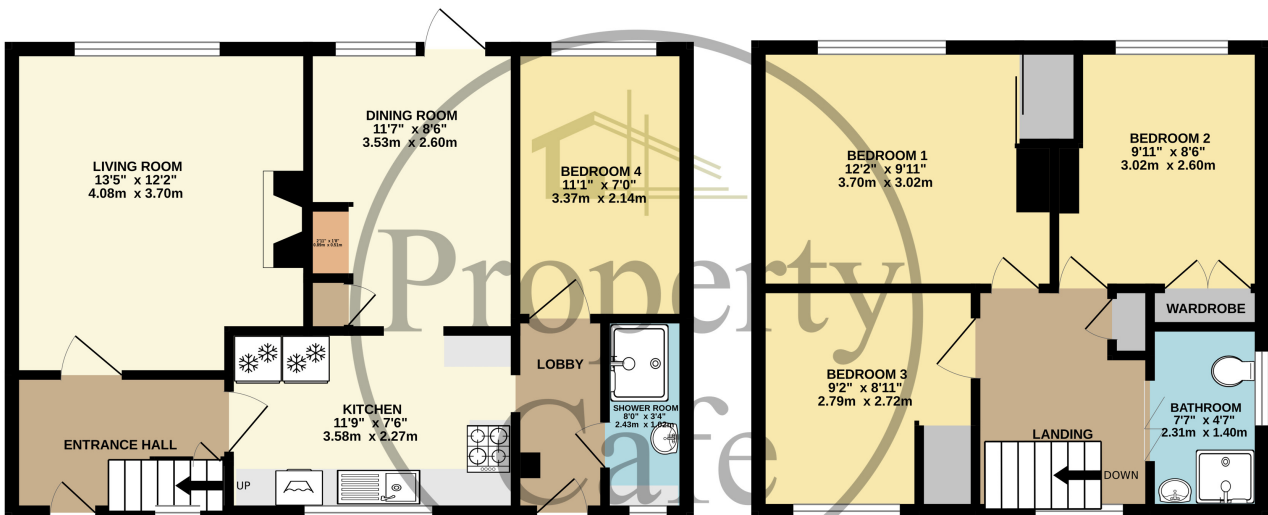

TOTAL FLOOR AREA : 908 sq.ft. (84.3 sq.m.) approx.

Whilst every attempt has been made to ensure the accuracy of the floorplan contained here, measurements of doors, windows, rooms and any other items are approximate and no responsibility is taken for any error, omission or mis-statement. This plan is for illustrative purposes only and should be used as such by any prospective purchaser. The services, systems and appliances shown have not been tested and no guarantee as to their operability or efficiency can be given.
Made with Metropix ©2024

