



Hertford Mews, Billy Lows Lane, Potters Bar, EN6 1XW

£120,000

- CHAIN FREE
- RECENT MODERN KITCHEN
- VIEWS OVER COMMUNAL AWARD WINNING GARDENS
- OVERNIGHT GUEST SUITE FOR VISITORS
- LAUNDRY ROOM
- IMMACULATELY PRESENTED
- RECENTLY REMODELLED SHOWER ROOM
- COMMUNAL LOUNGE WITH KITCHENETTE
- WALKING DISTANCE TO THE HIGH STREET

108, High Street, Potters Bar, EN6 5AT

01707 245 555

www.home-counties.com

Hertford Mews, Billy Lows Lane, Potters Bar, . EN6 1XW

£120,000 Leasehold

This delightful one bedroom apartment on the second floor of the popular development Hertford Mews, located just a short walk to shops and restaurants and both Highview & Annandale Medical Centres and Parkfield Open Space. The property is offered in immaculate condition and benefits from a recently fitted modern kitchen with Neff appliances, southerly views over the award winning gardens, recently remodelled shower room and new hot and cold water tanks.

Hertford Mews is a retirement block with assisted living, there is a manager on site and pull cords in the rooms in case of emergencies monitored 24hrs a day 365 days a year, there is a communal residents lounge and award wining gardens, residents laundry room and overnight guest suites available for visitors along with guest and resident off street parking.

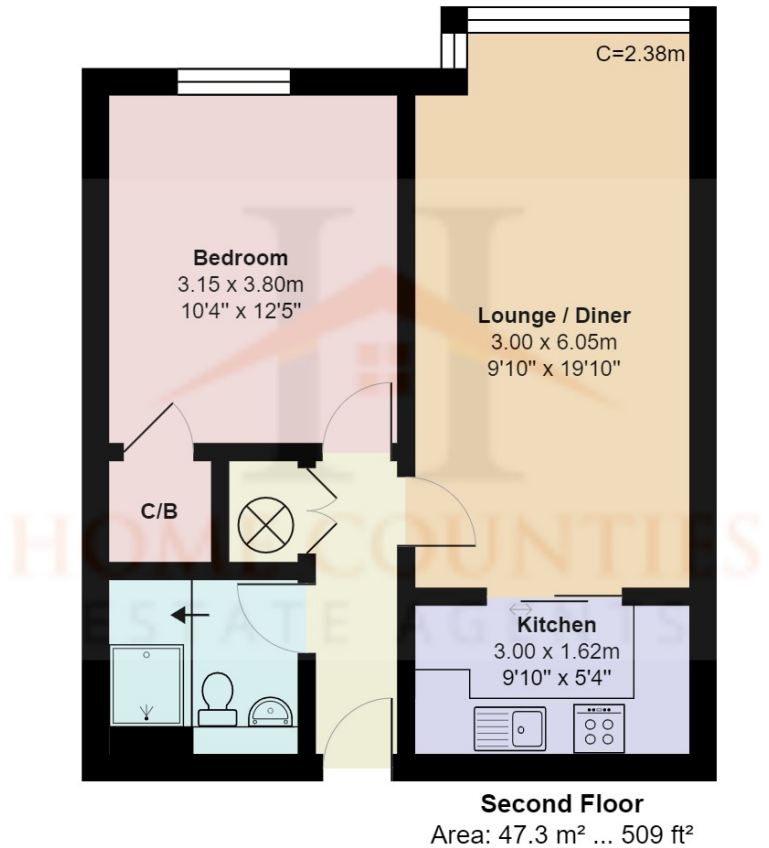

Hertford Mews, Hertfordshire EN6

Total Area: 47.3 m² ... 509 ft²
All measurements are approximate and for display purposes only

