

108a Meadfield Road, Langley, Berkshire. SL3 8JF.  
£265,000

- \*No Onward Chain\*
- Share of Freehold
- New Lease- 125 Years
- Ground Floor Maisonette
- Driveway Parking

- Walking distance of Langley Station (Elizabeth Line)
- Close by to a Number of OFSTED Rated Schools
- Easy Access to Heathrow Airport, M4 & M25 Motorways
- Ideal for First Time Buyers and Investors

# 108a Meadfield Road, Langley, Berkshire. SL3 8JF.

## £265,000

The Flatman Partnership are delighted to offer to the market with No Onward Chain, this rarely available Ground floor maisonette in a convenient location within walking distance to Langley Station (Elizabeth Line) and Langley Village. Features include an open plan lounge/dining room & kitchen, two spacious bedrooms, a modern three-piece bathroom, gas central heating, allocated driveway parking and an enclosed rear garden. The property would be an ideal purchase for an investor or first time buyer and benefits from a new 125 Year Lease and share of the freehold.

GROUND FLOOR

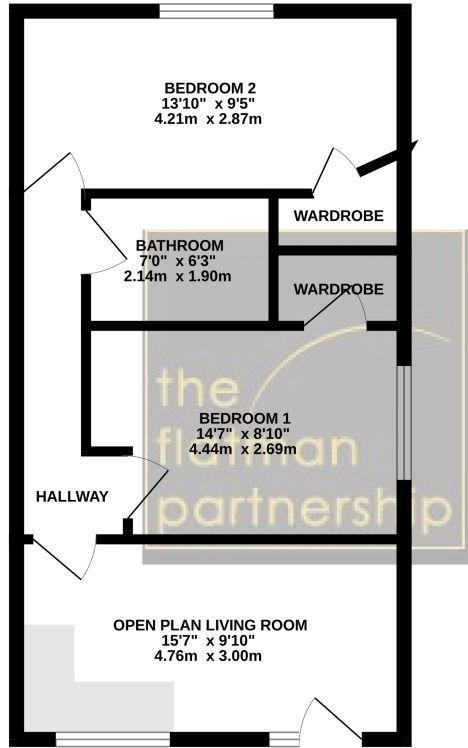

Whilst every attempt has been made to ensure the accuracy of the floorplan contained here, measurements of doors, windows, rooms and any other items are approximate and no responsibility is taken for any error, omission or mis-statement. This plan is for illustrative purposes only and should be used as such by any prospective purchaser. The services, systems and appliances shown have not been tested and no guarantee as to their operability or efficiency can be given.  
Made with Metropix ©2023

Energy Efficiency Rating		Current	Potential
<i>Very energy efficient - lower running costs</i>			
92-100	<b>A</b>		
81-91	<b>B</b>		
65-80	<b>C</b>		
55-68	<b>D</b>	70	77
39-54	<b>E</b>		
21-38	<b>F</b>		
1-20	<b>G</b>		
<i>Not energy efficient - higher running costs</i>			
England, Scotland & Wales		EU Directive 2002/91/EC	

