



37 Heron Drive Hurricane Court,
Hurricane Court, Langley, Berkshire. SL3
8FA.

£260,000

t: 01753 593888

w: www.flatmans.com

e: langleysales@flatmans.com

Features of Interest

- First Floor One Bedroom Apartment
- Immaculate Condition
- Light and Spacious Accommodation
- Gated Courtyard Development
- Allocated Gated Parking
- Finished to Very High Standards
- Beautifully Maintained Courtyard Garden
- Popular Residential Location
- Ideal for First Time Buyers and Investors
- Easy access to Langley Station and M4/ M25 Motorway Networks

Description

Hurricane Court is an exclusive gated courtyard development conveniently located within the heart of Langley Village and all its amenities including Langley train station- journey times from Langley will reduce significantly, Heathrow will be just 18 minutes, Paddington 24 minutes, Bond Street 28 minutes, Liverpool Street 35 minutes and Canary Wharf 43 minutes. With 46% of the homes in the area let to Tenants who have moved from London, this developments will appeal to homeowners and investors alike.

All apartments are finished to the highest of standards of The Nacropolis Group and features include fully fitted designer kitchen with integrated Bosch appliances, contemporary bathroom, living area with large windows, double bedroom with built in wardrobes and ample space for a work space/ living area. Further benefits include: gas central heating, allocated parking, long lease and secure residents-only landscaped courtyard gardens.

Viewings Highly Recommended

GROUND FLOOR
601 sq.ft. (55.8 sq.m.) approx.

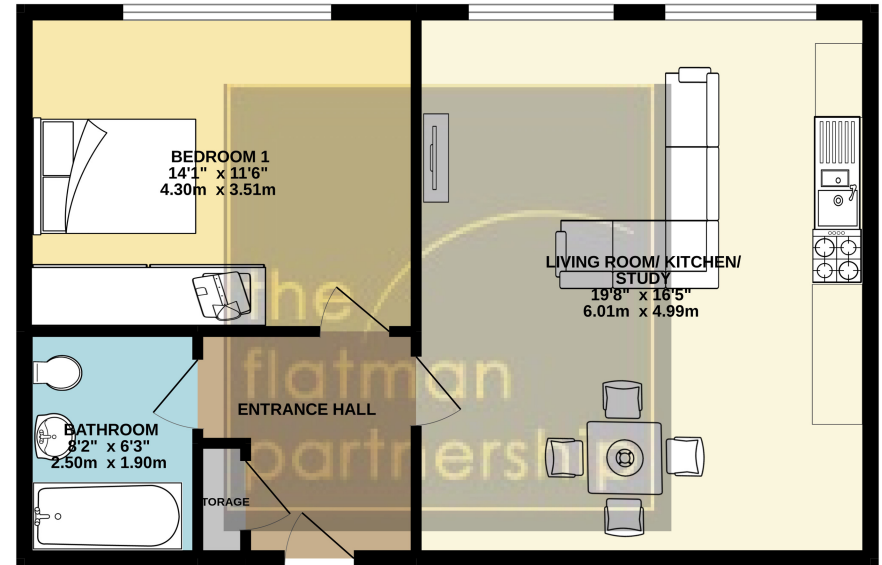

TOTAL FLOOR AREA: 601 sq.ft. (55.8 sq.m.) approx.
Whilst every attempt has been made to ensure the accuracy of the floorplan contained here, measurements of doors, windows, rooms and any other items are approximate and no responsibility is taken for any error, omission or mis-statement. This plan is for illustrative purposes only and should be used as such by any prospective purchaser. The services, systems and appliances shown have not been tested and no guarantee as to their operability or efficiency can be given.
Made with Metropix CS222