



Flat 7, 43 Eversley Road, Bexhill-on-Sea, East
Sussex, TN40 1HA

£199,950



- Three bedroom top floor apartment
- Well presented decoration throughout
- Pleasant West facing lounge
- Neutrally decorated split level hall
- Three usual bedrooms
- Central heating throughout
- Secure communal entrance with entry Phone
- Sought-after town centre location
- Close to seafront & mainline station
- Internal viewing highly recommended
- 125 year lease and low outgoings
- For additional details call (01424) 224488



TOP FLOOR

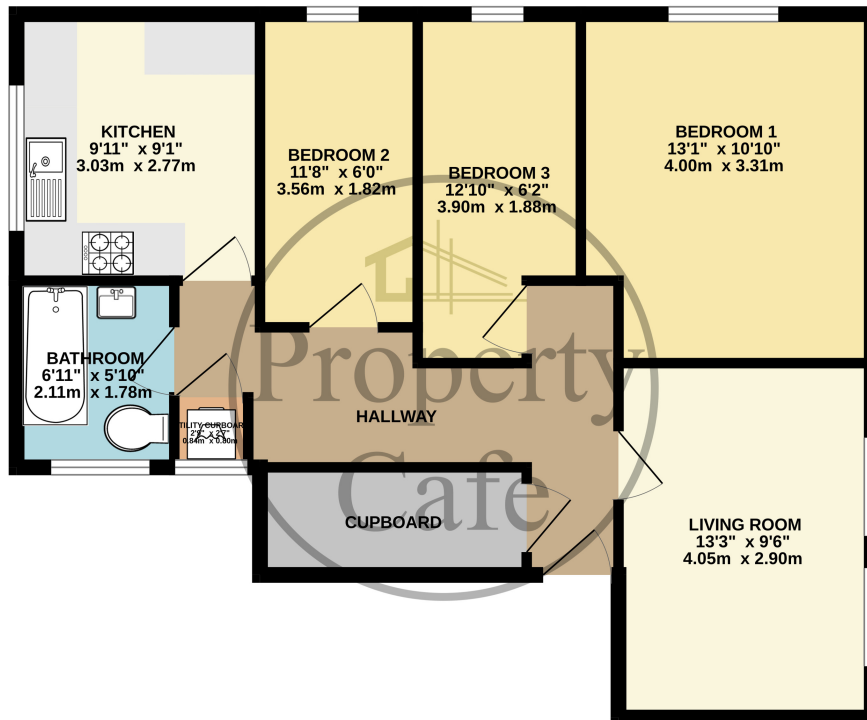

Whilst every attempt has been made to ensure the accuracy of the floorplan contained herein, measurements of doors, windows, rooms and any other items are approximate and no responsibility is taken for any error, omission or mis-statement. This plan is for illustrative purposes only and should be used as such by any prospective purchaser. The services, systems and appliances shown have not been tested and no guarantee as to their operability or efficiency can be given.
Made with Metropix 5/20/24