

Umberleigh Barton, Umberleigh
£875 pcm

John
Smale & Co.

Chartered Surveyors | Residential & Commercial Consultants



- 3 Bedroom Semi Detached Cottage
- Character cottage
- Double Garage/workshop
- Ample Parking

- Rural location
- Central Heating
- Shed & Garden
- EPC - Rating D

Manor Lodge Umberleigh Barton, Umberleigh, Devon, EX37 9DX

Delightful character cottage in rural location with large double garage/workshop, enclosed garden and garden shed. Large driveway and ample parking. Kitchen, dining room, lounge with open fireplace, ground floor bathroom with shower over bath. Landlords will consider a pet.

EPC LINK - <https://find-energy-certificate.digital.communities.gov.uk/energy-certificate/9510-2521-6020-2500-1091>

Entrance Porch

Dining Room

3.61m x 3.81m (11' 10" x 12' 6")

Storage cupboard, Radiator, Carpet. window to front aspect. door to Lounge, kitchen and stairway.

Lounge

2.58m x 4.93m (8' 6" x 16' 2")

fireplace, Radiator, carpet, Honeywell timer control, Window to front aspect and door to rear aspect.

Kitchen

2.24m x 2.87m (7' 4" x 9' 5")

Fitted cabinets, inset stainless steel single sink & drainer. Space for oven, washing machine & fridge/freezer. Window to side & front access. Vinyl flooring

Bathroom - Ground floor

1.94m x 2.29m (6' 4" x 7' 6")

Three piece white suite with Myra electric shower over bath, Mirrored cabinet, radiator, extractor fan, vinyl flooring

Stairs & Landing

Master Bedroom

2.72m x 5.06m (8' 11" x 16' 7") into recess 3.29

Carpet, radiator, window to front aspect.

Bedroom 2

2.930m x 4.75m (9' 7" x 15' 7")

Dual aspect windows to side and front aspect. Carpet, Radiator.

Bedroom 3

2.99m x 3.60m (9' 10" x 11' 10") into recess
Ornamental fireplace, carpet, radiator

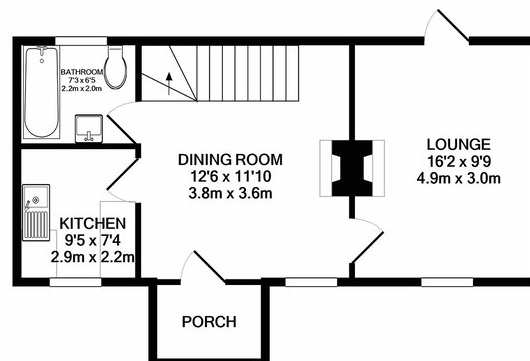

GROUND FLOOR

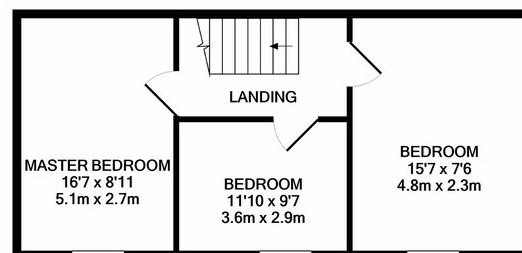

1ST FLOOR

Made with Metropix ©2021

At John Smale & Co we don't just sell houses! ...

Contact us now for information on all of our other services including Residential and Commercial Lettings, Property Management, Commercial Property Sales, Probate Valuations, Independent Financial Advice, Energy Performance Certificates, Auctions and New Homes.

These particulars have been prepared for guidance only. We have not carried out a detailed survey, not tested the services, appliances or specific fittings. Floor plans are not drawn to scale unless stated, measurements and distances are approximate only. Do not rely on them for carpets and furnishings. Photographs are not necessarily current and you should not assume that contents shown are included in the sale.

Email: lettings@johnsmale.com Website: www.johnsmale.com

5 Cross Street Barnstaple EX31 1BA

Offices also @ London (Mayfair Office)

Tel: 01271 329345