



HILTON KING & LOCKE

SPECIALISTS IN PROPERTY



19 Heathlands, Beaconsfield Road, Farnham Common, Buckinghamshire. SL2 3FQ.

£1,800 pcm

A superb rental opportunity for the over 60's searching for a welcome and elegant rental. A stunning retirement village within our charming Farnham Common village and ideal for those down sizing or taking time out from the stress of the property market .

Heathlands is a Retirement Living development built by the renowned McCarthy & Stone - the only house builder to win the Home Builders Federation 5 star award for thirteen years running.

Designed exclusively for the over 60's, this development comprises of 20 one and two bedroom apartments with numerous communal facilities such as a Club Lounge, Guest Suite and beautiful landscaped gardens. There are also lifts to all floors.

You will find spacious living and dining areas, fully fitted kitchens and well appointed level access shower rooms all tastefully finished to the highest standard.

There is a 24 hour emergency call system provided by a personal pendant as well as an on-site House Manager during office hours. The stunning club lounge is designed for you to relax with family and friends in comfortable surroundings and there is Guest accommodation with TV available (for an extra charge) when family and friends come to stay. You are free to enjoy book clubs, film nights and day trips can be booked.

This one bedroom first floor apartment features an open plan living dining and kitchen with breakfast bar.

The property benefits from a private terrace to step out onto ,enjoy warmer weather whilst over looking beautiful views and the village surrounds. The master bedroom is superbly spacious with additional space - perfect for reading area and quiet contemplation. A luxurious shower room completes the apartment.



An exquisite property with so much to offer - a rare opportunity to enjoy a such a remarkable rental property .

Please call 01753 643 555 or email [lettings@hklhome.co.uk](mailto:lettings@hklhome.co.uk) to arrange an appointment at your earliest convenience.

Water rates are included in the rental.

#### AREA

Situated in the heart of the action, with The Broadway at your doorstep, you'll have access to a diverse range of shops and dining options, including Costa Coffee, Tesco, Sainsburys and the very popular La Cantina Del Vino Italian restaurant.

Farnham Common is ideally situated for numerous leisure facilities including the 500 acres of historic woodland at Burnham Beeches, ideal for its attractive country walks, cycling paths and a relaxing café.



### Energy Efficiency Rating

	Current	Potential
Very energy efficient - lower running costs		
(92+) <b>A</b>		
(81-91) <b>B</b>	<b>84</b>	<b>84</b>
(69-80) <b>C</b>		
(55-68) <b>D</b>		
(39-54) <b>E</b>		
(21-38) <b>F</b>		
(1-20) <b>G</b>		
Not energy efficient - higher running costs		
<b>England, Scotland &amp; Wales</b>	EU Directive 2002/91/EC	

#### Important Notice

Particulars: These particulars are not an offer or contract, nor part of one. You should not rely on statements by Hilton King & Locke Ltd in the particulars or by word of mouth or in writing as being factually accurate about the property, its condition or its value. Hilton King & Locke Ltd does not have any authority to make any representations about the property, and accordingly any information given is entirely without responsibility on the part of the agents, seller(s) or lessor(s).

Photographs etc: The photographs show only certain parts of the property as they appeared at the time they were taken. Areas, measurements and distances given are approximate only.



The Broadway  
Farnham Common Buckinghamshire SL2 3QH

Tel: 01753 643555  
[fc@hklhome.co.uk](mailto:fc@hklhome.co.uk)

# 19 Heathlands, Beaconsfield Road

Approximate Gross Internal Area  
67.2 sq m / 723 sq ft

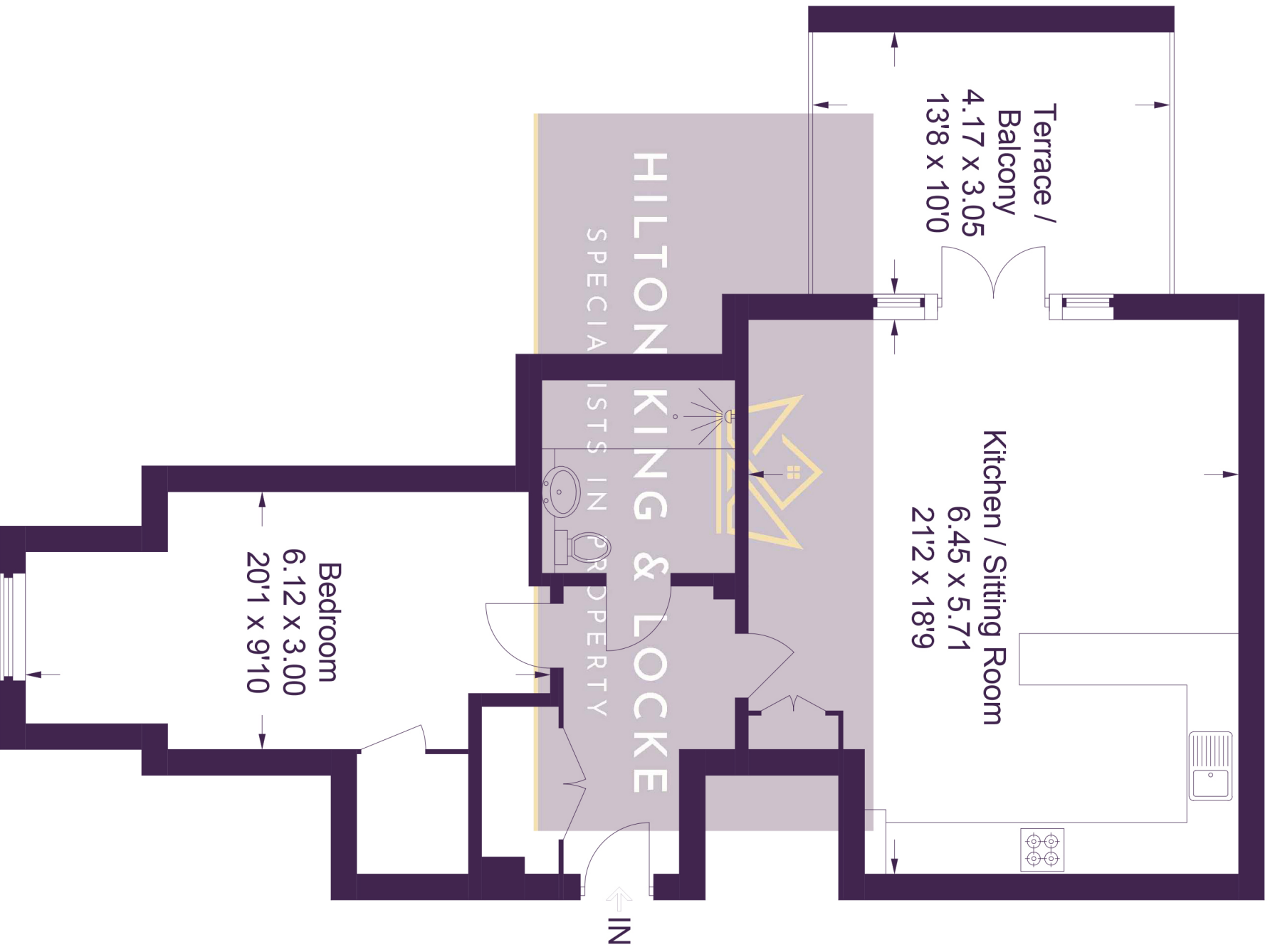

This plan is for layout guidance only. Not drawn to scale unless stated. Windows and door openings are approximate. Whilst every care is taken in the preparation of this plan, please check all dimensions, shapes and compass bearings before making any decisions reliant upon them.