

# Truuli



## Elliott Road, Thornton Heath, Surrey, CR7

£225,000 Leasehold

- Plenty of internal storage
- Modern and stylish decor throughout
- Close proximity to all local amenities & transportation
- Thornton Heath Leisure centre 0.5 miles away
- Peaceful residential area
- Located on a one-way road

2, Lansdowne Road, Croydon, Surrey, CR9 2ER

Tel: 0330 043 0002

Email: [save@truuli.co.uk](mailto:save@truuli.co.uk) Web: [www.truuli.co.uk](http://www.truuli.co.uk)

# Elliott Road, Thornton Heath, Surrey, CR7

£225,000 Leasehold

\*\*\*Vendors Comments\*\*\* "We have been living in our flat for over three years now.

We are looking for a bigger property as we need another bedroom for our little boy and this is the only reason why we have decided to sell our lovely home.

When we moved in we did a lot of work on the place and became our little cosy nest. There is a new Vaillant boiler with a remote control. We also made the most of the available space making a bespoke wardrobe, a very spacious shoe cabinet and storage in the open plan kitchen with sliding doors.

The property is located in the top floor and is ideal for a couple or single professionals. It has very good transport links with a train station roughly a six minutes walk away. For shopping there is a big Tesco, Iceland and many local shops nearby, too finally.

The property is located in a residential area and our neighbours are all incredibly friendly".

## Elliott Road

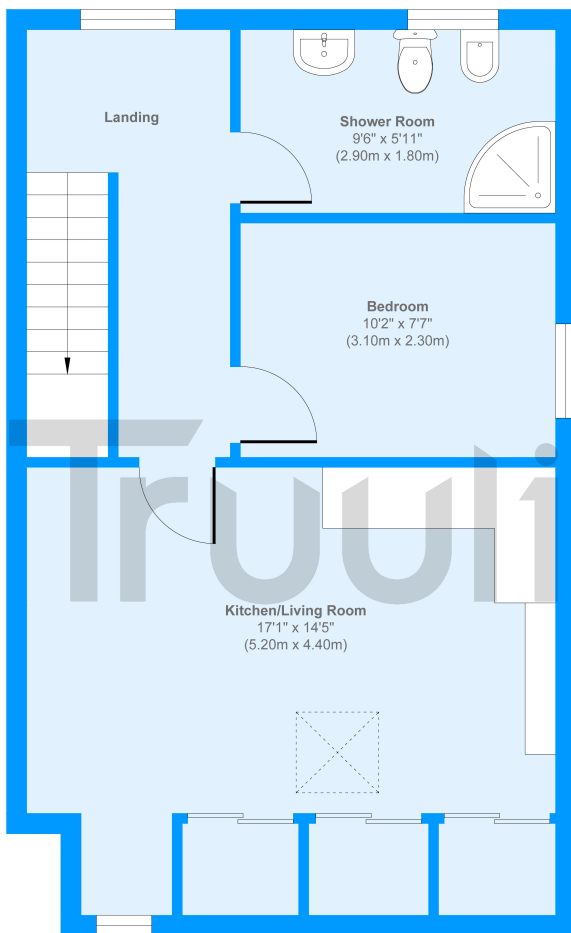

Floor Plan  
Approximate Floor Area  
481 sq. ft  
(44.72 sq. m)

Approx. Gross Internal Floor Area 481 sq. ft / 44.72 sq. m

Produced by Elements Property

