

Bridge Cottage, Bridge End

Radwell, Bedfordshire MK43 7HU



PERFECTLY
CONNECTING
PEOPLE AND
PROPERTY







Stone and Slate Cottage in Riverside Hamlet – with Potential Annexe and Gorgeous Gardens

A wonderful, stone and slate, unlisted and detached, 4-bedroom cottage on a quarter of an acre plot in the North Bedfordshire, riverside hamlet of Radwell, with simply delightful gardens backing onto fields. With driveway parking for at least 6 cars through electric gates and a garage integrated into an annexe that could be made into a self-contained home for elderly parents, Bridge Cottage is made for multi-generational living – or for earning an additional income. There's even scope for increasing value by converting a huge loft space that already has its own window.

Radwell is part of the historic parish of Felmersham, lying between Sharnbrook, with its schools for all ages, surgery, shops, theatre and Paula Radcliffe community sports centre and gym, and Milton Ernest, with its popular garden centre, shop and coffee bar - far enough from main road traffic noise, yet under 5 miles along the A6 from Milton Ernest to the County town's fast trains, which reach London in under 40 minutes, and the world-renowned Harput Trust private schools. Radwell's primary school is in Felmersham, less than a mile away from your front door.

Mentioned in the Domesday Book, Felmersham with Radwell is particularly known for the glorious 13th century Church of St Mary, referred to by Nikolaus Pevsner as "the noblest parish church in the country". Fabulous countryside surrounds the parish, with wonderful, circular walks straight from your doorstep. Step out along the beautiful River Great Ouse to Pavenham Golf Club, or to Pinchmill islands and the nature reserves near Sharnbrook. Swim or boat from Felmersham's community gardens, followed by a drink or meal at the highly thought of 17th century Sun Inn. Weekends at Bridge Cottage feel like being on holiday.



Bridge Cottage, Bridge End

Radwell, Bedfordshire MK43 7HU



AT A GLANCE

4 bedrooms (one downstairs), 2 bathrooms (one downstairs), 2 additional loos – as follows:

- **Main bedroom**, with built-in wardrobes, loo and basin / **2 further double bedrooms (upstairs)**, with fitted wardrobes / **1 double bedroom (downstairs)**, currently used as study, with fitted shelving
- **Large loft space**, with oak hatch and window
- **2 bathrooms**, 1 upstairs, 1 wet room downstairs, both with claw-foot baths
- **Kitchen**, with freestanding island, double Butler sink, Rayburn range, built-under Bosch oven and induction hob and integrated dishwasher – arch to: **Utility room**, with space for American-style fridge/freezer, washer and dryer (door to drive and stable door to garden) / Airing cupboard / **Cloakroom** / Attached **Workshop/store**, with work bench (wiring in place but no connected)
- **Garden Dining room**, with French doors to terrace
- **Sitting room**, with 2 inglenook fireplaces, 1 with woodburner and lined chimney / Built-in cupboard
- Oil-fired central heating (Rayburn boiler) to Underfloor heating downstairs, radiators upstairs / Range Tribune HE hot water system
- **Potential Annexe**, with power and water (oil pipe in place for installing heating) – electric garage door on front/2 stable doors – currently used as a dog grooming studio / Driveway parking for 6 cars
- **Gardens** (backing onto fields), including 'Secret Garden' with mulberry, loganberry, hybrid plum/apricot, cooking cherry & 2 Victoria Plum trees / Summerhouse and Greenhouse / Water butts

FURTHER FACTS & FIGURES

- Superfast fibre (BT) internet connectivity / Council tax band: G / EPC rating: tbc
- Bedford Railway Station: approx. 6 miles – fast trains to London: 39 minutes
- In Sharnbrook – 2 miles: Secondary Academy; surgery; Co-op; newsagent; Mill Theatre
- In Felmersham: Pinchmill Primary: 1500 yards / Sun Inn: 1 mile / Milton Ernest Garden Centre: 1.1 miles



At the touch of a button, a 5-bar wooden gate opens to a gravelled driveway for at least six cars. Aside the welcoming oak porch, pretty clematis, roses and wisteria climb the C18th stone toward a C21st slate roof which, like the extensions and the detached annexe, blends in effortlessly.

Inside, solid oak doors and skirtings complement beautiful old beams above your head. Huge limestone flags combine with red brick and terracotta beneath your feet. Wonderful inglenook fireplaces at each end of the sitting room, one with bread oven and woodburner, hint at your new home's former life as two cottages, one perhaps the hamlet's smithy, the photograph albums that come with the keys to Bridge Cottage showing a forge that was unearthed during renovation works a couple of decades ago.

How amazed the generations of families living here would be at the gorgeous family home that Bridge Cottage has become. A home with oodles of space, height and natural light, never for one moment letting you forget its heritage and immense character.

Simply lovely, Laura Ashley bathrooms, upstairs and down, one a wet room, serve beautiful bedrooms, with their expensive, bespoke wardrobes, sloping ceilings and low terracotta sills on which to sit and enjoy the 'secret garden', with its mulberry and other unusual fruit trees. The downstairs bedroom, with fireplace that could be used if you wish, provides an alternative for elderly parents if, for instance, you wish to earn an income from the annexe or, even, break the mould and use it as the garage that it once was.

Cook in a kitchen that has both a granite-topped island and high-end Corian working surfaces, not to mention a beautiful blue Rayburn and double Butler sink. Entertain in the hexagonal dining room with French doors to the peaceful, lavender-lined terrace and delightful cottage garden. Bees buzz amongst roses, hollyhocks and foxgloves, heady scents and birdsong fill the air in all seasons, and clematis 'Freckles' clammers amongst the apples, one of an amazing collection including Princess Diana and not one but two Princes – a garden fit for royalty, a home made for you.



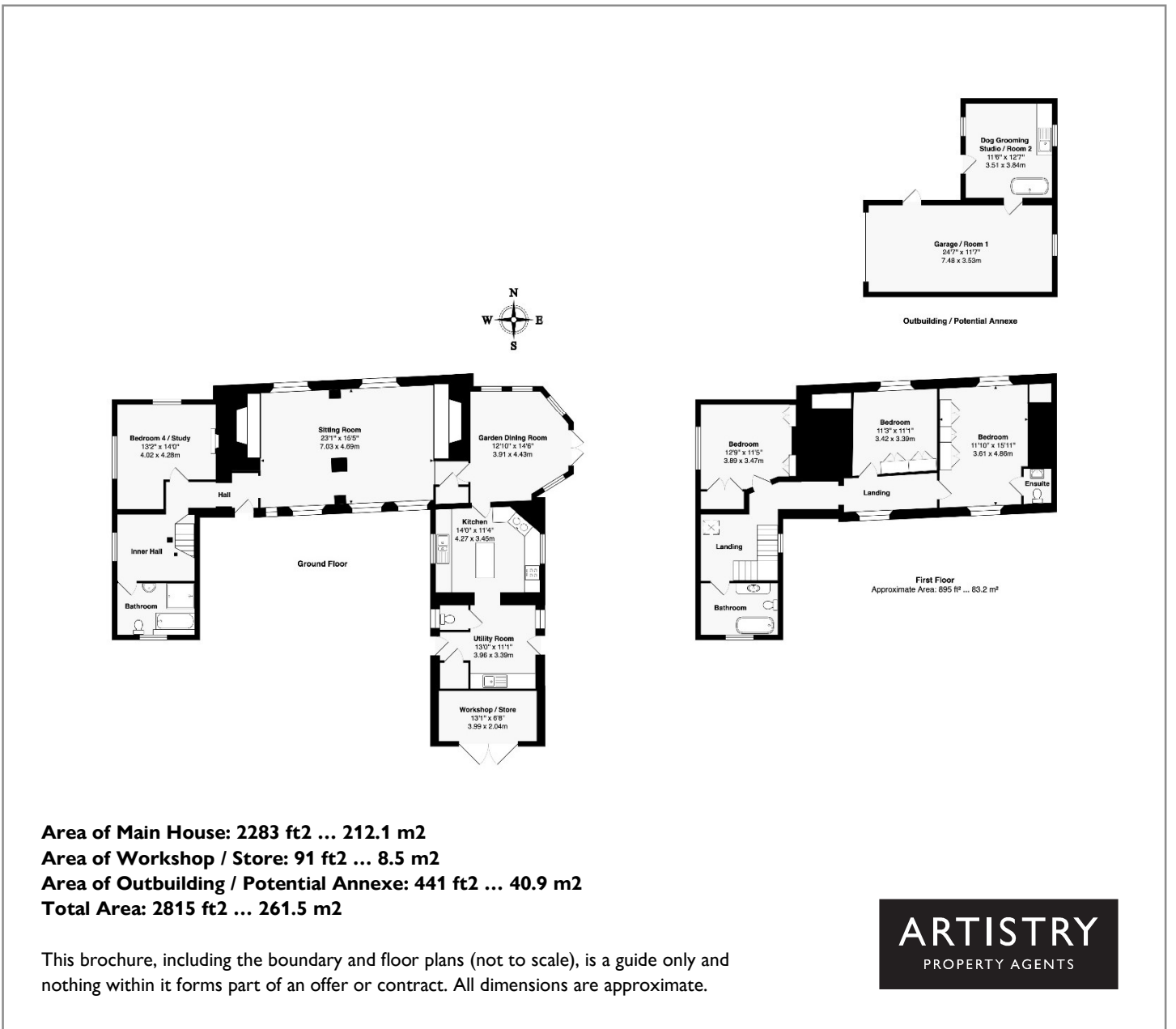

ARTISTRY
PROPERTY AGENTS



Bridge Cottage, Bridge End
Radwell, Bedfordshire MK43 7HU



Garage / Potential Annexe

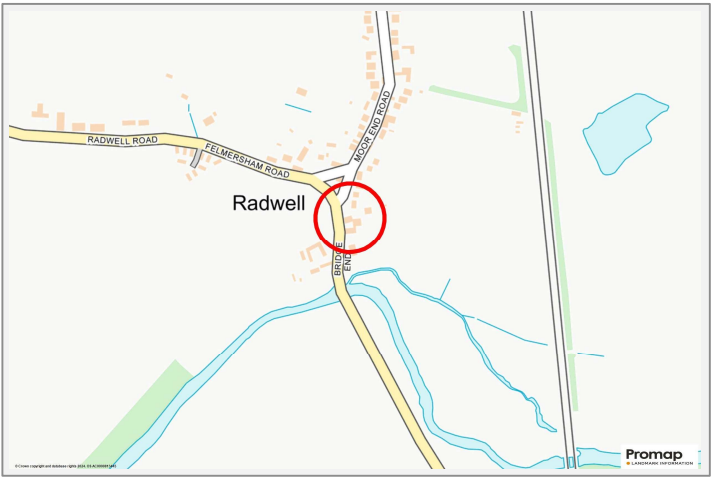

To discuss this unique home or one you wish to sell, please contact us.

Artistry Property Agents | 36 St Peter's Street | Bedford | MK40 2NN

T 01234 889987 | E info@artistryproperty.co.uk

www.artistryproperty.co.uk