



Fernwood Court, 434-436 Christchurch Road, Bournemouth BH1 4AY



Property Summary

A selection of stunning studio apartments from only £725..! The apartments are presented in first class order throughout and could be an ideal option if location and condition are important factors in your property search. If a short walk through Boscombe Chine Gardens for a swim in the sea, or a stroll along the cliff top for a bite to eat in Bournemouth before returning to a beautiful modern apartment sounds good to you – we've got the keys and are ready when you are...!



Key Features

- A choice of stunning studio apartments to let
- Modern studio room with storage
- Contemporary kitchen
- Modern shower room
- Walking distance to beach
- Great transport links
- Modern decor throughout
- Smart meters and good connectivity
- Energy efficient with high scoring 'C' rated EPC
- Photos and floorplan are representative of studio specifications



About the Property

We're really pleased to offer a selection of studio apartments in this professionally managed luxury development for our client, not only because all of the apartments are in superb condition, but they're also in a great location. The properties have lots to shout about such as modern shower rooms, contemporary kitchens and neutral decoration - but what we're really going to shout about is the location because the area allows you to live a very easy and lovely life..!

Beaches, beautiful gardens, shops and restaurants are all on your doorstep but when the weekends over and work rudely interrupts your life - at least you've got all the transport links to get you there quickly making that Monday commute just a little bit easier.

Council Tax Band: A



GROUND FLOOR

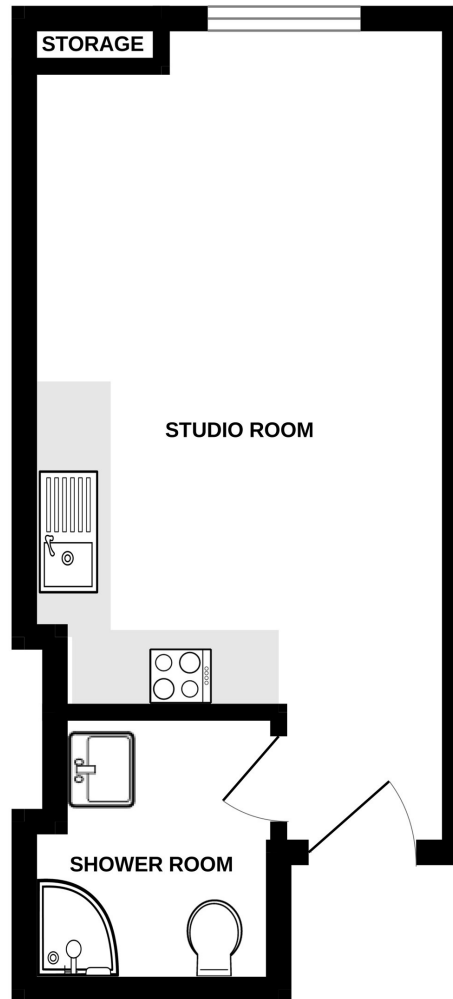

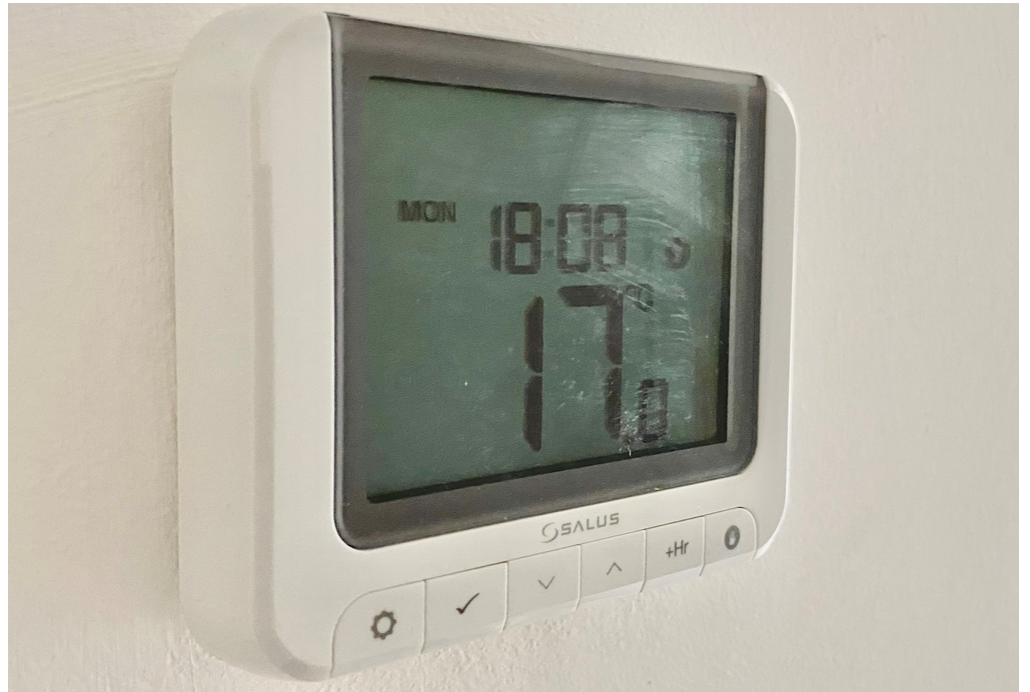

About the Location

Fernwood Court is conveniently located on Christchurch Road in Bournemouth. The area has many local shops, amenities and bars and restaurants. The property is also literally over the road from Boscombe Chine Gardens which are beautifully landscaped grounds that are open to the public. The gardens lead to the beach and also allow for access to the Overcliff for a quick stroll into Town. Public transport couldn't be better in the area with plentiful bus routes and road networks to surrounding areas and Bournemouth mainline rail station is only a 20 minute walk away (approximately).



About Mays

We understand that property is a people business, and pride ourselves on having a diverse and multi-talented team of property professionals.

We have been successfully selling and letting property for more than 30 years, and our wealth of local knowledge combined with our experience in both the London market and overseas property, means our team can handle anything that comes their way.

Our reputation is a result of the unsurpassed level of service we offer and importantly the results we achieve for our clients. Our ethos is to 'Bring People and Property Together', after all it's what we've been doing so well for so long.

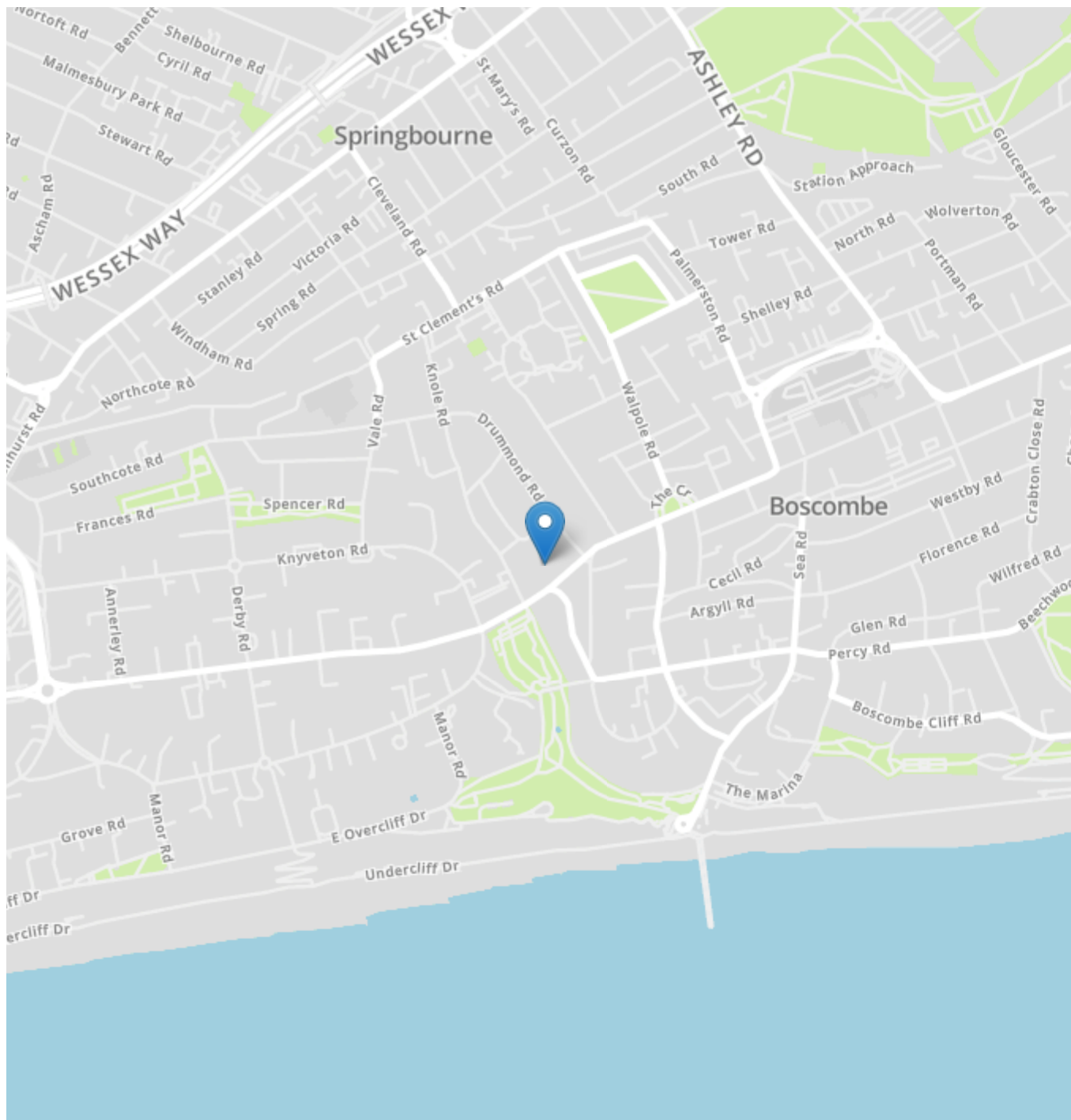

Energy Efficiency Rating		
	Current	Potential
Very energy efficient - lower running costs		
(92+) A		
(81-91) B		
(69-80) C	78	78
(55-68) D		
(39-54) E		
(21-38) F		
(1-20) G		
Not energy efficient - higher running costs		
England, Scotland & Wales		EU Directive 2002/91/EC

Mays Lettings

Mays Residential Lettings are members of ARLA Propertymark. Our Client Money Protection is supplied by Propertymark Client Money Protection Scheme. Mays are part of the Property Ombudsman Scheme TPO - DO3138

Mays Estate Agents - LETTINGS

290 Sandbanks Road, Lilliput, Dorset BH14 8HX

T: 01202 709888

E: lettings@maysestateagents.com

www.maysestateagents.com

MAYS
ESTATE AGENTS