



17 Dudley Place, Stanwell, Staines-upon-Thames, Surrey. TW19 7BG.
2 Bedroom Apartment - £265,000 Leasehold

17 Dudley Place, Stanwell, Staines-upon-Thames, Surrey. TW19 7BG.

01784 451458

2 Bedroom Apartment - £265,000 Leasehold

VERY WELL PRESENTED & SPACIOUS TWO BEDROOM, TWO BATH/SHOWER ROOM APARTMENT SITUATED IN THIS SOUGHT AFTER DEVELOPMENT IDEALLY LOCATED FOR EASY ACCESS TO LOCAL MOTORWAY NETWORKS & HEATHROW AIRPORT. The property benefits from a spacious lounge/diner, modern fitted kitchen, two double bedrooms (en-suite to Bed 1), further modern white bathroom suite, residents parking and a long lease. No Onward Chain. Viewings Highly Recommended!

Key Features

**WELL PRESENTED THROUGHOUT
LONG LEASE**

ALLOCATED PARKING

**TWO BEDROOM & TWO BATH/SHOWER ROOMS
WITHIN MOMENTS OF HEATHROW AIRPORT**

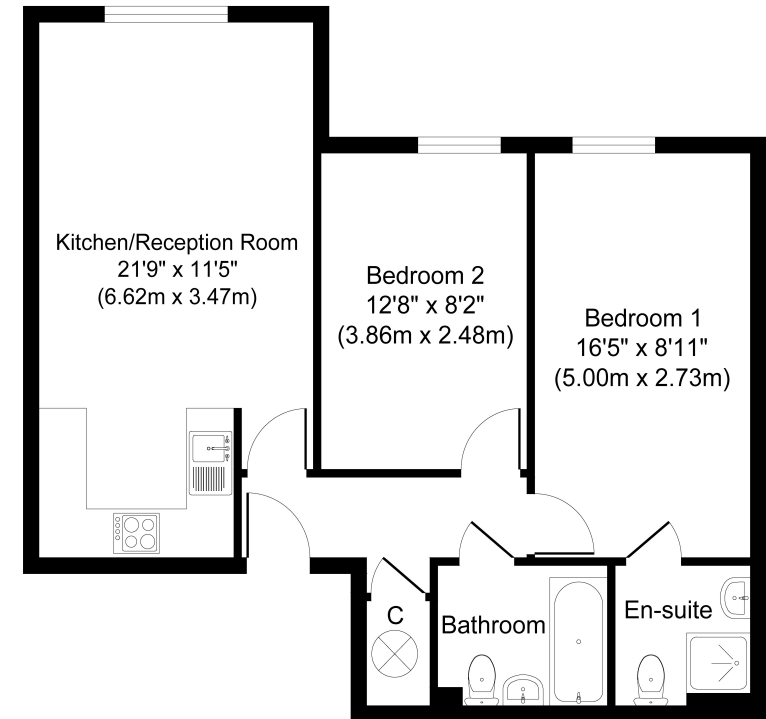

**Approximate Floor Area
640 sq. ft
(59.50 sq. m)**



GREGORY BROWN
RESIDENTIAL SALES & LETTINGS

Whilst every attempt has been made to ensure the accuracy of the floor plan contained here, measurements of doors, windows, rooms and any other items are approximate and no responsibility is taken for any error, omission, or mis-statement. The measurements should not be relied upon for valuation, transaction and/or funding purposes. This plan is for illustrative purposes only and should be used as such by any prospective purchaser or tenant. The services, systems and appliances shown have not been tested and no guarantee as to their operability or efficiency can be given.
Copyright V360 Ltd 2025 | www.houseviz.com



17 Dudley Place, Stanwell, Staines-upon-Thames, Surrey. TW19 7BG.

gregory-brown.co.uk

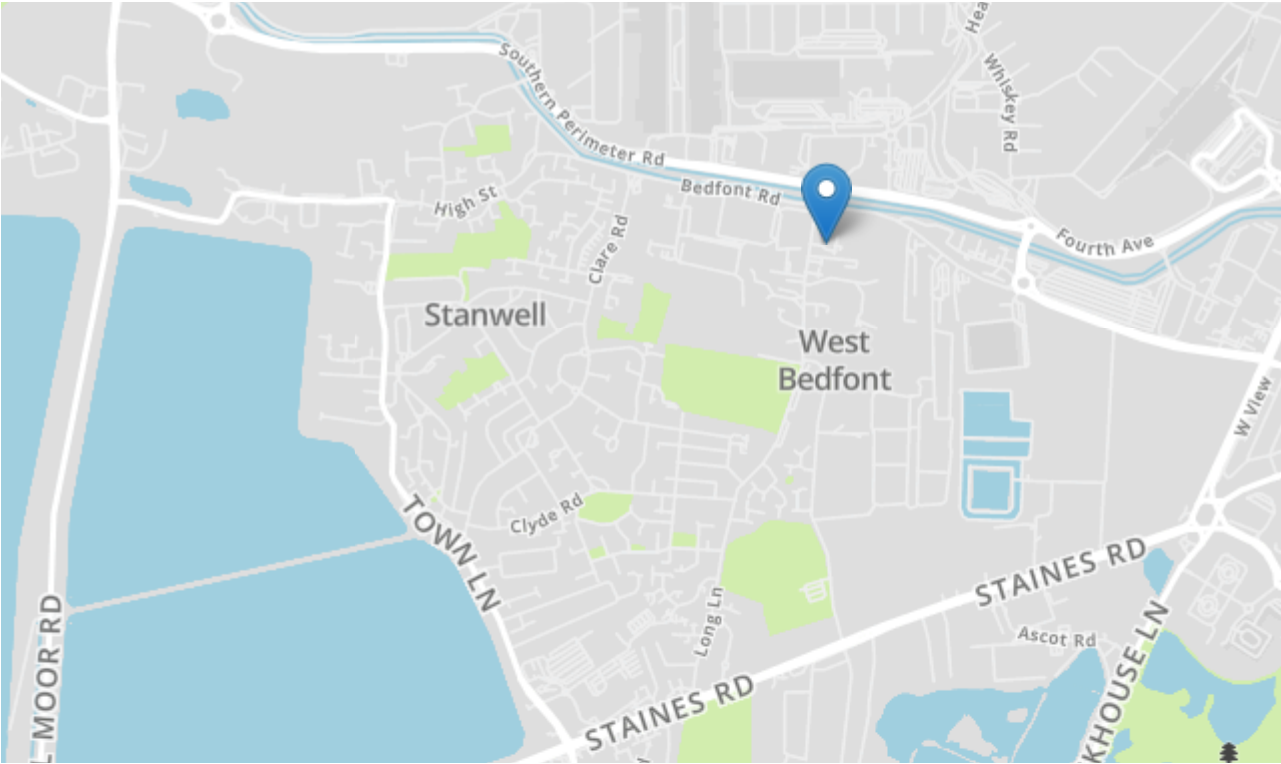

Tenure	Leasehold
Lease Term	To Be Confirmed
Ground Rent	To Be Confirmed
Service Charge	To Be Confirmed
Local Authority	
Council Tax	

We have prepared these property particulars as a general guide to a broad description of the property. They are not intended to constitute part of an offer or contract. We have not carried out a structural survey and the services, appliances and specific fittings have not been tested. All photographs, measurements, floorplans and distances referred to are given as a guide only and should not be relied upon for the purchase of carpets or any other fixtures or fittings. Lease details, service charges and ground rents (where applicable) and council tax are given as a guide only and should be checked and confirmed by your solicitor prior to exchange of contracts. The copyright of all details, photographs and floorplans remain exclusive to Gregory Brown.

