



- Two Bedrooms
- Lots Of Potential
- Family Bathroom
- Conservatory
- Private Rear Garden
- Living Room

**115 Shawbridge, Harlow, Essex. CM19 4NP.**

\*\*\*OPEN HOUSE SATURDAY 27TH JULY 15:00PM-16:00PM, CALL 01787 322799 TO ARRANGE YOUR APPOINTMENT\*\*\*

Positioned conveniently close to local shops and amenities, this two bedroom terraced house offers great potential for those looking to create their ideal home.





# Property Details.

## Room Measurements

### Entrance Hall



### Living Room



14' 7" x 12' 11" (4.45m x 3.94m)

### Kitchen/Diner



16' 9" x 9' 4" (5.11m x 2.84m)

### Conservatory



8' 8" x 7' 2" (2.64m x 2.18m)

## First Floor

### Bedroom One



12' 2" x 11' 1" (3.71m x 3.38m)

### Bedroom Two



12' 6" x 8' 2" (3.81m x 2.49m)

# Property Details.

## Bathroom



# Property Details.

## Floorplans

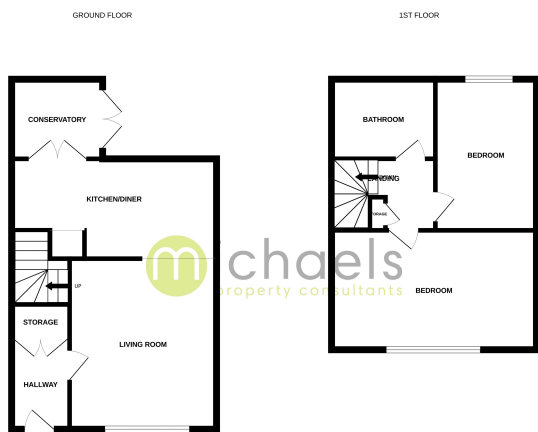

While every attempt has been made to ensure the accuracy of the floorplans contained here, measurements of spaces or areas shown on the plans are for general guidance only and are not intended to be relied upon for any specific purpose. The services, fixtures and fittings shown have not been tested and no guarantee is made with respect to them.

## Location

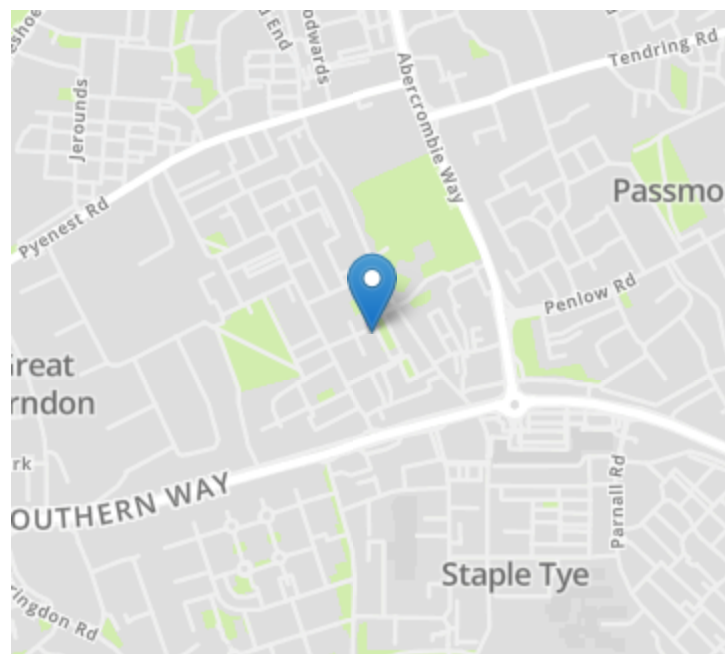

## Energy Ratings

We have not carried out a structural survey and the services, appliances and specific fittings have not been tested. All photographs, measurements, floor plans and distances referred to are given as a guide only and should not be relied upon for the purchase of carpets or any other fixtures or fittings. Gardens, roof terraces, balconies and communal gardens as well as tenure and lease details cannot have their accuracy guaranteed for intending purchasers. Lease details, service ground rent (where applicable) are given as a guide only and should be checked and confirmed by your solicitor prior to exchange of contracts.