



42 Mendip Grove, Gunthorpe, Peterborough. PE4 7TX

£185,000 Freehold

Be quick to avoid missing out! This three bedroom semi-detached home is located in Gunthorpe and is close to local shops, schools and bus routes. Offered for sale with no forward chain, an early viewing is a must. Briefly comprises; entrance hall, lounge/diner, kitchen, utility, cloakroom, three bedrooms and bathroom. Outside there is a good size enclosed rear garden. There is an allocated parking space.



FLOORPLAN, FEATURES & EPC

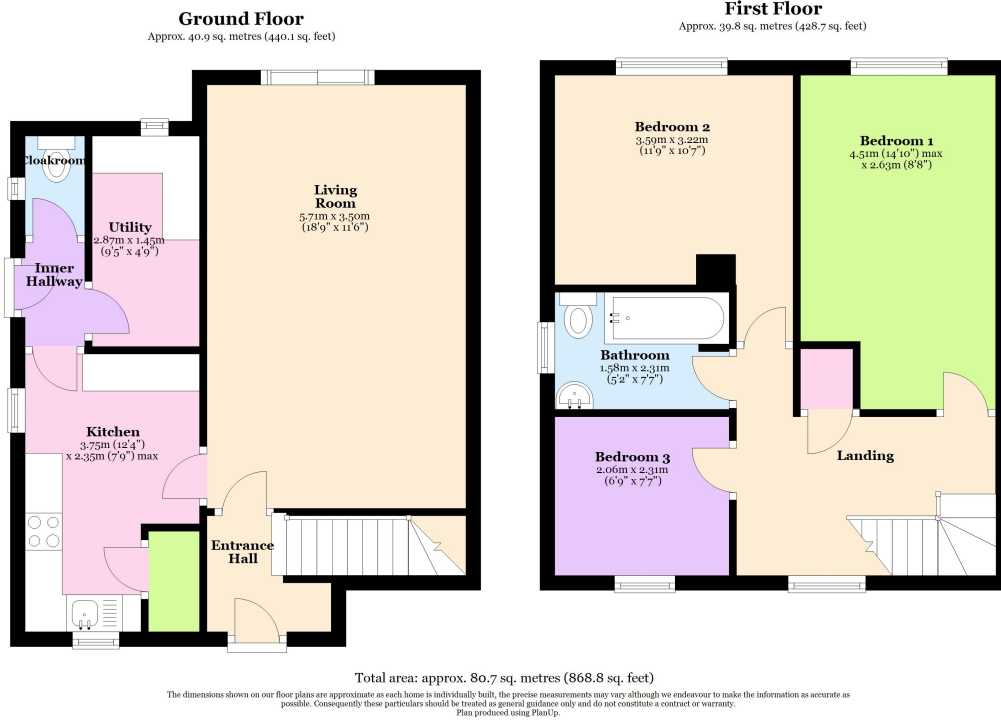

- NO FORWARD CHAIN
- REFITTED KITCHEN
- UTILITY ROOM
- CLOAKROOM
- REFITTED BATHROOM

- uPVC DOUBLE GLAZING
- GAS CENTRAL HEATING
- GOOD SIZE REAR GARDEN
- CLOSE TO SCHOOLS & SHOPS
- PERFECT FIRST TIME BUY

