



- Three Bedroom House
- Garage & Off Road Parking For 3 Vehicles
- Sought After Village Of Black Notley
- Ground Floor Cloakroom
- Contemporary Open-Plan Living Accommodation
- En Suite To Master Bedroom
- Refitted Kitchen & Bathroom
- No Onward Chain
- Larger Than Usual Plot
- Easy Access To Crossing Train Station

1 Constable Way, Black Notley, Braintree, Essex. CM77 8FE.

Michaels Property Consultants are delighted to bring to the market this beautifully presented and somewhat unique three bedroom end terraced house, occupying a fabulous position within the sought after and frequently requested village of Black Notley. Overlooking a well maintained greensward, this stylish family home is new to the market and also offered for sale with no onward chain, lending itself perfectly to any buyer seeking a low maintenance and hassle free purchase.



Property Details.

Ground Floor

Entrance Hall



Cloakroom

Living Room/Diner



19' 1" MAX x 16' 9" MAX (5.82m x 5.11m)

Kitchen



10' 8" x 8' 5" (3.25m x 2.57m)

First Floor

Bedroom One



15' 3" MAX x 10' 6" (4.65m x 3.20m)

En-Suite Shower Room

Property Details.

Bedroom Two



11' 0" MAX x 9' 5" (3.35m x 2.87m)

Bedroom Three

10' 9" x 6' 1" (3.28m x 1.85m)

Family Bathroom



Outside

Rear Garden



Garage With Parking Space In-Front

Additional Parking For Two Vehicles At The Front Of The Dwelling

Property Details.

Floorplans

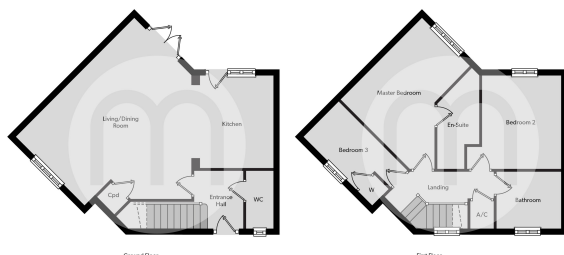

Location

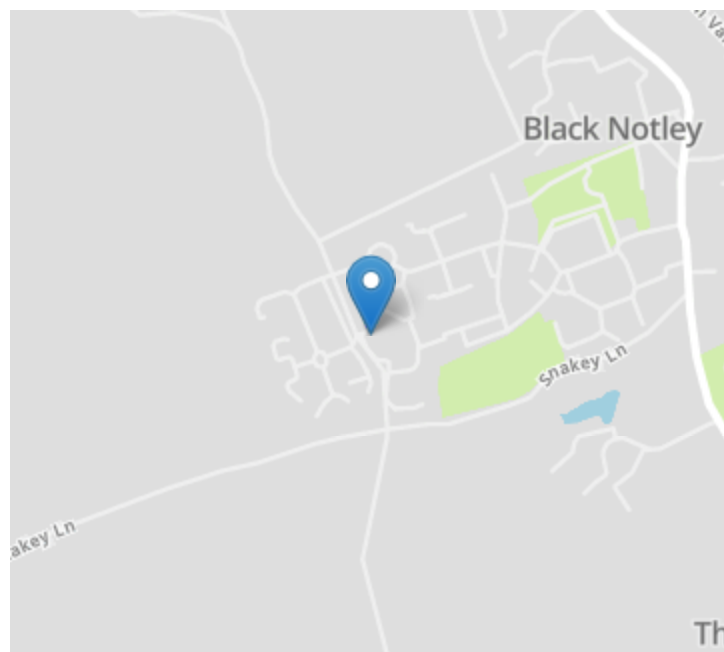

Energy Ratings

We have not carried out a structural survey and the services, appliances and specific fittings have not been tested. All photographs, measurements, floor plans and distances referred to are given as a guide only and should not be relied upon for the purchase of carpets or any other fixtures or fittings. Gardens, roof terraces, balconies and communal gardens as well as tenure and lease details cannot have their accuracy guaranteed for intending purchasers. Lease details, service ground rent (where applicable) are given as a guide only and should be checked and confirmed by your solicitor prior to exchange of contracts.