



## Highview Gardens, Potters Bar, Hertfordshire, EN6

**£1,800 pcm**

- **Three Bed Semi-Detached Home**
- **Moments from Potters Bar High Street**
- **£1,800pcm**
- **Quiet Cul De Sac**
- **Available 19th November 2021**

# Highview Gardens, Potters Bar, Hertfordshire, . EN6

## £1,800 pcm Freehold

This well presented furnished three bedroom semi detached home is ideally situated on this quiet residential cul de sac moments from Potters Bar High Street, local shops and amenities and Oakmere Park.

This home features include two reception rooms, fitted kitchen, utility room, double glazing, gas central heating and off street parking for two cars.

£1,800pcm - internal viewing recommended.

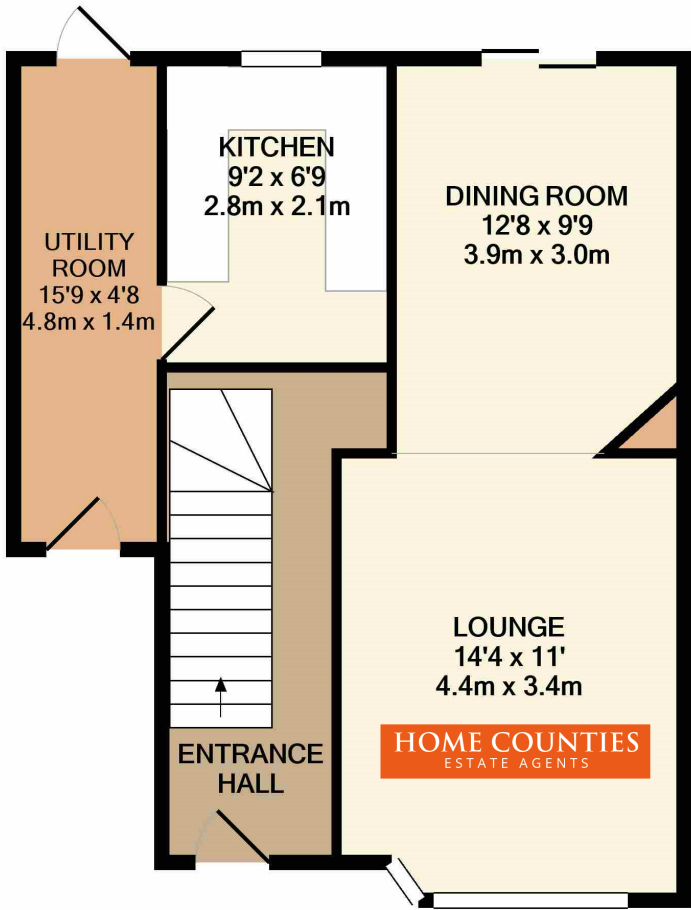

GROUND FLOOR  
APPROX. FLOOR  
AREA 518 SQ.FT.  
(48.1 SQ.M.)

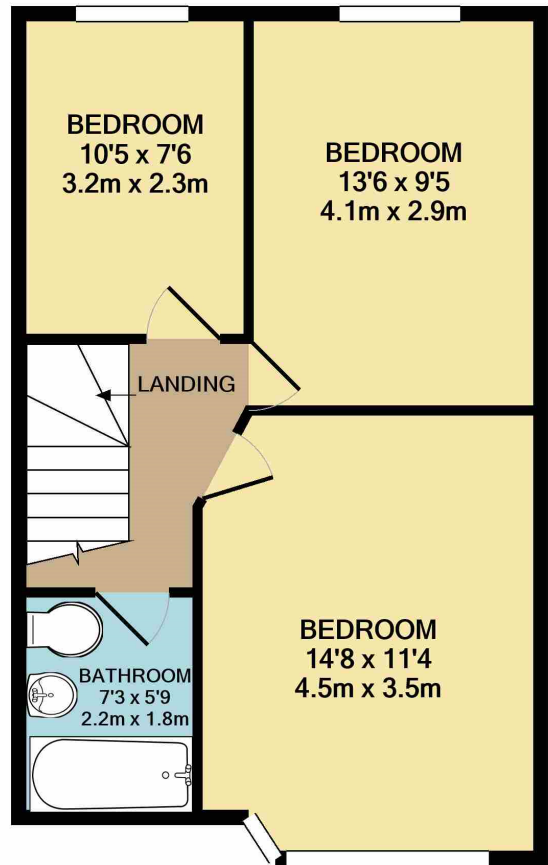

1ST FLOOR  
APPROX. FLOOR  
AREA 444 SQ.FT.  
(41.3 SQ.M.)

TOTAL APPROX. FLOOR AREA 962 SQ.FT. (89.4 SQ.M.)

Whilst every attempt has been made to ensure the accuracy of the floor plan contained here, measurements of doors, windows, rooms and any other items are approximate and no responsibility is taken for any error, omission, or mis-statement. This plan is for illustrative purposes only. The services, systems and appliances are to their operability or otherwise. Made with M...

