

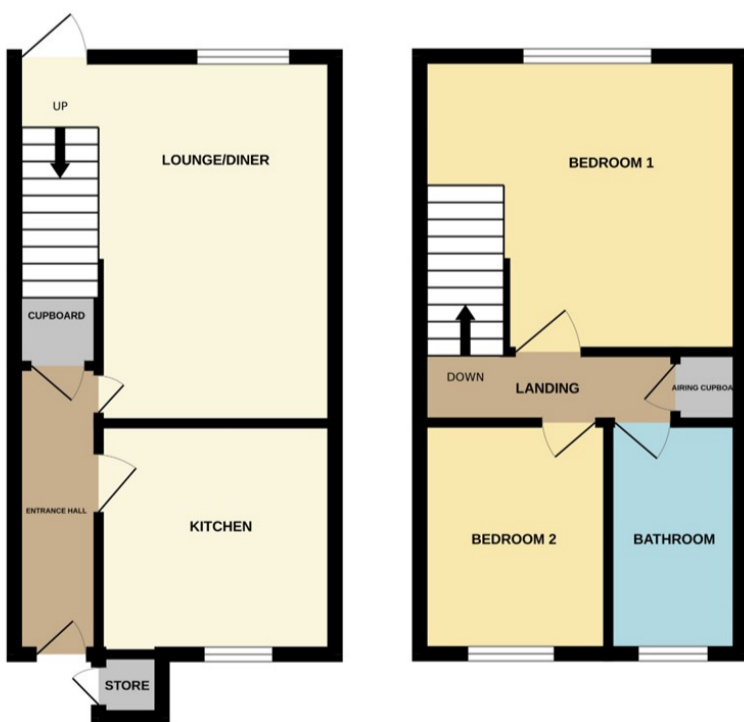

Bourne

£159,000



*** MODERN END OF TERRACE PROPERTY CLOSE TO TOWN *** Situated within striking distance of Bourne town centre, this lovely end terraced house would be an ideal first time buy or investment opportunity for buy-to-let. In good condition and neutral décor throughout, accommodation offers a bright lounge and refitted kitchen to the ground floor. Upstairs to the first floor are two bedrooms and a refitted bathroom. Outside there is gated side access to an enclosed rear garden which is mainly laid to lawn with paved patio and gravelled border, established shrubbery and a shed. Off road parking is in the communal carpark further into the cul-de-sac. EPC energy rating - C / Council Tax band - A