

Corfe Gardens is a highly sought after residential area that is popular with families of all ages. This ideal family home is located only 200 yards from the OUTSTANDING The Westgate School and Burnham train station (Elizabeth Line) is only 0.8 miles away.

This property has been extended to the side and as a result provides ample room for the entire family to grow. This home internally comprises of a separate lounge & dining room, however these rooms have the possibility of opening up into a larger open plan reception area. The extension to the side makes a huge difference and is now home to bedroom four or a home office/study. A full downstairs shower room and a modern kitchen complete the ground floor. The remaining three bedrooms and the second bathroom are located on the first floor. The property has been maintained up to a high standard and is ready for the next family to move straight in.

To the rear there is a private garden perfect for enjoying those summer evenings and a garage is included and located in the block next the the property.

This home is SOLD WITH NO ONWARD CHAIN and is ready to move at your desired pace.





Property Information

-  FREEHOLD
-  FOUR BEDROOMS
-  GARAGE
-  0.2 MILES TO THE WESTGATE SCHOOL
-  EXTENDED
-  TWO BATHROOMS
-  0.8 MILES TO BURNHAM STATION (ELIZABETH LINE)
-  NO ONWARD CHAIN

  
**x4**  
Bedrooms

  
**x2**  
Reception Rooms

  
**x2**  
Bathrooms

  
**0**  
Parking Spaces

  
**Y**  
Garden

  
**Y**  
Garage

**Transport Links**  
NEAREST STATIONS:  
Burnham (0.8 miles)  
Slough (1.8 miles)  
Taplow (2.2 Miles)

The M4 (jct 6) is only a short distance away, M40 is also easily accessible these both in turn provide access to the M25, M3 and Heathrow Airport. The Elizabeth Line runs from Burnham & Slough stations and provide links into Central London. A direct line to London Waterloo is available from Windsor & Eton Riverside station.

Floor Plan

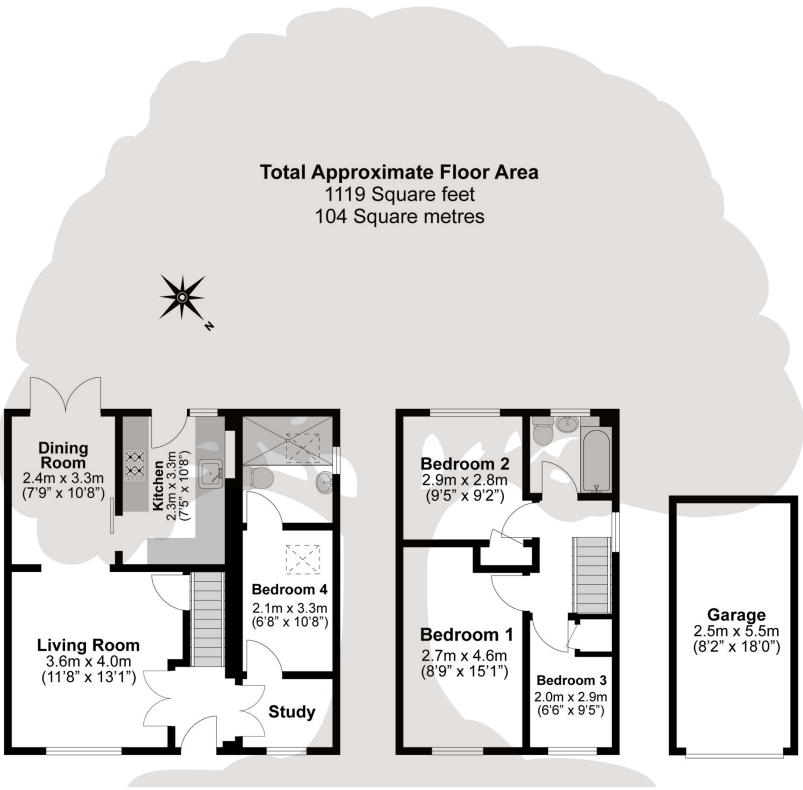

Illustrations are for identification purposes only, measurements are approximate, not to scale.

Prospective purchasers should be aware that these sales particulars are intended as a general guide only and room sizes should not be relied upon for carpets or furnishing. We have not carried out any form of survey nor have we tested any appliance or services, mechanical or electrical. All maps are supplied by Goview.co.uk from Ordnance Survey mapping. Care has been taken in the preparation of these sales particulars, which are thought to be materially correct, although their accuracy is not guaranteed and they do not form part of any contract.

