



STABLE COTTAGE, HIGH STREET, MARKET DEEPING PE6 8ED

£770,000

FREEHOLD



briggs
 residential

17 Market Place
 Market Deeping
 PE6 8EA

**01778
 349300**

Follow us on



Stable Cottage is tucked away in the heart of Market Deeping town centre behind double opening electric gates. This historic detached period home has a wealth of character throughout and an exceptionally large fully enclosed private garden to the rear. With many period features and various exposed stone walls and beams, this home is entered via a 14' square hallway, has four reception rooms and four bedrooms to the first floor. With a 32' kitchen/family room, this truly unique property has a magnificent lounge with exposed stone walls and woodburning stove. The property also has a large landing with reception area and ample parking that leads to a detached double garage. Viewing of this home is highly advised to appreciate its superb location within Market Deeping.

Entrance door opening to

HALLWAY 14'5 x 14' (4.39m x 4.27m)
A most impressive entrance to this home with exposed stone walls and beams, exposed flooring, intercom system, radiator, window to front elevation and staircase leading to first floor.

LOUNGE 14'8 x 14' (4.47m x 4.27m)
A truly stunning room with exposed stone walls, stone fireplace with cast-iron burner, exposed beams, radiator, two windows to front elevation and further window to side elevation.

BOOT ROOM/CLOAKS AREA 11'7 x 6'9 (3.53m x 2.06m)
With door to rear garden and door to

CLOAKROOM
Comprising low flush WC, wash-hand basin and window to front elevation.

STUDY AREA 13'2 x 12'6 (4.01m x 3.81m)
With exposed stone wall and beams, radiator, window to side elevation and door to side garden.

KITCHEN/FAMILY ROOM 32' x 12' (9.75m x 3.66m)
This spacious, quality kitchen, which is the heart of the property, has a range of ample wall and base units with built-in appliances, dining area, relaxing family area, windows to front and side elevations, French doors opening onto rear garden and door to

LANDING 15'10 x 14'5 (4.83m x 4.39m)
A most impressive landing with two windows to front elevation, window to side elevation, exposed beams, radiators and built-in airing cupboard.

BEDROOM ONE 19'10 x 12' (6.05m x 3.66m)
With built-in wardrobes, access to eaves storage, radiator, two windows to front elevation and window to side elevation.

BEDROOM TWO 15' x 8'4 (4.57m x 2.54m)
With radiator and windows to rear and side elevations.

BEDROOM THREE 14'6 x 10'3 (4.42m x 3.12m)
With windows to front and side elevations.

BEDROOM FOUR 12' x 9' (3.66m x 2.74m)
With radiator and windows to rear and side elevations.

BATHROOM
Comprising panelled bath with shower screen and rainfall shower above, wash-hand basin, low flush WC, heated towel rail, fully tiled walls, tiled flooring and window to front elevation.

CONSERVATORY 12'6 x 10'2 (3.81m x 3.10m)
Overlooking the gardens and westerly-facing courtyard, with French doors opening to the side.

UTILITY ROOM 10'3 x 5' (3.12m x 1.52m)
With plumbing for washing machine, space for tumble dryer, window to rear elevation and door to rear garden.

STORE ROOM/PANTRY
With plumbing for American style fridge/freezer and window to rear elevation.

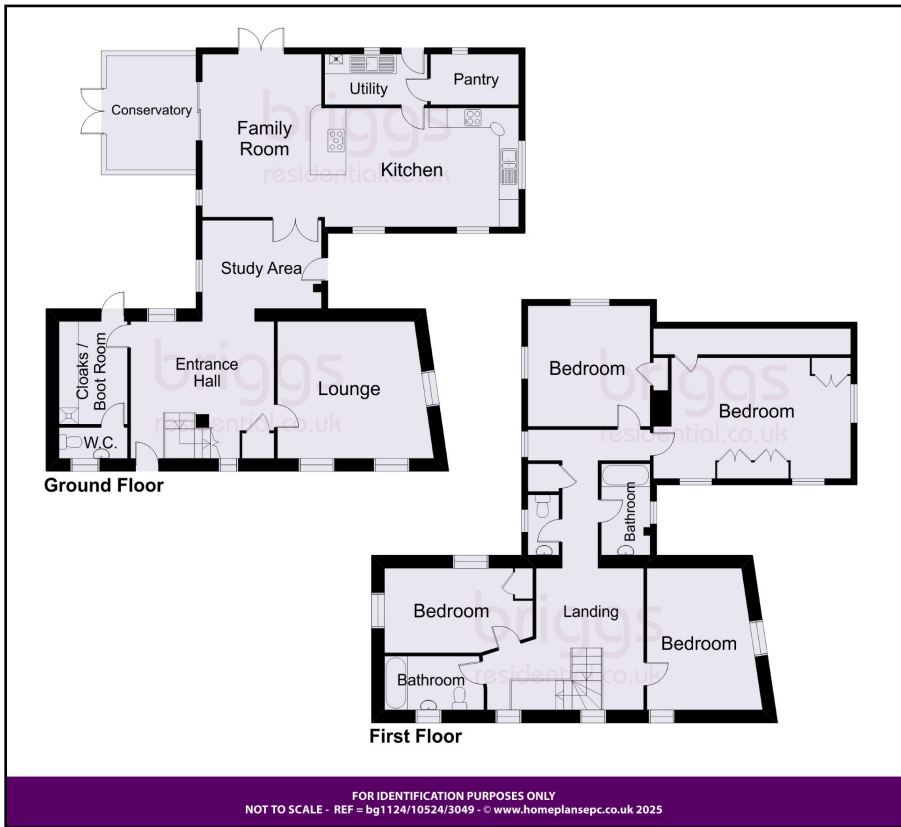

SHOWER ROOM
Comprising compact panelled bath with shower screen and rainfall shower above, wash-hand basin with cupboards below, heated towel rail and window to side elevation.

CLOAKROOM
Comprising low flush WC, wash-hand basin and window to side elevation.

OUTSIDE
The property is approached via double opening electric gates and has a gravel driveway leading to a detached double garage with power, lighting and solar panels.

The rear gardens, which are a superb feature of this home, provide a high degree of privacy being enclosed by fencing and mature conifers and are mainly laid to lawn with patio area, paving, gravelled areas and various mature shrubs.

EPC RATING: TBC COUNCIL TAX BAND: F (SKDC)

These particulars do not constitute part or all of an offer or contract. The measurements and details are supplied for guidance only and as such must be considered incorrect. Potential buyers are advised to recheck the measurements before committing to any expense. Briggs Residential have not tested any apparatus, equipment, services, fixtures or fittings and it is in the buyers interest to check the working condition of appliances. Briggs Residential have not sought to verify the legal title or structure of the property and suggest buyers obtain such verification from their solicitors.