



24, Heyford Way

Hatfield,
Hertfordshire, AL10 0AT
£450,000

country
properties

Discover your dream home in Hatfield. This inviting three-bedroom terraced house combines modern touches with unbeatable location benefits. Step into a stylish kitchen/diner with sleek cabinetry and ample countertop space. The bright and spacious lounge is flooded with natural light, creating a welcoming atmosphere for relaxation or socialising. Upstairs, you will find two double bedrooms and one single bedroom with ample storage options. The modern bathroom features quality fittings and a contemporary design. Outside, enjoy a picturesque, enclosed garden. Complete with convenient parking and located near the historic charm of Old Hatfield, Hatfield station, and scenic Hatfield Park, this home offers a seamless blend of comfort, style, and connectivity.

- Modern Terrace Home
- Modern Kitchen/ Diner
- Large Lounge
- Two Double Bedrooms and One Single Bedroom
- Allocated Parking
- Minutes From Hatfield Train Station
- Near Old Hatfield and Hatfield Park





Approximate Gross Internal Area 793 sq ft - 74 sq m

Ground Floor Area 410 sq ft – 38 sq m

First Floor Area 383 sq ft – 36 sq m

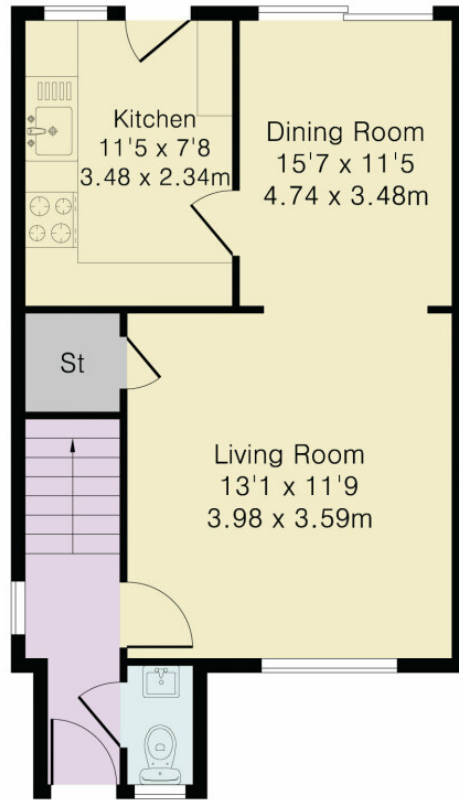

Ground Floor

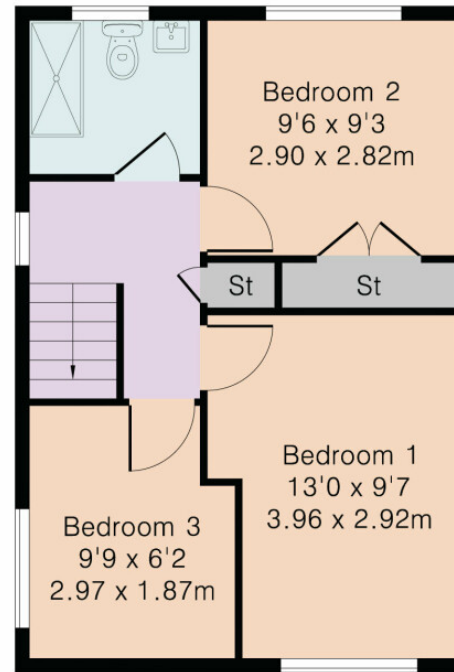

First Floor

All measurements are approximate and quoted in metric with imperial equivalents and for general guidance only and whilst every attempt has been made to ensure accuracy, they must not be relied on. The fixtures, fittings and appliances referred to have not been tested and therefore no guarantee can be given and that they are in working order. Internal photographs are reproduced for general information and it must not be inferred that any item shown is included with the property. For a free valuation, contact the numbers listed on the brochure.

Viewing by appointment only

Country Properties | 7, The Broadway | AL9 5BG

T: [01707 271450](tel:01707271450) | E: hatfield@country-properties.co.uk

www.country-properties.co.uk

country
properties