



NEWSON & BUCK  
ESTATE AGENTS



## 18 Low Road, Congham, King's Lynn, Norfolk PE32 1AE    £325,000

No Onward Chain!!! Newson & Buck are proud to offer to the market this well presented two bedroom Detached Bungalow situated in the desirable village of Congham. With fantastic potential and field views to the rear this property is a must see! The property comprises of an entrance hallway, lounge, kitchen, conservatory, two bedrooms and a family bathroom. Further more there is off road parking for numerous vehicles and a garage. To the rear of the property you will find an enclosed rear garden area with potential to extend (STPP) combined with field views of the Norfolk Countryside. Viewing for this property is essential so please call our office today to book your appointment.

**Entrance Hallway**

Fitted carpet, one radiator, two cupboards.

**Lounge**

14' 05" x 12' 02" (4.39m x 3.71m) Fitted carpet, one double glazed window, one radiator.

**Kitchen**

16' 01" x 9' 02" (4.90m x 2.79m) Tiled flooring, one double glazed window, double glazed patio doors leading to conservatory, fitted kitchen units, stainless steel sink, electric oven, induction hob, space for washing machine and dishwasher.

**Bedroom One**

12' 0" x 12' 09" (3.66m x 3.89m) Fitted carpet, one double glazed window, one radiator, fitted wardrobes.

**Bedroom Two**

9' 09" x 10' 11" (2.97m x 3.33m) Fitted carpet, one double glazed window, one radiator, fitted wardrobes.

**Bathroom**

5' 05" x 6' 05" (1.65m x 1.96m) Vinyl flooring, shower cubical, low flush w/c, pedestal sink, one double glazed window, one radiator.

**Conservatory**

16' 06" x 11' 02" (5.03m x 3.40m) Fitted carpet, one radiator.

**Rear Garden**

Enclosed rear garden with patio area and lawn.

**EPC - TBC**

**Council Tax Band - C**



GROUND FLOOR

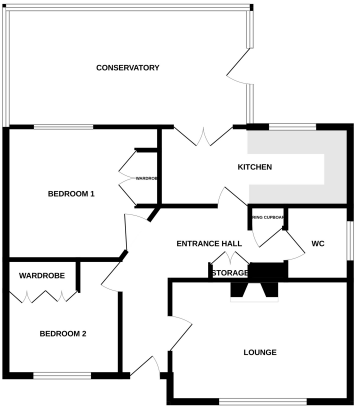

While every attempt has been made to ensure the accuracy of the floorplan, the floorplan is not intended to be a legal document. It is intended to provide a general impression of the property and is not intended to be used as a legal document. The floorplan is not intended to be used as a legal document. The floorplan is not intended to be used as a legal document.