

2 Glentrammon Close, Orpington, Kent, BR6 6DL

**Property Images**











## Ground Floor

Approx. 116.7 sq. metres (1255.7 sq. feet)

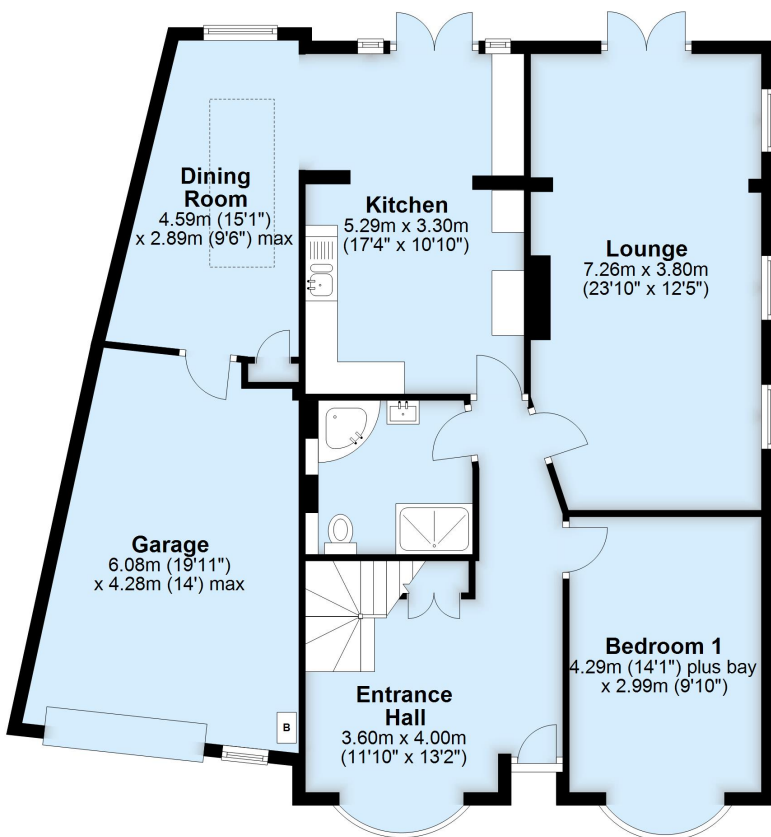

## First Floor

Approx. 48.5 sq. metres (522.3 sq. feet)

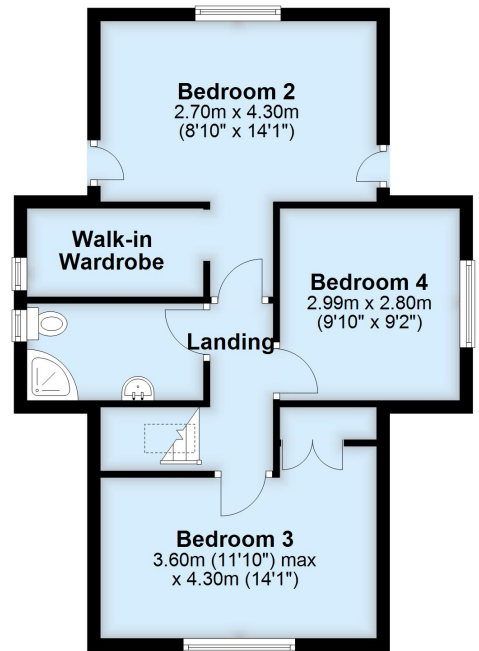

Total area: approx. 165.2 sq. metres (1777.9 sq. feet)

This plan is for general layout guidance and may not be to scale.  
Plan produced using PlanUp.