

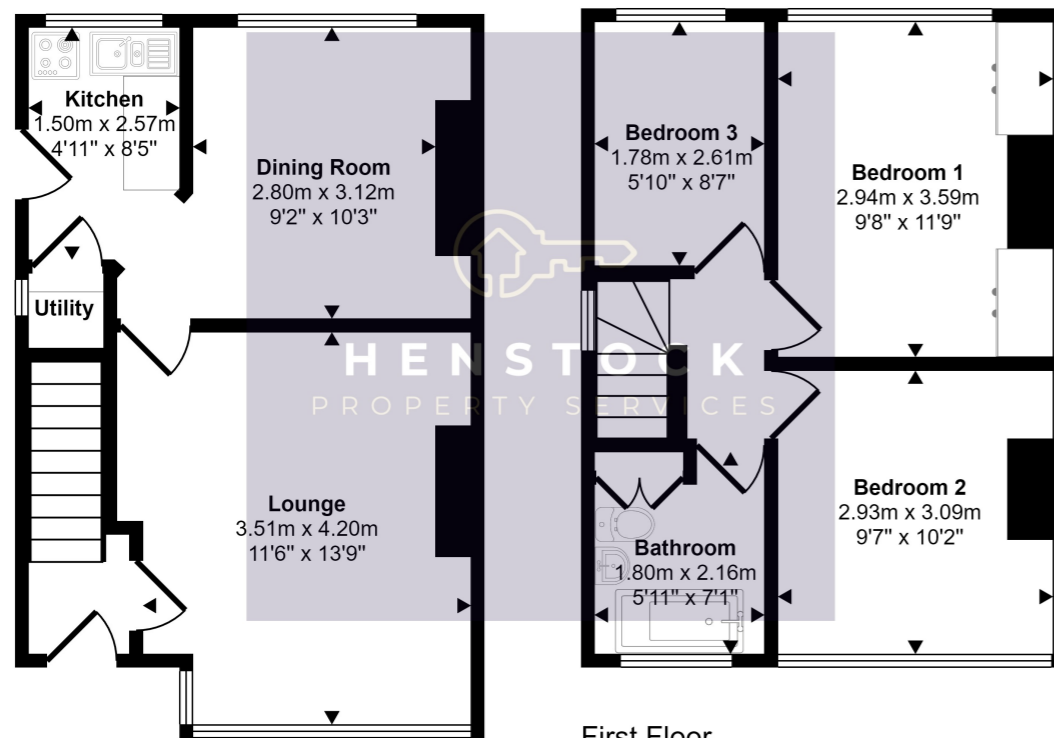

HENSTOCK
PROPERTY SERVICES



Approx Gross Internal Area
67 sq m / 726 sq ft



First Floor
Approx 33 sq m / 357 sq ft

Ground Floor
Approx 34 sq m / 369 sq ft

This floorplan is only for illustrative purposes and is not to scale. Measurements of rooms, doors, windows, and any items are approximate and no responsibility is taken for any error, omission or mis-statement. Icons of items such as bathroom suites are representations only and may not look like the real items. Made with Made Snappy 360.

19 Hildale Avenue, Blackley, Manchester, Lancashire M9 6PQ

- 3 BEDROOMED END QUASI SEMI-DETACHED
- FREEHOLD
- NO CHAIN
- REAR GARDEN
- 2 RECEPTION ROOMS
- GAS CENTRAL HEATING

£160,000



PROPERTY DESCRIPTION

Henstock Property Services are pleased to market this 3 bedroomed end quasi semi detached family home. The living accommodation briefly comprises; entrance hallway, lounge, dining room, fitted kitchen, 3 upper floor bedrooms and a bathroom. The property also has the benefit of gas central heating, double glazed windows and a lawned rear garden. Ideally situated in this popular spot within easy reach of schools, shops/supermarkets, leisure/fitness facilities, good public transport services and a short distance from the M60 & M62 motorway links.

GROUND FLOOR

Entrance

Hallway

Front Lounge

3.51m x 4.2m (11' 6" x 13' 9") views to front, wall mounted gas fire, double radiator.

Rear Lounge

2.8m x 3.12m (9' 2" x 10' 3") views to rear, central fireplace with wall mounted gas fire, tiled back panel and hearth, double radiator.

Kitchen

1.5m x 2.57m (4' 11" x 8' 5") views to rear, white worktops, white and brown units, stainless steel sink with chrome taps, part tiled walls, plumbed for freestanding gas cooker, under stair storage.

FIRST FLOOR

Bedroom 1

2.94m x 3.59m (9' 8" x 11' 9") views to rear, fully fitted wardrobes, single radiator.

Bedroom 2

2.93m x 3.09m (9' 7" x 10' 2") views to front, single radiator.

Bedroom 3

1.78m x 2.61m (5' 10" x 8' 7") views to rear, single radiator.

Bathroom

1.8m x 2.16m (5' 11" x 7' 1") coloured suite comprising; bath, sink, close coupled w.c, built in storage, single radiator.

Exterior

Front garden area with central steps, side lawns, side path to rear.

Rear garden - paved area with steps up to central paved path with lawn and shrubberies.

