



Flat 4, 29 Park Road, Bexhill-on-Sea, East  
Sussex, TN39 3HX

£204,950



- Spacious Split Level Apartment
- Two Good Size Double Bedrooms
- Spacious Lounge-Diner
- 2nd Bedroom with Balcony
- Modern Kitchen & Bathroom
- Situated Adjacent To The Seafront
- Close To The Lovely Egerton Park
- Walking Distance To Bexhill Station
- Sold With A Long Lease
- Belongs To A Well Manged Building
- Sold With No Onward Chain
- Sought After & Convenient Location
- Viewing Highly Recommended



**FIRST FLOOR**  
**660 sq.ft. (61.4 sq.m.) approx.**

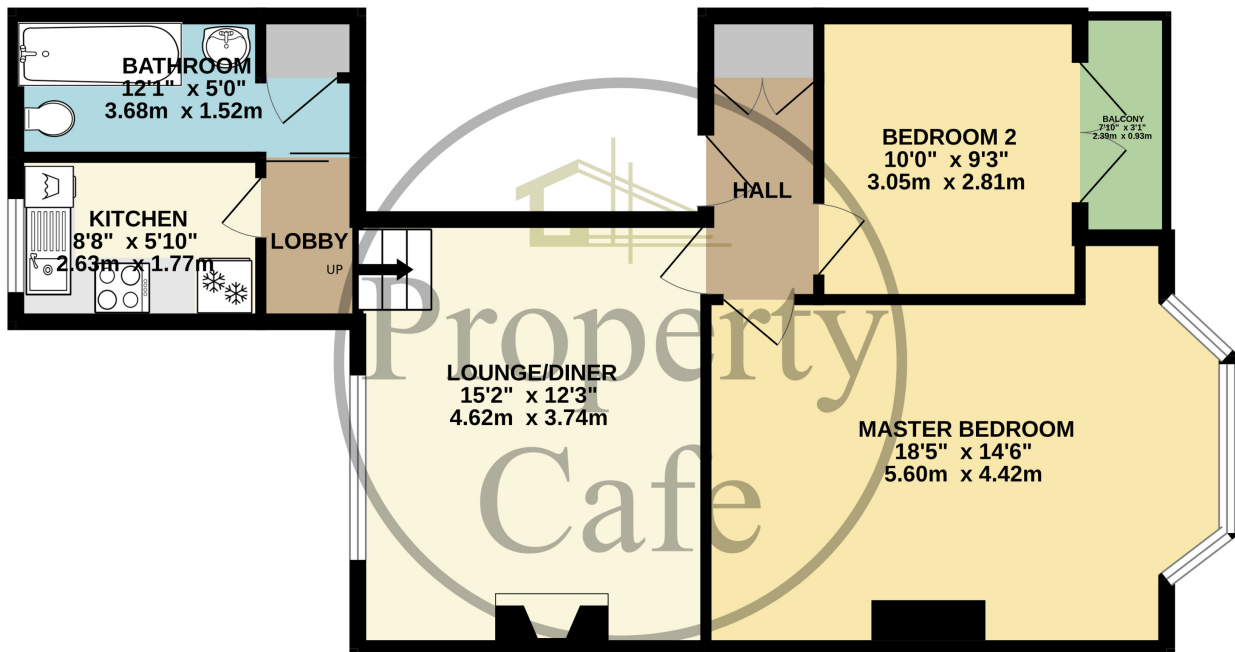

**TOTAL FLOOR AREA : 660 sq.ft. (61.4 sq.m.) approx.**

Whilst every attempt has been made to ensure the accuracy of the floorplan contained here, measurements of doors, windows, rooms and any other items are approximate and no responsibility is taken for any error, omission or mis-statement. This plan is for illustrative purposes only and should be used as such by any prospective purchaser. The services, systems and appliances shown have not been tested and no guarantee as to their operability or efficiency can be given.

Made with Metropix ©2024

