

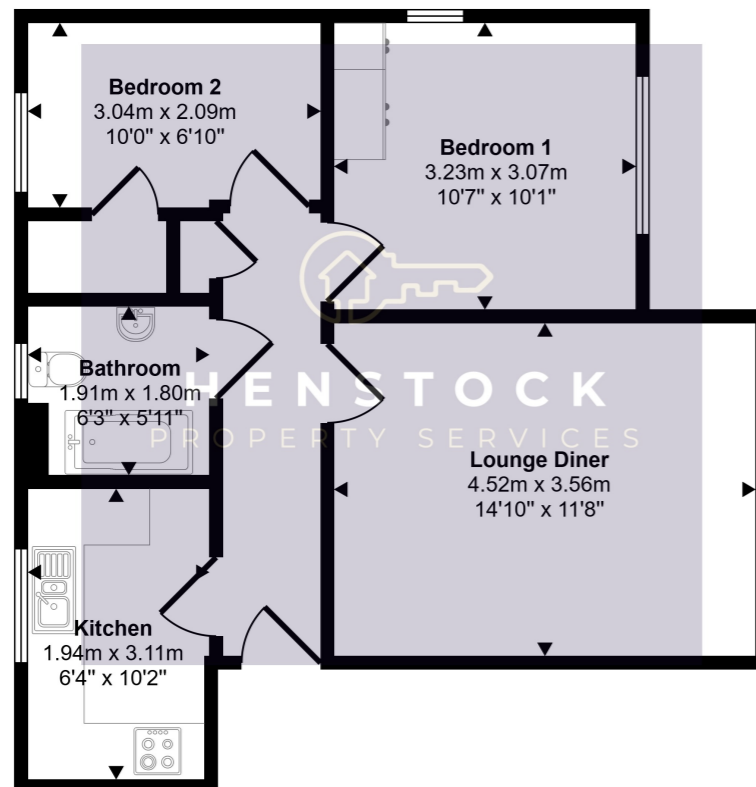

HENSTOCK
PROPERTY SERVICES



Approx Gross Internal Area
51 sq m / 552 sq ft



Floorplan

This floorplan is only for illustrative purposes and is not to scale. Measurements of rooms, doors, windows, and any items are approximate and no responsibility is taken for any error, omission or mis-statement. Icons of items such as bathroom suites are representations only and may not look like the real items. Made with Made Snappy 360.

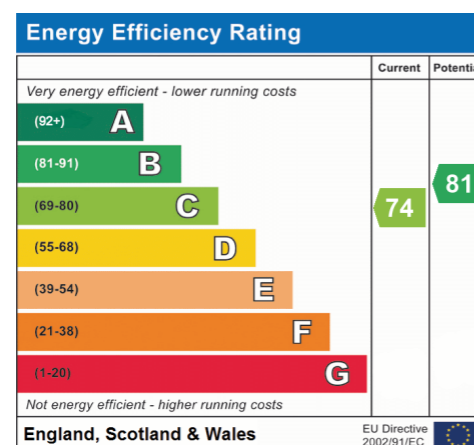

50 Whitecroft Meadow, Middleton, Manchester, Lancashire M24 1LU

- 2 BEDROOMED APARTMENT
- WELL PRESENTED
- DOUBLE GLAZED WINDOWS
- COUNCIL TAX BAND B
- SECURE INTERCOM SYSTEM
- PARKING SPACE
- EPC RATING C
- NO CHAIN

£130,000



TOP FLOOR

Entrance

Hallway.

Lounge

4.52m x 3.56m (14' 10" x 11' 8")

Kitchen

1.94m x 3.11m (6' 4" x 10' 2")

Bedroom 1

3.23m x 3.07m (10' 7" x 10' 1")

Bedroom 2

3.04m x 2.09m (10' 0" x 6' 10")

Bathroom

1.91m x 1.80m (6' 3" x 5' 11")

PROPERTY DESCRIPTION

Henstock Property Services are pleased to market this modern 2 bedroomed top floor apartment set on the popular Millfold Mews development. The living accommodation briefly comprises; entrance hallway, lounge, modern fitted kitchen, 2 bedrooms and a bathroom. The property also has the benefit of secure door entry intercom system, upvc double glazed windows, electric heating and allocated off road parking. Well situated with walking distance of Middleton Town Centre, whilst also close to primary/secondary schools, shops/supermarkets, all everyday amenities, 5 miles from Manchester City Centre, excellent public transport services and access to motorway links M6/M60/M66. PLEASE NOTE - Service Charge is approx £126 per month. Ground rent is approx £240 per year.

