



Main Road, Danbury, CM3 4NQ

Council Tax Band E (Chelmsford City Council)



£680,000 Freehold

ACCOMMODATION

An opportunity to purchase an individual multi level detached family home located within walking distance to the centre of Danbury Village. Accommodation is set over three floors with the entry level offering two bedrooms and cloakroom with stairs leading to the middle floor which offers a stunning open plan living room, kitchen / dining room with access to a 28'7 x 10'4 roof terrace which offers stunning views over Lingwood Common and beyond. The lower ground has a modern four piece bathroom, two bedrooms and a principal bedroom which has glazed doors to the garden, walk in wardrobe and en-suite. Outside there is parking to the front. To the rear the garden is approximately 140ft in length and has the benefit of a heated swimming pool with bar.

LOCATION

The home is located in the centre of the village on the main route to Maldon and Chelmsford and is within walking distance of local amenities, primary schools and public open spaces. Danbury offers a range of local facilities which include the popular schools of Elm Green and Heathcote as well as Danbury Park School. Amenities within the village of Danbury include a local co-op supermarket, public houses and a parish church. For the commuter, Chelmsford's mainline station lies approximately 5 miles to the west of the village with Chelmsford city centre offering a more extensive range of shopping and leisure activities. Maldon town centre and South Woodham Ferrers are also within easy reach of the village

- Stunning Views over Lingwood Common
- Roof Terrace Overlooking Rear Garden
- Open Plan Living Room / Kitchen / Dining Room
- Close to Centre of Danbury Village
- Dressing Room & En-suite to Principal Bedroom
- Plot Size Approaching 1/5 of an Acre
- Driveway Parking
- Swimming Pool with Bar
- Five Bedroom Detached Family Home





Main Road

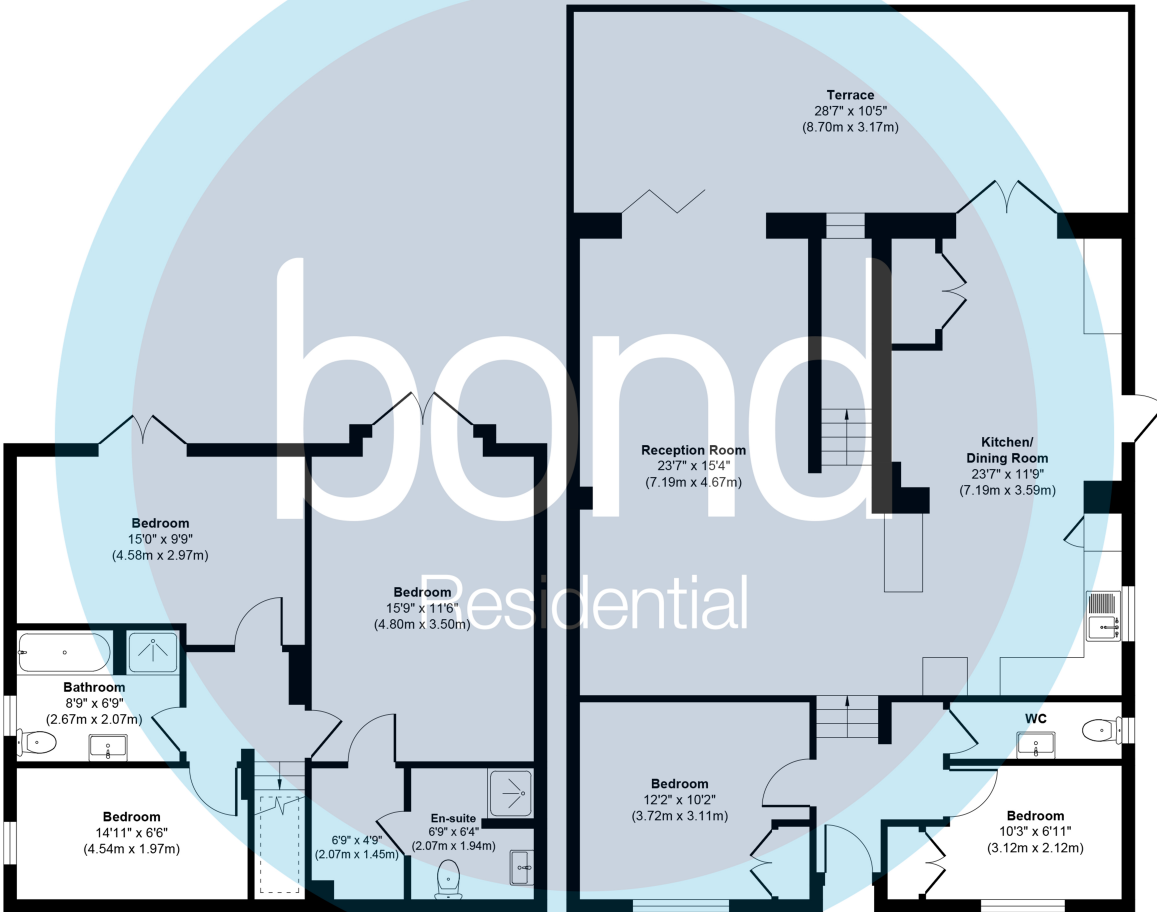

Lower Ground Floor
Approximate Floor Area
616 sq. ft
(57.30 sq. m)

Ground Floor
Approximate Floor Area
949 sq. ft
(88.19 sq. m)

Approx. Gross Internal Floor Area 1566 sq. ft / 145.49 sq. m
Illustration for identification purposes only, measurements are approximate, not to scale.
Produced by Elements Property

10, Maldon Road,
Danbury, Essex, CM3 4QQ
Telephone: 01245 222856
Website: www.bondresidential.co.uk

Consumer Protection from Unfair Trading Regulations 2008 and the Business Protection from Misleading Marketing Regulations 2008. Bond Residential have made every effort to ensure that consumers and/or businesses are treated fairly and provided with accurate material information as required by law. We have not tested any apparatus, equipment, fixture, fitting or any services and as such are unable to verify they are in working order, fit for their purpose, or within the ownership of the seller or landlord. Neither have we been able to check the legal documentation to verify the legal status of the property. We therefore advise potential buyers or tenants to verify these matters with their own solicitors or other advisers.

