



Titan Court, Flower Lane, Mill Hill, NW7

£625,000



Titan Court, Flower Lane, Mill Hill, NW7

A beautifully presented and recently refurbished two bed, two bath apartment offering 930 sq ft (85 sq m) of internal space, featuring a generously proportioned open-plan kitchen/reception area that serves as the centrepiece of this lateral flat, creating an ideal space for entertaining.

Perfect for both first time buyers and downsizers, this third floor apartment further comprises an exceptionally large master bedroom with en-suite and access to a delightful balcony, a spacious second bedroom and an additional contemporary bathroom. Further benefits include underground parking for one car, access to a stunning communal roof terrace, concierge for the building and a long lease.

We have been informed of the following:

Lease - Circa 137 years remaining

Service charge - Circa £7,950pa

Ground rent - Circa £330pa

Titan Court is ideally positioned in the heart of Mill Hill and just yards from the local amenities, restaurants and transport links that Mill Hill Broadway has to offer.

Features

- Recently Refurbished
- Stunning Open Plan Kitchen/Reception
- Perfect For First Time Buyers & Downsizers
- Exceptionally Large Master Bedroom
- Just Yards Away From Local Amenities, Restaurants & Transport Links
- Concierge Service
- Underground Parking Space
- Long Lease
- Two Bed, Two Bath



Titan Court, Flower Lane, Mill Hill, NW7

Titan Court, Flower Lane, NW7

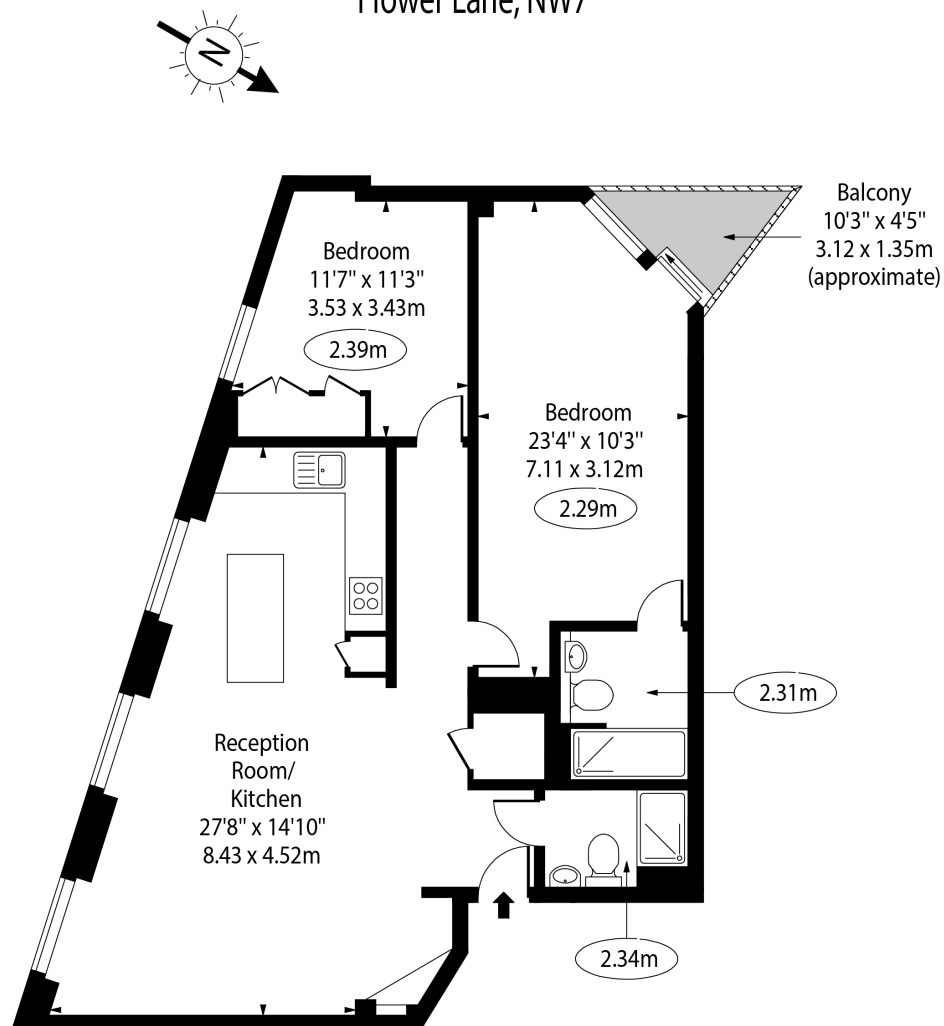

Third Floor

Approx Gross Internal Area 932 Sq Ft - 85.58 Sq M

For Illustration Purposes Only - Not To Scale Floor Plan by www.nogaphotostudio.com Ref: No.53734

This floor plan should be used as a general outline for guidance only. Any intending purchaser or lessee should satisfy themselves by inspection, searches, enquiries and full survey as to the correctness of each statement. Any areas, measurements or distances quoted are approximate and should not be used to value a property or be the basis of any sale or let.