



High Street, Baldock, Hertfordshire, SG7 6AZ

£695,000 Leasehold

| Satchells





Step Inside

High Street

This Georgian house is approximately 2700 square feet with the five bedrooms and four reception rooms spread over three floors plus the cellar; ideal for wine enthusiasts. The beautiful staircase rises to a large study area and then onto a beautiful lounge and dining room that would have been the drawing room and the tall sash windows flood the room with light and overlook the majestic wide high street. On this floor there are two double bedrooms, a home office and family bathroom. The utility room and kitchen wrap around the roof top garden terrace and can also be accessed from the lounge. There is a spiral staircase to the first floor bedroom and ground floor. Stairs lead to the top floor where you will find three double bedrooms, a snug and a further shower room.



About Baldock

High Street

No 1 is situated in a commanding position overlooking the majestic wide high street, conveniently located within strolling distance of coffee shops, bars and restaurants with the train station literally a five minute stroll. The roof top garden terrace is an absolute delight and just enhances the experience of living in a Georgian town house in the centre of Baldock. The property is leasehold, 999 years from 2012 so 986 years remaining. The council tax is band C, £2,046 per annum and whilst nil ground rent the building insurance is £3,500 per annum. Parking is available by way of a parking permit (A) allowing you to park in various locations in close proximity to the front door.







Step Outside

High Street

It is a legal requirement that all purchasers comply with Anti-Money Laundering regulations. As such, once a purchase has been agreed subject to contract, the purchaser/s will be required to undertake an AML check carried out by our third party provider at a cost of £66 inclusive of VAT per property, payable by the applicant/s.



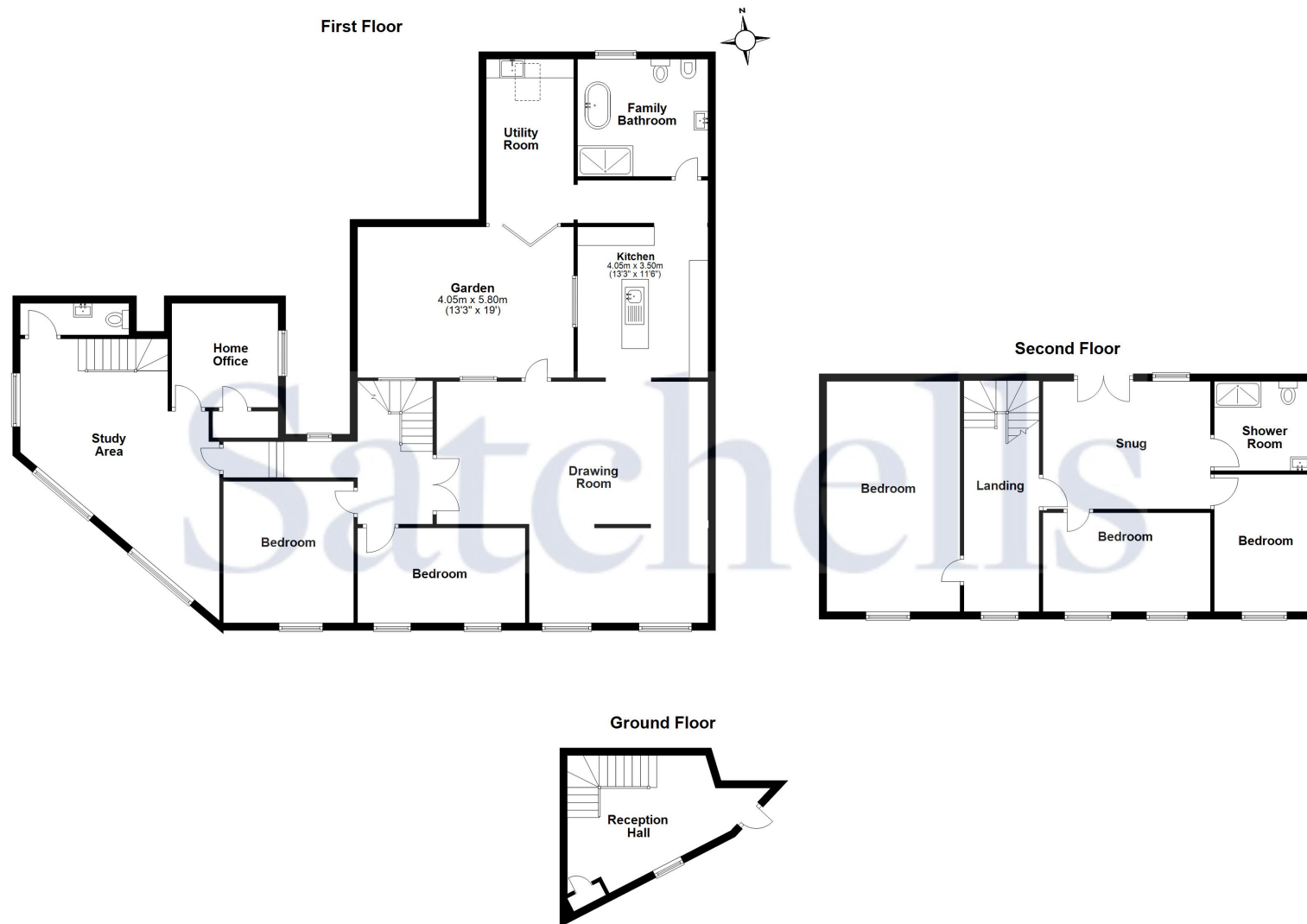

For illustrative purposes only - NOT TO SCALE - Measurements shown are approximate. The size and position of doors, windows, appliances and other features are approximate.
Plan produced using PlanUp.



8, High Street, Baldock, SG7 6AR
01462 892041
baldock@satchells.co.uk
www.satchells.com

Satchells