

FOR
SALE



29 Walkers Green, Marden, Hereford HR1 3DU

£250,000 - Freehold

22, Broad Street, Hereford, HR4 9AP 01432 355455 hereford@flintandcook.co.uk

PROPERTY SUMMARY

Situated in this popular village location, a deceptively spacious three bedroom detached bungalow requiring modernisation throughout and being sold with the benefit of no onward chain. The property offers versatile accommodation throughout and benefits from gas central heating, a good sized driveway, front and rear gardens and we highly recommend a viewing.

POINTS OF INTEREST

- *Popular village location!*
- *No onward chain!*
- *Ideal for a family or retirement*
- *Requires modernising throughout*
- *Garage, driveway and good sized garden*
- *Three bedroom detached bungalow*



ROOM DESCRIPTIONS

Ground floor

With entrance door into

Entrance porch

With tiled floor, window to the front aspect and doors to

Entrance hallway

With tiled floor, two windows to the front and door into the

Dining room

With radiator, ceiling light point, two built in storage cupboards, one housing the fuse box, double glazed window and doors to

Kitchen

Comprising wall and base units, double stainless steel sink unit, freestanding cooker, double glazed window and radiator.

Living room

With two ceiling light points, large radiator, large double glazed window overlooking the rear garden, feature fireplace and doors to

Side porch

With ceiling light points, door out to the driveway and useful storage cupboard.

Inner hallway

With ceiling light point, loft hatch, smoke alarm, cupboard housing the Worcester Bosch gas central heating boiler and doors to

Bedroom one

With two ceiling light points, radiator, double glazed window, fitted wardrobes and fitted shower cubicle.

Bedroom two

With built in wardrobe, double glazed window, radiator and ceiling light points, access door from the inner hallway and second door out to the rear hall/ study

Bathroom

Three piece suite comprising panelled bath, toilet, pedestal wash hand basin, radiator, heated towel rail, ceiling light point and window.

Office area

With radiator, ceiling light points, window with secondary glazing out to the garden with access to the rear hall with door to the rear and two doors into

Reception room/bedroom

With tiled floor, radiators window, ceiling light point and built in wardrobe.

Bedroom three

With radiator, ceiling light point, window with secondary glazing and double built in wardrobe.

An access door from the entrance porch provides access to

Side passage/utility

With door to the front, door leading into a further toilet, access door into a utility room with space and plumbing for washing machine and tumble dryer, storage room with electric and light and door out to a side walkway leading to the rear garden.

Outside

To the rear a great sized lawned garden south facing, with paved patio area and pathway leading to the personal door to the rear of the garage, brick shed and side access gate. The rear garden is enclosed by hedging and fencing. To the front is a good sized driveway providing ample off road parking with access to the front garage door leading into a carport with a further garage beyond, there is also a good sized area of lawn.

Directions

Heading north from Hereford on the A49 towards Leominster turn right towards Moreton on Lugg, continue through the village and over the train tracks. Then take the left turn to Marden, continue into the village of Marden taking a left at Walkers Green, turn right by The Volunteer pub and the property is situated a short distance down on the right hand side.

Services

Mains water, electricity, drainage and gas are connected. Gas-fired central heating. Telephone (subject to transfer regulations).

Outgoings-

Council tax band D - £2,449 for 2025/2026
Water and drainage rates are payable.

Viewings-

Strictly by appointment through the Agent, Flint & Cook, Hereford (01432) 355455.

Opening Hours

Monday - Friday 9.00 am - 5.30 pm
Saturday 9.00 am - 1.00 pm

Money Laundering Regulations-

Prospective purchasers will be asked to produce identification, address verification and proof of funds at the time of making an offer.

Floor Plan
Approx. 129.7 sq. metres (1396.4 sq. feet)

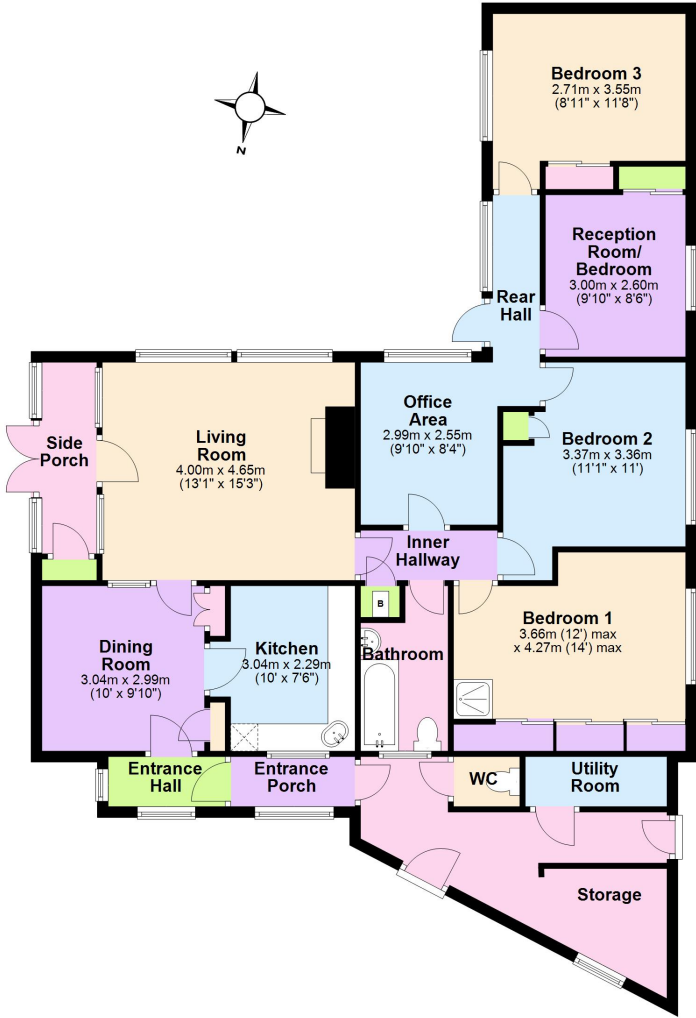

Total area: approx. 129.7 sq. metres (1396.4 sq. feet)
29 Walkers Green, Marden, Hereford



These particulars are prepared for the guidance only of prospective purchasers. They are intended to give a fair and overall description of the property and do not constitute the whole or any part of an offer or contract. Any information contained herein (whether in text, plans or photographs) is given in good faith but should not be relied upon as being a statement or representation of fact. Any plans provided by the agents and/or with the sales particulars are intended for guidance purposes only; we cannot guarantee the accuracy and scale of any plans, and they do not form any part of the sales contract. Nothing in these particulars shall be deemed to be a statement that the property is in good condition or otherwise nor that any services or facilities are in good working order. Any movable contents, fixtures and fittings, (whether wired or not) referred to in these property particulars (including any shown in the photographs) are, unless the particulars say otherwise, excluded from the sale. In the event that the buyer proposes to purchase any movable contents or include them in any offer for the property, the buyer cannot in any respect imply any such inclusion from the property particulars. Any areas, measurements or distances referred to herein are approximate only and may be subject to amendment. It should not be assumed that the property has all necessary planning, building regulation or other consents and these matters must be verified by an intending purchaser. The information in these particulars is given without responsibility on the part of the agents or their clients and neither the agents nor their employees have any authority to make or give any representations or warranties whatever in relation to this property.

Flint & Cook Privacy Statement: We take your privacy very seriously. Your data will not be shared with any other parties without your express permission. Our Data protection Policy can be read in full on the Flint & Cook website, www.flintandcook.co.uk

Energy Efficiency Rating		
	Current	Potential
Very energy efficient - lower running costs		
(92+) A		
(81-91) B		
(69-80) C		
(55-68) D	65	75
(39-54) E		
(21-38) F		
(1-20) G		
Not energy efficient - higher running costs		
England, Scotland & Wales		
EU Directive 2002/91/EC		