



KUBIE GOLD
ASSOCIATES

DORSET SQUARE MARYLEBONE NW1



- ONE BEDROOM
- SPACIOUS
- PERIOD CONVERSION

- WOOD FLOORS
- HIGH CEILINGS
- AVAILABLE 20TH DECEMBER

£2,816.66 pcm

SALES, LETTINGS & PROPERTY MANAGEMENT

Tel:

020 7563 7272

36 Ivor, Regents Park, London, NW1 6EA

Email: info@kubie-gold.co.uk Website: www.kubie-gold.co.uk

Kubie Gold Associates is the trading name of Kubie Gold Associates Ltd
Company Registration No. 7271501 registered in England and Wales



Dorset Square, NW1

An exceptionally spacious one bedroom apartment set on the first floor of this fine period conversion. Reception room with parquet flooring, high ceilings and sash windows. Fully fitted kitchen with all machines and spectacular views onto the garden square. A key to the square will be provided. Top quality. Unfurnished available 20th December 2024

Dorset Square

Approx. Gross Internal Area 631 Sq Ft - 58.62 Sq M

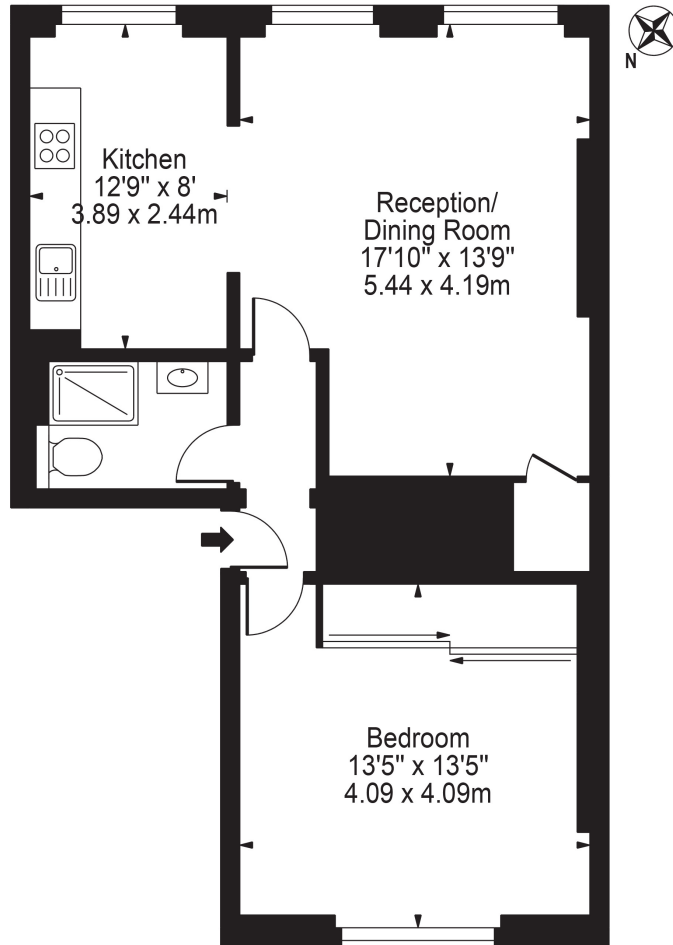

First Floor

For Illustration Purposes Only - Not To Scale

This floor plan should be used as a general outline for guidance only and does not constitute in whole or in part an offer or contract. Any intending purchaser or lessee should satisfy themselves by inspection, searches, enquiries and full survey as to the correctness of each statement. Any areas, measurements or distances quoted are approximate and should not be used to value a property or be the basis of any sale or let.

Local Authority:

Westminster

Tax Band:

Band E

Energy Efficiency Rating		
	Current	Potential
Very energy efficient - lower running costs		
(92+)	A	
(81-91)	B	
(69-80)	C	
(55-68)	D	
(39-54)	E	
(21-38)	F	
(1-20)	G	
Not energy efficient - higher running costs		
	77	80

England, Scotland & Wales

EU Directive 2002/91/EC

