



Market Place

Hitchin,
Hertfordshire, SG5 1DT
Guide Price £360,000

GATWARDS
JEWELLERS EST. 1760
country
properties

A UNIQUE OPPORTUNITY TO PURCHASE AN APARTMENT IN THE HEART OF THE TOWN CENTRE OF HITCHIN.

Located in the heart of the town centre, on Market Place is this two bedroom apartment spanning 969 sq ft. The apartment offers a large living room. Separate kitchen with storage. Two good size bedrooms, the second with dual aspect windows and a family bathroom. This apartment is being offered as an opportunity to renovate and make into your perfect home.

Lease details:

Lease: 999 Years

Service charge: £1250 Per annum

Ground rent: N/a

Hitchin is a charming medieval market town and has many fine Tudor and Georgian buildings, particularly around the market square. Near to the market square stands the large medieval parish church of St Mary. The town provides good shopping as well as a swimming pool, football team, two theatres, a wide variety of restaurants and pubs and highly regarded girls and boys schools. There is also a mainline railway station providing direct access to Kings Cross and Cambridge.

- Located in the centre of Hitchin
- Unique opportunity to make your dream home
- Over 950 sqft of accommodation
- 0.9 mile, 20 mins walk to Hitchin Mainline Railway Station (as per Google Maps)
- NO ONWARD CHAIN





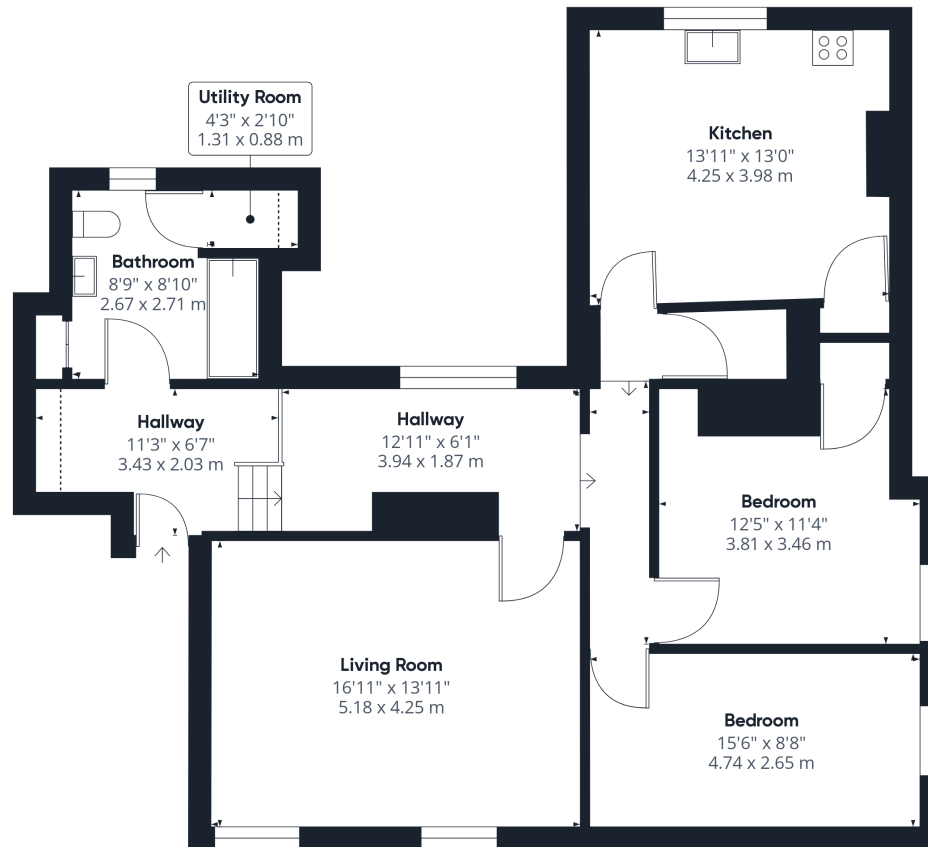

Approximate total area⁽¹⁾

969.3 ft²
90.05 m²

Reduced headroom

8.14 ft²
0.76 m²

(1) Excluding balconies and terraces

Reduced headroom
..... Below 5 ft/1.5 m

While every attempt has been made to ensure accuracy, all measurements are approximate, not to scale. This floor plan is for illustrative purposes only.
Calculations are based on RICS IPMS 3C standard.

GIRAFFE360

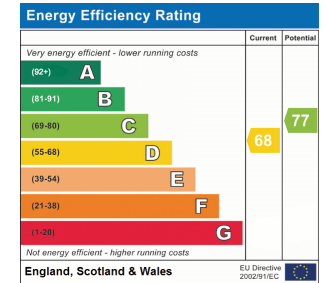

All measurements are approximate and quoted in metric with imperial equivalents and for general guidance only and whilst every attempt has been made to ensure accuracy, they must not be relied on. The fixtures, fittings and appliances referred to have not been tested and therefore no guarantee can be given and that they are in working order. Internal photographs are reproduced for general information and it must not be inferred that any item shown is included with the property. For a free valuation, contact the numbers listed on the brochure.

Viewing by appointment only

Country Properties | 6, Brand Street | SG5 1HX
T: 01462 452951 | E: hitchin@country-properties.co.uk
www.country-properties.co.uk

country
properties