



Princess Road, London, NW6

£3,500
pcm



Princess Road, London, NW6

A stylish and immaculately presented duplex apartment offering three bedroom, two bathrooms and a delightful private rear garden. This family flat boasts 1149 Sq Ft (106 Sq M) of internal space with a charming reception room and a contemporary kitchen (both with impressive ceiling heights of circa 3.33M) found on the upper floor level and three bedrooms and two bathrooms arranged over the lower level.

Princess Road is perfectly located just 0.2 miles from Kilburn Park underground station and 0.5 miles from Queens Park station along with the local amenities, shops and restaurants that Salusbury Road has to offer. Furthermore the property is situated 0.9 miles from Maida Vale underground station with Green spaces like Paddington Recreation Ground and Queen's Park also within easy reach.

Features

- Three Bedroom Apartment
- Two Bathrooms
- Stylish & immaculately Presented
- Family Flat
- 0.5 Miles From Queens Park Station
- 1149 Sq Ft (106 Sq M) Of Internal Space
- Charming Reception Room
- Contemporary Kitchen With Dining Space
- Private Rear Garden
- Available From Mid-July



Princess Road,
London, NW6

Princess Road, NW6

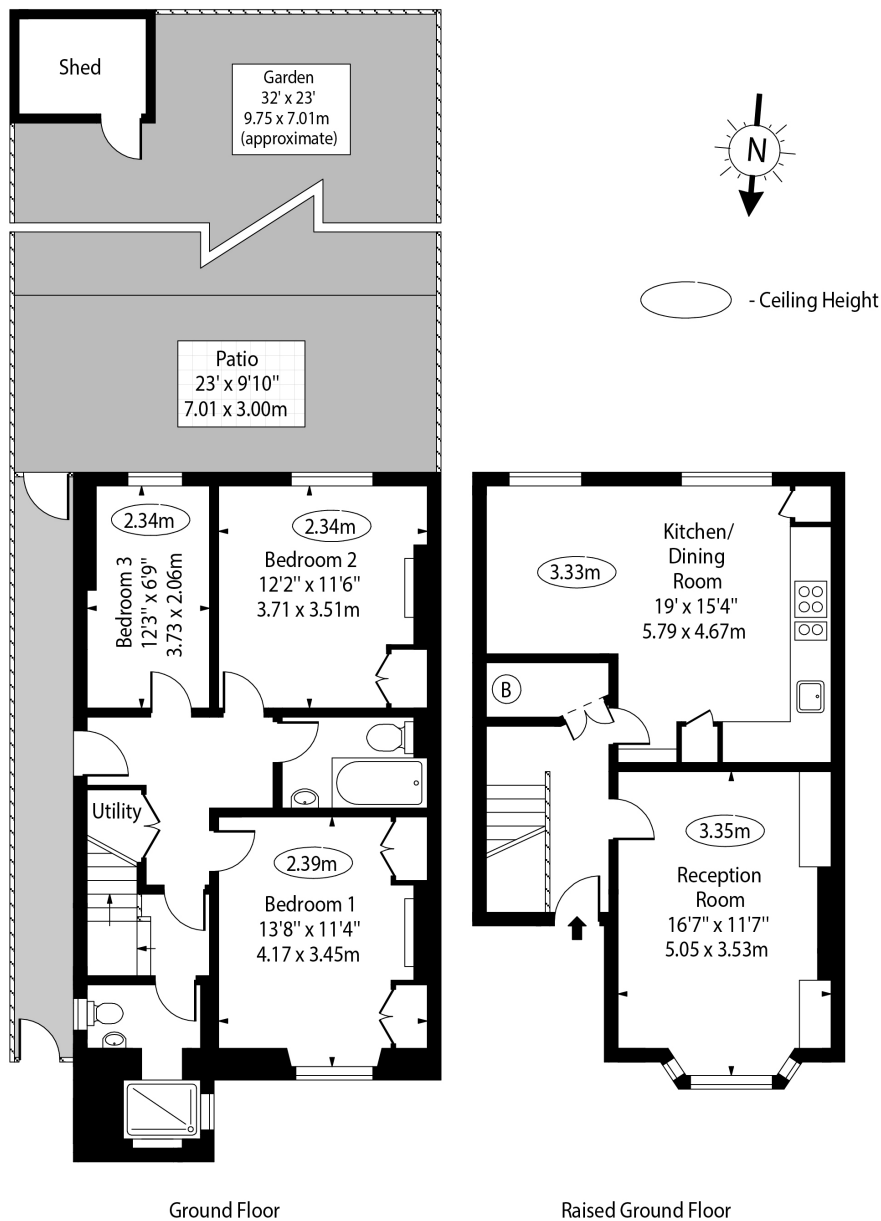

Approx Gross Internal Area 1149 Sq Ft - 106.74 Sq M
(Excluding Shed)

For Illustration Purposes Only - Not To Scale Floor Plan by www.nogaphotostudio.com Ref: No.52346

This floor plan should be used as a general outline for guidance only. Any intending purchaser or lessee should satisfy themselves by inspection, searches, enquiries and full survey as to the correctness of each statement. Any areas, measurements or distances quoted are approximate and should not be used to value a property or be the basis of any sale or let.