

24 Star Road, Peterborough, PE1 5HP



Capitol Lettors has not tested any of the equipment or the heating system (if mentioned) in these details. Purchasers are advised to satisfy themselves as to their working order and condition. These particulars do not constitute or form any part of an offer or contract nor may they be regarded as representations. All interested parties must themselves verify their accuracy. All measurements are approximate.

Capitol Lettors

Capitol Lettors Sales & Letting Agents

PO Box 1476, Peterborough, Cambs, PE2 2WX

Tel: 01733 553366

Email: Enquiries@capitollettors.com • www.capitollettors.com

VAT No. 922 2845 32 • Company Registration No. 6218276



24 Star Road, Peterborough, PE1 5HP

£165,000 Freehold

NO CHAIN. Set within walking distance of Peterborough City Council this Victorian two/three bedroom terraced property offering lounge, dining room, kitchen, downstairs bathroom, two bedrooms and third off second bedroom, patio yard and garden to rear, shared access alley to front, on street parking.

Good access to Peterborough City Centre and all major road networks.

Many local shops, schools etc nearby



www.capitollettors.com

Zoopa.co.uk
Smarter property search

24 Star Road, Peterborough, PE1 5HP

Lounge

3.50m x 3.58m (11' 6" x 11' 9") Approx
UPVC window to front aspect, UPVC door to front aspect, radiator, wood effect flooring, air vent and door to

Inner Hall

Stairs to first floor and access to

Dining room

3.50m x 3.64m (11' 6" x 11' 11") Approx
UPVC double glazed window to rear, access to kitchen, radiator, wood effect flooring, understairs cupboard with electric meter and fuses

Kitchen

1.86m x 3.03m (6' 1" x 9' 11") Approx
UPVC door and window to rear, single drainer sink with taps, radiator, gas cooker point, plumbing for washing machine, vinyl flooring, range of eye and base level kitchen units with worktops above, door to

Inner Lobby

Shelving, air vent and access to

Bathroom

1.86m x 1.67m (6' 1" x 5' 6") Approx
UPVC glazed to rear, radiator, vinyl flooring, tiled splashbacks, radiator, comprising of three piece bathroom suite with low level WC, pedestal wash hand basin and paneled bath

with electric shower over

Stairs to first floor landing

Access to bedrooms one and two

Bedroom 1

3.50m x 3.63m (11' 6" x 11' 11") Approx
UPVC double glazed window to front aspect, radiator, cupboard with loft access

Bedroom 2

4.55m x 3.63m (14' 11" x 11' 11") Approx
UPVC double glazing window to rear, radiator, storage cupboard, access to Bedroom 3

Bedroom 3

2.37m x 3.02m (7' 9" x 9' 11") Approx
UPVC double glazed window to rear, radiator

Outside - front

On street parking, utility meters, small paved area, access to shared alley to rear

Outside - rear

Enclosed patio area, then shared access to rear garden, shared alley to front aspect, mainly laid to lawn and shrubs, concrete path

24 Star Road, Peterborough, PE1 5HP

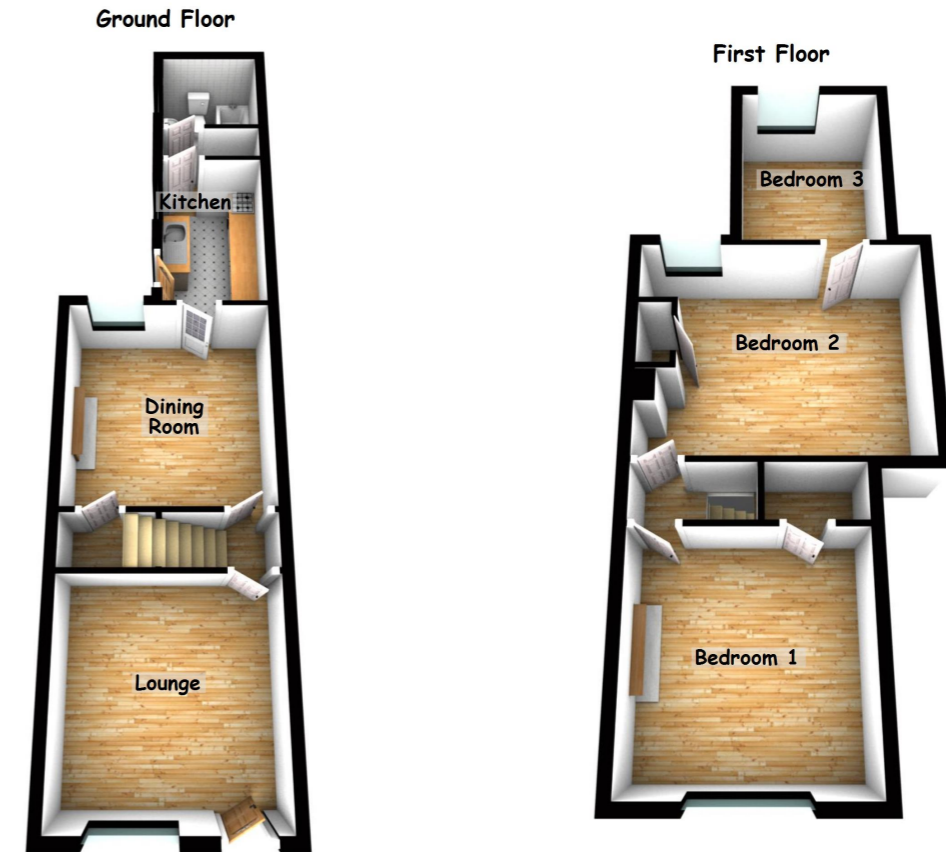

This plan is for illustration purposes only and may not be representative of the property. Plan may not be to scale. Plan produced using PlanUp.

Star Road

