



43 Hythe Road, Oakdale, POOLE, Dorset BH15 3NN

£340,000 Freehold

info@anthonydavid.co.uk
www.anthonydavid.co.uk
01202 677444

A superb two double bedroom detached bungalow situated in this quiet residential road in Oakdale within close proximity of local shops, schools and amenities. This bright and sunny property is presented immaculately throughout and internal viewing is highly advised to appreciate the pristine accommodation on offer, which comprises: living room with direct access to sun terrace, kitchen/breakfast room, utility room and modern bathroom. Externally the property boasts a Westerly aspect low maintenance garden with roof top views. To the front the driveway provides off road parking. Further features of this 'little gem' include; feature fireplace to lounge, fitted wardrobes to both bedrooms, shutters, workshop, gas central heating and UPVC double glazing. Nearby Schools - Canford Heath Infants and Juniors, Stanley Green Infants, Oakdale Juniors and St Edwards RC/CoE Secondary is a short walk away.

**ANTHONY
DAVID & CO**

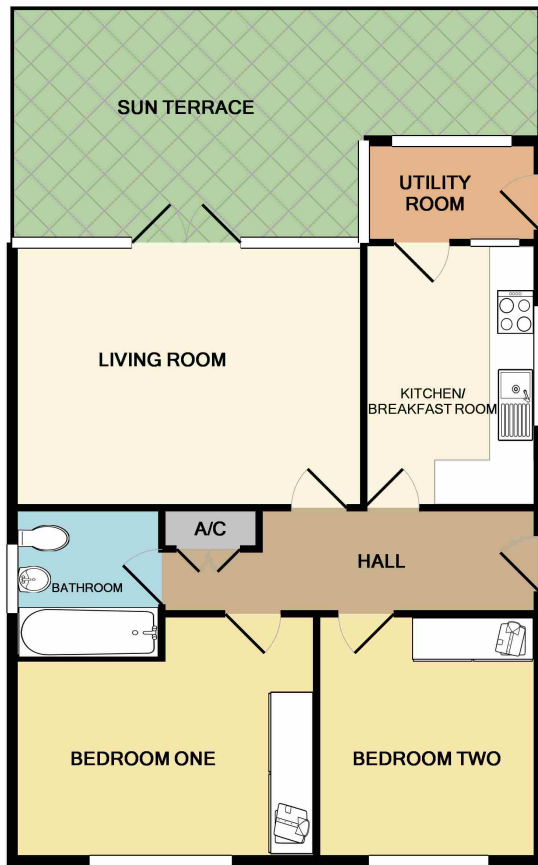

Entrance Hall 18' x 4' 2" (5.49m x 1.27m)

Lounge 15' 8" x 12' (4.78m x 3.66m)

Kitchen 11' 10" x 8' (3.61m x 2.44m)

Bedroom One 13' 7" x 11' (4.14m x 3.35m) max

Bedroom Two 10' x 9' 10" (3.05m x 3.00m)

Bathroom 6' x 5' 6" (1.83m x 1.68m)

Rear Lobby 8' x 4' 5" (2.44m x 1.35m)

Garden Westerly aspect

Driveway Off road parking

Council Tax Band C

TOTAL APPROX. FLOOR AREA 681 SQ.FT. (63.3 SQ.M.)

Whilst every attempt has been made to ensure the accuracy of the floor plan contained here, measurements of doors, windows, rooms and any other items are approximate and no responsibility is taken for any error, omission, or mis-statement. This plan is for illustrative purposes only and should be used as such by any prospective purchaser. The services, systems and appliances shown have not been tested and no guarantee as to their operability or efficiency can be given
Made with Metropix ©2018

