



Day & Co
ESTATE AGENTS

28 Cavendish Street
Keighley
BD21 3RG



23 Lower Town Mills, Oxenhope,
Keighley, West Yorkshire, BD22
9JY

£269,995

T: 01535 664609

W: www.dayandcoestateagents.co.uk

E: keighley@dayandcoestateagents.co.uk

- Awaiting EPC
- Four Bedrooms & Master En-Suite
- Double Drive & Integral Garage

- Superbly Presented Modern Town House
- Accommodation Over Three Floors
- Enclosed Rear Patio/Sought After Village Of Oxenhope

SUMMARY

****A SUPERBLY PRESENTED 4 BEDROOM (MASTER EN-SUITE) MODERN TOWN HOUSE, SOUGHT AFTER VILLAGE LOCATION OF OXENHOPE WITH RIVERSIDE OUTLOOK!!**** Having accommodation over 3 floors, modern dining kitchen with integrated appliances, enclosed rear patio, double driveway, integral garage - VIEWING ESSENTIAL TO FULLY APPRECIATE!! Awaiting EPC.

FULL DESCRIPTION

Viewing is essential to fully appreciate this superbly presented four bedroom (master en-suite) modern town house situated in the sought after village location of Oxenhope with riverside outlook to the rear. The three storey accommodation comprises of an entrance hall giving access to a cloaks WC and the integral garage with up and over electric door. The dining kitchen is a real feature of this property having an attractive range of modern base and wall mounted units, integrated appliances to include double oven, five ring gas hob, extractor fan, dishwasher, fridge, freezer, under stairs storage cupboard, double glazed patio doors to the rear. To the first floor the spacious lounge has double glazed patio doors leading to a Juliet balcony, a living flame gas coal effect fire, double glazed window to the rear. The master bedroom is on this level having fitted mirror fronted wardrobes and an en-suite shower room with shower cubicle, WC, wash hand basin. To the second floor there are three further bedrooms and the house bathroom having a three piece suite comprising of a bath with shower over, WC, wash hand basin. Externally there is a double drive to the front leading to the integral garage, there is a rear enclosed patio with riverside outlook. Awaiting EPC.

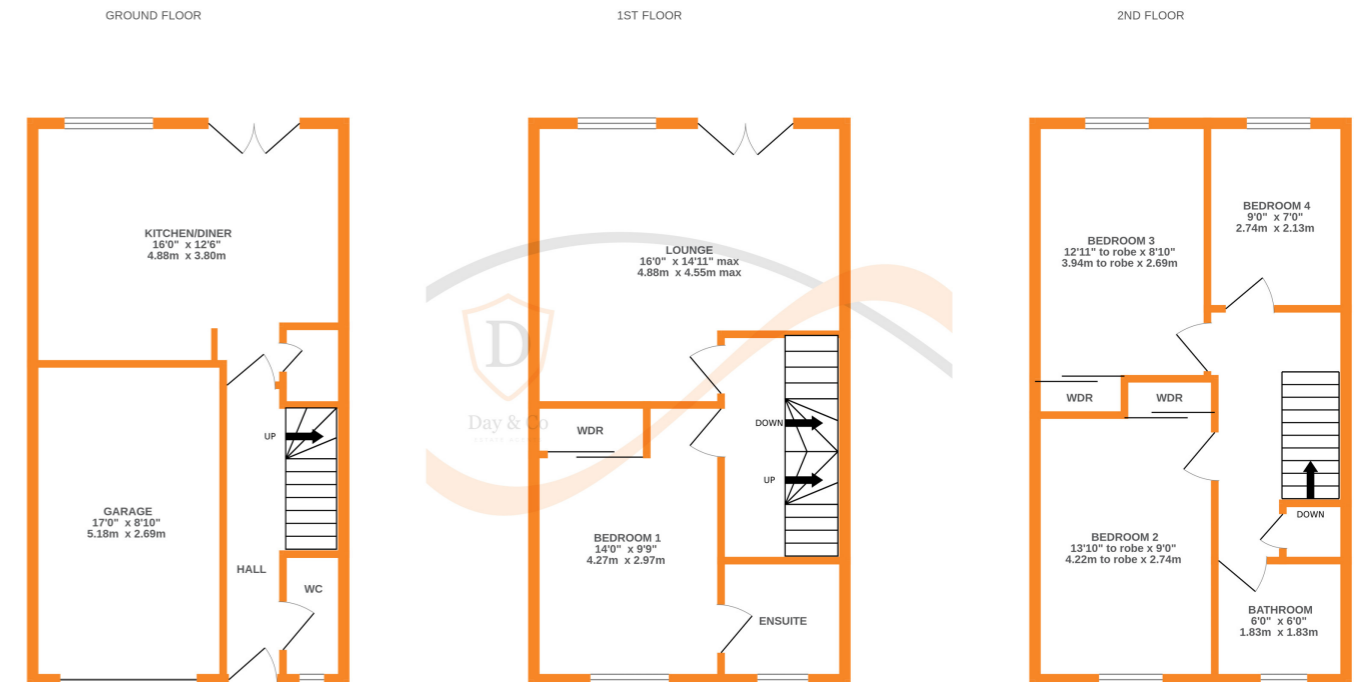

Whilst every attempt has been made to ensure the accuracy of the floorplan contained here, measurements of doors, windows, rooms and any other items are approximate and no responsibility is taken for any error, omission or mis-statement. This plan is for illustrative purposes only and should be used as such by any prospective purchaser. The services, systems and appliances shown have not been tested and no guarantee as to their operability or efficiency can be given.
Made with Metropix ©2024