



## Whitings Court

Paynes Park | Hitchin | Herts | SG5 1EJ

[www.stonegate-estates.co.uk](http://www.stonegate-estates.co.uk)





# WHITINGS COURT

## Property Description

We are delighted to offer for sale this rarely available one bedroom retirement apartment situated within the town centre.

The property has numerous benefits which include a shower room, a well appointed kitchen, built in storage cupboard, no upward chain and direct access onto the communal garden.

This popular development has a communal lounge, laundry facilities, a development manager, residents parking and delightful gardens.

The property is available for viewing via appointment only and should be seen to avoid disappointment.

Hitchin town provides a broad range of shops and a regular traditional market, together with a good selection of restaurants, bars and pubs within its historic centre. The town also provides a swimming centre, theatres and a library, whilst the commuter is served by the main line railway station (Kings Cross - 30 minutes) and direct links to the A1(M).

**£165,000 Leasehold**







**Ground Floor**

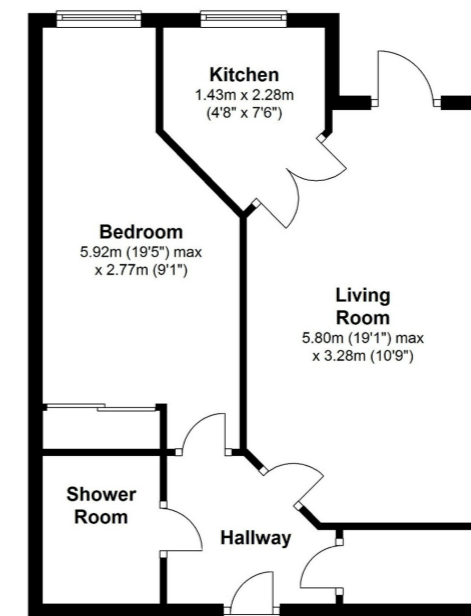

All measurements shown are approximate and for guidance only. Garages and workshops are not included in any gross floor areas unless integral to the main building where they will be included.  
Plan produced using PlanUp.

**4 Whittings Court, Hitchin**





- One Bedroom Apartment
- Retirement
- Communal Gardens
- Resident House Manager
- Residents Lounge
- Laundry Facilities
- Direct Access to Garden
- Shower Room

EPC Rating:

Stonegate Estate Agents

01462 438979

[sales@stonegate-estates.co.uk](mailto:sales@stonegate-estates.co.uk) | [www.stonegate-estates.co.uk](http://www.stonegate-estates.co.uk)

