



8 Leopold Avenue, FARNBOROUGH, Hampshire GU14 8NJ

£650,000 Freehold

VIDEO TOUR AVAILABLE JIGSAW ESTATES HAMPSHIRE are delighted to bring to the market this detached, period home situated on a quiet road in the desirable location of Empress Park. Farnborough Main station is just a 0.7 mile walk away, and offers a number of fast services to London. Also within walking distance are a number of schools and the Farnborough town centre which has had many improvements in recent years. The property also offers potential to extend (stpp) and is offered with NO ONWARD CHAIN.

The ground floor comprises; entrance hall, living room, dining room with french doors leading to rear garden, kitchen breakfast room, boot room with access to the garage and a separate utility room. On the first floor there are; two generous double bedrooms, a single room, separate w.c. and a bathroom. Outside is a large, secluded rear garden with designated patio area.

Mis-descriptions Act: We wish to inform prospective purchasers that we have not carried out a detailed



- EMPRESS PARK
- POTENTIAL TO EXTEND (STPP)
- THREE BEDROOMS
- UPVC DOUBLE GLAZING
- WALKING DISTANCE OF FARNBOROUGH MAIN
- NO ONWARD CHAIN
- SECLUDED REAR GARDEN
- COUNCIL TAX BAND = E

Ground Floor

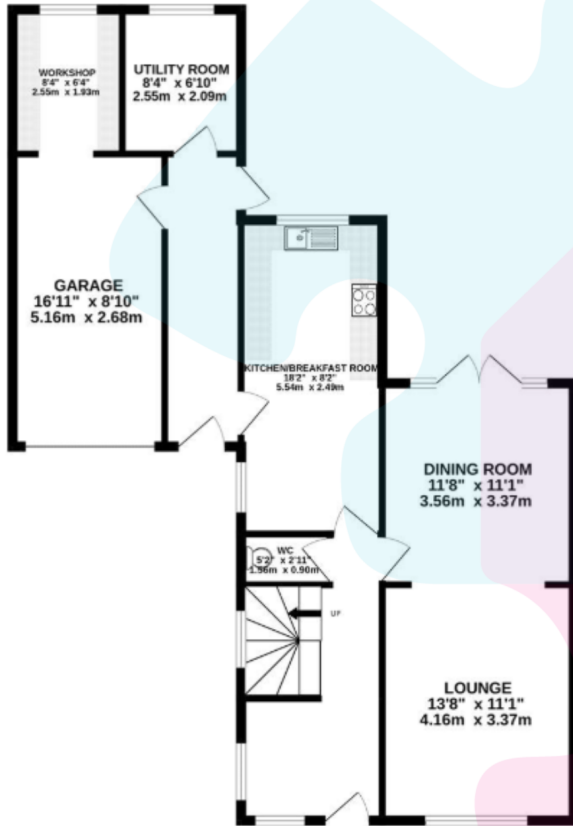

First Floor

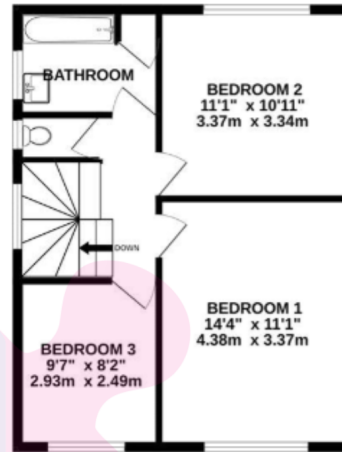

Whilst every attempt has been made to ensure the accuracy of the floorplan contained here, measurements of doors, windows, rooms and any other items are approximate and no responsibility is taken for any error, omission or mis-statement. This plan is for illustrative purposes only and should be used as such by any prospective purchaser. The services, systems and appliances shown have not been tested and no guarantee as to their operability or efficiency can be given.

Made with Metropix ©2023

