





- Character Period Cottage
- Two Reception Rooms
- Modern Fitted kitchen
- Outside Utility Room
- Two Bedrooms
- Modern Bathroom
- Long, Landscaped Garden
- On Road Parking

Description

A charming, fully modernised and exceptionally well presented two bedroom mid-terrace cottage, located is a slightly elevated position on a one-way street, close to the centre of the village. The property has the benefit of PVCu double glazed windows and gas central heating and the accommodation comprises: Dining room, lounge, fully fitted kitchen, outside utility room, first floor landing, two bedrooms and bathroom. To the rear there is a long landscaped garden and parking is available on street. Available either part furnished or unfurnished to suit the tenants requirements. Restrictions apply.



Location
Tenure

EPC Rating: D



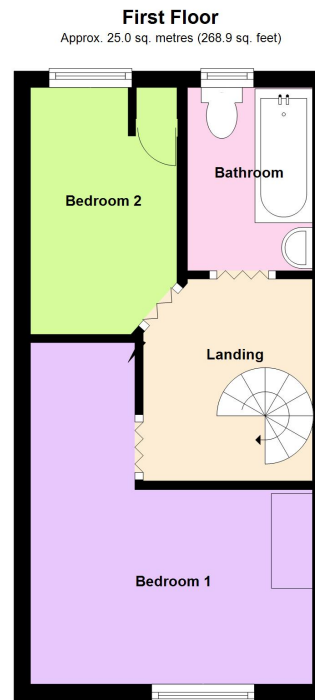
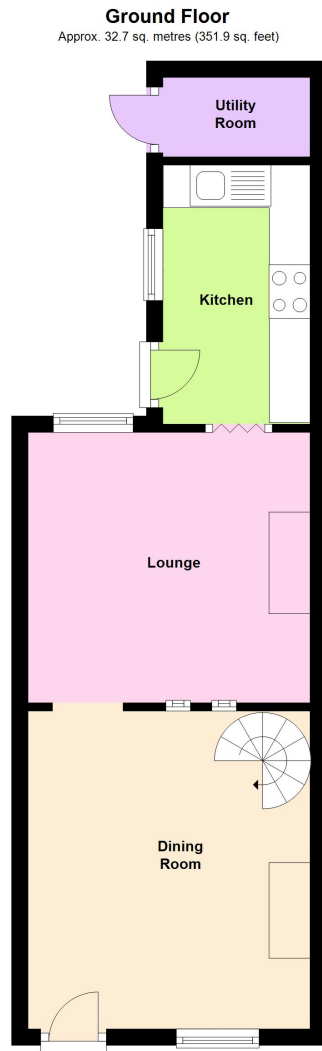

Total area: approx. 57.7 sq. metres (620.8 sq. feet)



Williams Estates is the trading name of Williams Estates (Ltd). Registered address 33, The Green, Hartford, Northwich, Cheshire, CW8 1QA.
Reg number 07682683. Director Andrew P Williams