



Lilac Walk, Kempston, Bedford MK42 7PF



Lilac Walk  
Kempston  
Bedford  
MK42 7PF

Guide Price £260,000

Three bedroom end of terraced property situated close to all local amenities and sold with no chain. Property benefits from a lounge/diner, wet room, drive and garage.

- Three bedroom end of terrace property
- No chain
- Double glazed windows & doors & gas radiator heating
- Lounge /Diner
- Kitchen
- 3 Bedrooms
- Wet room/bathroom
- Front & Rear gardens
- Garage & Driveway

- Council Tax Band B
- Energy Efficiency Rating D



## Close to all amenities

Entering the property into the hallway which has stairs to the first floor, two under stairs storage cupboards, one which houses the meters. Doors leading to living areas. Lounge/diner with windows to front and rear. Door into kitchen. Kitchen is fitted with a range of units, sink and drainer, wall mounted boiler, space for cooker, plumbing for washing machine. Door leading to rear garden. On the first floor there are two double bedrooms and one single. Wet room/bathroom is fitted with a walk in shower, W.C and wash hand basin. On the outside front garden with brick retaining wall. Rear garden all laid to paving with personal access door into garage. Parking space in front of garage.



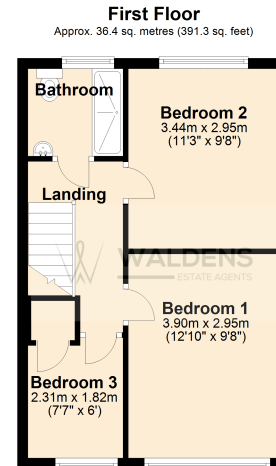
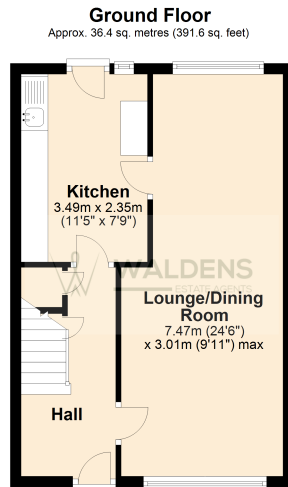

Total area: approx. 72.7 sq. metres (782.9 sq. feet)

This floor plan is for illustrative purposes only. The total size does not include outbuildings and is an approximate.  
Plan produced using PlanUp.

Energy Efficiency Rating		Current	Potential
Very energy efficient - lower running costs			
(92-100)	<b>A</b>		
(81-91)	<b>B</b>		84
(69-80)	<b>C</b>		
(55-68)	<b>D</b>	64	
(39-54)	<b>E</b>		
(21-38)	<b>F</b>		
(1-20)	<b>G</b>		
Not energy efficient - higher running costs			
<b>England, Scotland &amp; Wales</b>		EU Directive 2002/91/EC	