

FOR  
SALE



4 Burrows Court, Hampton Park, Hereford HR1 2SN

£149,995 - Leasehold

22, Broad Street, Hereford, HR4 9AP 01432 355455 [hereford@flintandcook.co.uk](mailto:hereford@flintandcook.co.uk)

## PROPERTY SUMMARY

Retirement bungalow on exclusive development with 2 bedrooms, electric heating, double glazing, site manager. Over 60's.

## POINTS OF INTEREST

- *Retirement bungalow - over 60's*
- *Exclusive development*
- *2 Bedrooms*
- *Electric heating*
- *Double glazing*
- *Site Managed*



## ROOM DESCRIPTIONS

### **Entrance Porch**

With door to the

### **Living Room**

Electric storage heater, window to front, door and serving hatch into the

### **Kitchen**

Base and wall mounted units, worksurfaces, tiled splashbacks, space for electric cooker, hatch to roof space, window and door to rear.

### **A door leads from the Living Room into the Inner Hall**

Storage heater, emergency pull-cord, airing cupboard with hot water cylinder, electric panel heater.

### **Bedroom 1**

Electric panel heater, windows to front.

### **Bedroom 2**

Electric panel heater, built-in wardrobe, window to rear.

### **Bathroom**

Suite comprising a low level bath, wash hand-basin, WC, wall mounted electric heater, extractor fan.

### **Outside**

There are well-maintained communal grounds with parking and to the rear there is a pathway with railings beyond which is a stream and a pleasant outlook.

### **Tenure & Possession**

Leasehold on a 999 year Lease commenced in 1985. Service charge £274 per quarter (to include buildings insurance, maintenance and lighting of communal areas, site management costs with pull-cord link to Accord Care. Service charge also includes external renewals (glazing etc). Vacant possession on completion.

### Floor Plan

Approx. 53.5 sq. metres (575.9 sq. feet)

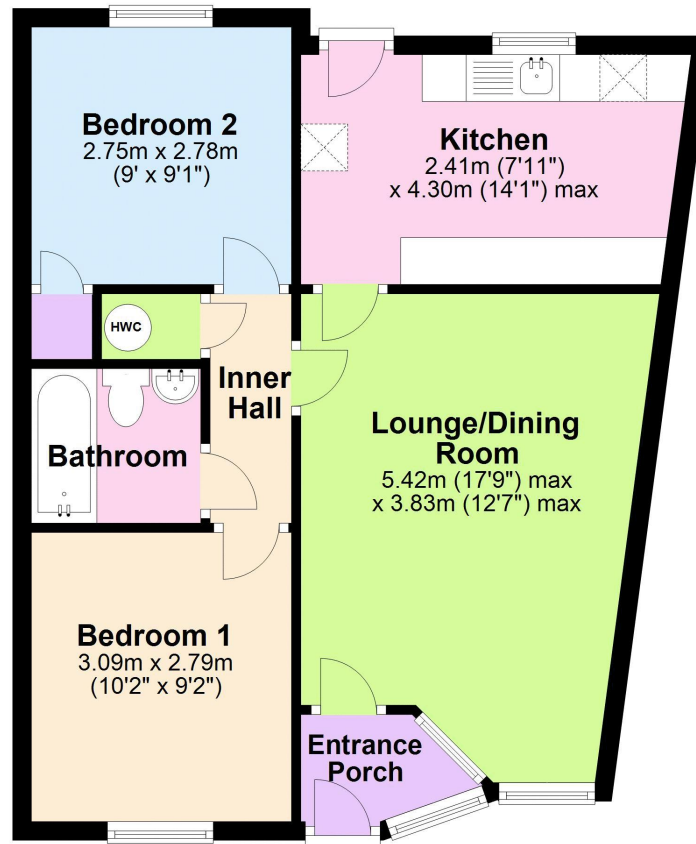
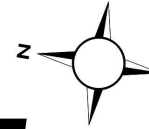

Total area: approx. 53.5 sq. metres (575.9 sq. feet)

These plans are for identification and reference only.  
Plan produced using PlanUp.

### 4 Burrows Court, Hereford

These particulars are prepared for the guidance only of prospective purchasers. They are intended to give a fair and overall description of the property and do not constitute the whole or any part of an offer or contract. Any information contained herein (whether in text, plans or photographs) is given in good faith but should not be relied upon as being a statement or representation of fact. Any plans provided by the agents and/or with the sales particulars are intended for guidance purposes only; we cannot guarantee the accuracy and scale of any plans, and they do not form any part of the sales contract. Nothing in these particulars shall be deemed to be a statement that the property is in good condition or otherwise nor that any services or facilities are in good working order. Any movable contents, fixtures and fittings, (whether wired or not) referred to in these property particulars (including any shown in the photographs) are, unless the particulars say otherwise, excluded from the sale. In the event that the buyer proposes to purchase any movable contents or include them in any offer for the property, the buyer cannot in any respect imply any such inclusion from the property particulars. Any areas, measurements or distances referred to herein are approximate only and may be subject to amendment. It should not be assumed that the property has all necessary planning, building regulation or other consents and these matters must be verified by an intending purchaser. The information in these particulars is given without responsibility on the part of the agents or their clients and neither the agents nor their employees have any authority to make or give any representations or warranties whatever in relation to this property.

**Flint & Cook Privacy Statement:** We take your privacy very seriously. Your data will not be shared with any other parties without your express permission. Our Data protection Policy can be read in full on the Flint & Cook website, [www.flintandcook.co.uk](http://www.flintandcook.co.uk)

Energy Efficiency Rating		
	Current	Potential
Very energy efficient - lower running costs		
(92+) <b>A</b>		90
(81-91) <b>B</b>		
(69-80) <b>C</b>		
(55-68) <b>D</b>	66	
(39-54) <b>E</b>		
(21-38) <b>F</b>		
(1-20) <b>G</b>		
Not energy efficient - higher running costs		
England, Scotland & Wales		