

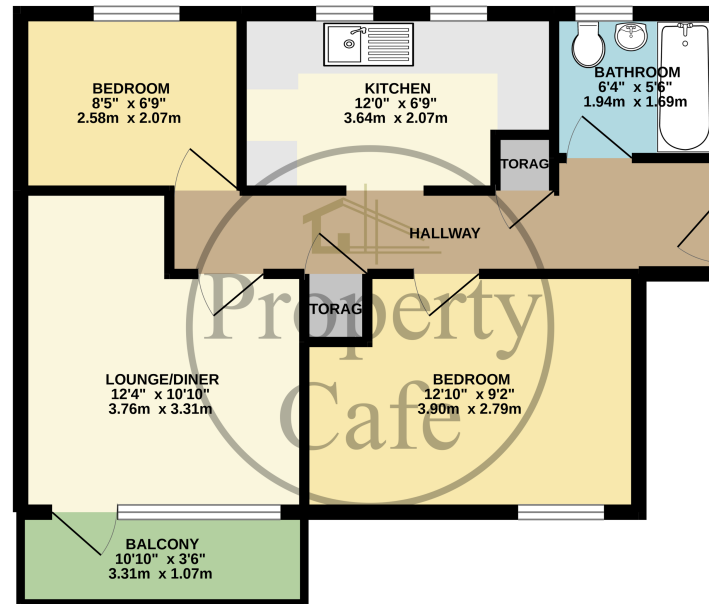

134 Preston Road, Bexhill-on-Sea, East Sussex, TN39 5BZ
£900 pcm

GROUND FLOOR
483 sq.ft. (44.9 sq.m.) approx.



Property Cafe are delighted to offer to let this well proportioned ground floor flat situated on the outskirts of Sidley high street with its array of local shops and bus routes. Accommodation in brief comprises, entrance hallway leading onto a lounge/diner, a modern fitted kitchen, a modern fitted white suite bathroom, a good size double bedroom and a good size single bedroom. Additional benefits include a private south facing balcony, a private external storage cupboard in the commonways, double glazing, electric heating, neutral white decor and a secure communal entrance. The property is available now on a long let and children are welcome. A minimum annual income of £27,000 per household is required to be eligible and early internal viewing are highly recommended. For additional information or to arrange your internal viewing, please contact our Bexhill office on 01424 224488 Option 2.

1x Week holding fee: £207.69

5x Week security deposit: £1038.46

Minimum income required (30x rent): £27,000 p.a



Energy Efficiency Rating		
	Current	Potential
Very energy efficient - lower running costs		
(92+) A		
(81-91) B		
(69-80) C		73
(55-68) D		
(39-54) E	49	
(21-38) F		
(1-20) G		
Not energy efficient - higher running costs		
England, Scotland & Wales		EU Directive 2002/91/EC

Bedrooms: 2
Council Tax: Band A
Council Tax: Rate 1626
Parking Types: On Street.
Heating Sources: Double Glazing. Electric.
Electricity Supply: Mains Supply.

- Neutral decor.
- Double glazing and electric heating.
 - Two bedrooms.
 - Close to Sidley high street.
- South facing lounge with private balcony.

Receptions: 1
EPC Rating: E (49)
Water Supply: Mains Supply.
Sewerage: Mains Supply.
Broadband Connection Types: FTTC.
Accessibility Types: Lateral living. Not suitable for wheelchair users.

- Secure communal entrance.
 - Good size kitchen.
 - Good size bathroom.
 - Purpose built block.
- Available now on a long let.