



10 Elizabeth Close, Barnstaple, Devon, EX31 3AH





10 Elizabeth Close, Barnstaple, Devon, EX31 3AH

Guide Price £495,000

Situated amongst the 'Royal Roads' that sit atop Sticklepath Hill and provide a peaceful location as well as convenient access to the town centre and to the Roundswell retail park, this property further benefits from a tucked away location at the end of a quiet cul de sac. Having been extended by a previous owner, the property now offers beautifully presented and deceptively spacious accommodation. From the canopied FRONT ENTRANCE PORCH, the front door opens to reveal the HALLWAY with space for cloaks and a useful DOUBLE STORAGE CUPBOARD with radiator and shelving. High quality oak doors lead off providing access to the SITTING ROOM, a bright double aspect room with a pair of windows overlooking the garden and extensive bifold doors onto the rear garden. Adding to the room's warm and inviting feel is a living flame gas fire in contemporary surround. The impressive KITCHEN/DINING ROOM is a bright, double aspect room with large picture window overlooking the garden as well as French doors to the garden. The high quality fitted kitchen provides ample eye and base level storage and larder cupboard as well as integrated appliances including fridge, dishwasher, 5 burner gas hob with extractor hood over and eye level double oven. Off of the kitchen is a useful UTILITY ROOM, a double aspect room with windows to two sides as well as door to outside. There is worktop with inset sink and drainer, storage cupboards and space and plumbing for a washing machine. The MASTER BEDROOM is a delightful room with picture window overlooking the rear garden and a high quality EN SUITE SHOWER ROOM with tiled double shower cubicle. There are a further TWO DOUBLE BEDROOMS overlooking the front aspect, one with built in double wardrobe. The FAMILY BATHROOM has an attractive white suite, shower over bath and majority tiled walls.

10 Elizabeth Close, Barnstaple, Devon, EX31 3AH

Enviably And Peaceful Cul De Sac Location
Sought After "Royal Roads" Area Of Sticklepath
Extended 3 Bedroom Detached Bungalow
Bright Double Aspect Sitting Room With Bi-Fold Doors
Spacious Kitchen / Dining Room
Master Bedroom With En-Suite Shower Room
Two Further Double Bedrooms
Family Bathroom
Useful Utility Room
Garage And Ample Parking
Owned Solar Panels With Feed-In Tariff



Entrance Hall

Sitting Room

16' 2" x 16' 1" (4.93m x 4.90m)

Kitchen / Dining Room

19' 6" x 14' 10" (5.94m x 4.52m)

Utility Room

Bedroom One

12' 6" x 10' 10" (3.81m x 3.30m)

En-Suite Shower Room

Bedroom Two

12' 11" x 10' 10" (3.94m x 3.30m)

Bedroom Three

12' 5" x 8' 5" (3.78m x 2.57m)

Family Bathroom

9' 4" x 5' 9" (2.84m x 1.75m)

Outside

The gardens are a real feature. The FRONT GARDEN is laid to attractive block paving providing ample off road parking and giving access to the single GARAGE with electrically operated garage door, side door to garden, wall mounted recently installed high quality Worcester gas combination boiler as well as the electronic system for the power feeding from the (owned) solar panels. The attractive REAR GARDENS run along the back of the bungalow and wrap around both sides, giving a generous combination of lawn, attractive shrubs and flowers, sunny patio area with hot tub and productive fruit and vegetable garden. The gardens are bounded by a combination of mature hedging and timber fencing, with gates for access around both sides of the property.

Single Garage

SERVICES

Services: We understand all mains services to be available.

Council Tax Band: D.

Please note: Council Tax bandings can be reassessed after a change of ownership. For further information please contact the local authority.

EPC Energy Rating: TBC.

DIRECTIONS

To locate please use SatNav reference EX31 3AH

*At John Smale & Co we don't just sell houses!
Contact us now for information on all of our other services including Auctions, Commercial Property and Market leading independent financial advice.*



GROUND FLOOR

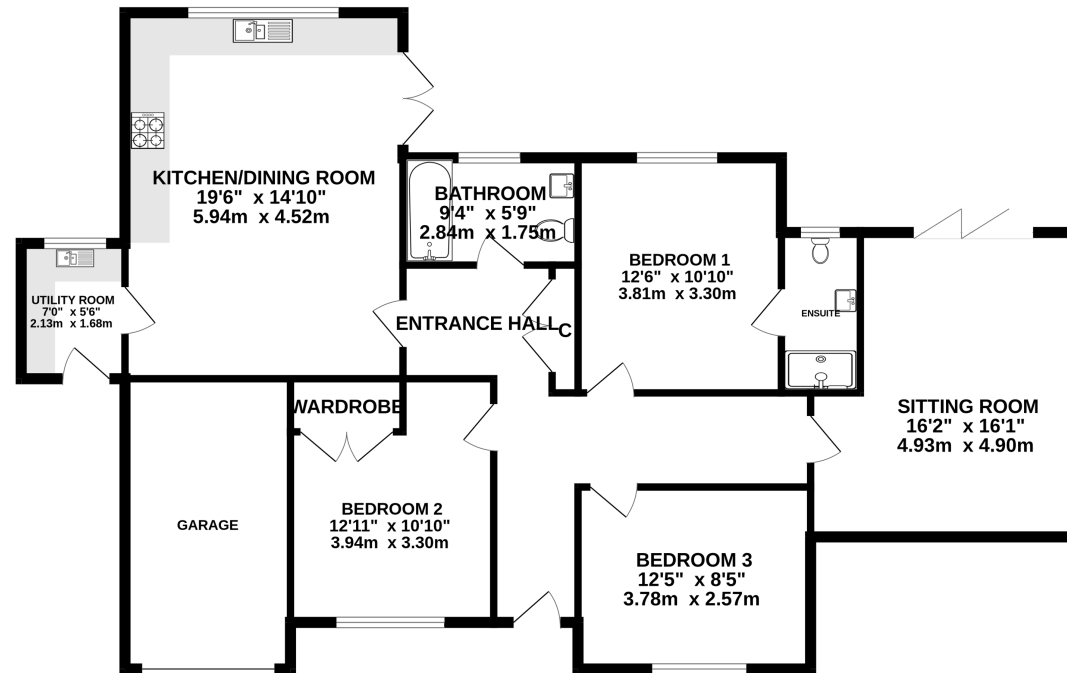

Whilst every attempt has been made to ensure the accuracy of the floorplan contained here, measurements of doors, windows, rooms and any other items are approximate and no responsibility is taken for any error, omission or mis-statement. This plan is for illustrative purposes only and should be used as such by any prospective purchaser. The services, systems and appliances shown have not been tested and no guarantee as to their operability or efficiency can be given.
Made with Metropix 62024

Any representation made by John Smale & Co Estate Agents, whether orally or in writing made in reference to these particulars, or prior to them being produced is believed to be correct, but its accuracy is not guaranteed, and it should not be relied on. Any areas, land plans, measurements, distance, or orientations are given in good faith but approximate only. The property, its services, appliances, fixtures, and fittings have not been surveyed or tested by John Smale & Co Estate Agents. Any reference to any property alterations is not a statement that any necessary planning, building regulations or other consent has been granted. The agents advise buyers to instruct their chosen solicitors, surveyors, or any other relevant property professionals to clarify any matters concerning the property.

