



15 River Gardens, Feltham. TW14 0RE

- Entrance Hall
- Spacious Lounge/ Diner
- Modern Kitchen
- Large Double Bedroom
- Modern Shower Room
- Large Garden
- Council Tax Band B
- Central Location
- New Lease On Completion
- Highly Recommended



PROPERTY DESCRIPTION

A spacious and conveniently located first floor maisonette with large side garden finished to a modern standard. Offered to the market with no onward chain and potential to extend lease. Contact our office now for more information.



ROOM DESCRIPTIONS

Entrance Hall

Approached via a front aspect wooden door, laminate flooring, space for washing machine, wall mounted combination boiler and radiator.

Lounge/ Dining Room

Front aspect double glazed window, laminate flooring, gas fireplace and wall mounted radiator.

Kitchen

Rear aspect double glazed windows, a modern range of eye and base level units with integrated ceramic sink, oven, electric hob, dishwasher and space for fridge/ freezer. Tiled floor and splash backs.

Bedroom

Rear aspect double glazed window, laminate flooring and wall mounted radiator.

Shower Room

Front aspect double glazed window with frosted glass, shower, low level WC, pedestal wash basin, heated towel rail and tiled floor and walls.

Garden

A large side garden next to river mostly laid with paving and some planted borders.

Tenure

We have been advised the lease will be extended upon completion but await confirmation of the exact length. We recommend this information be confirmed with your solicitor prior to exchange.



FLOORPLAN

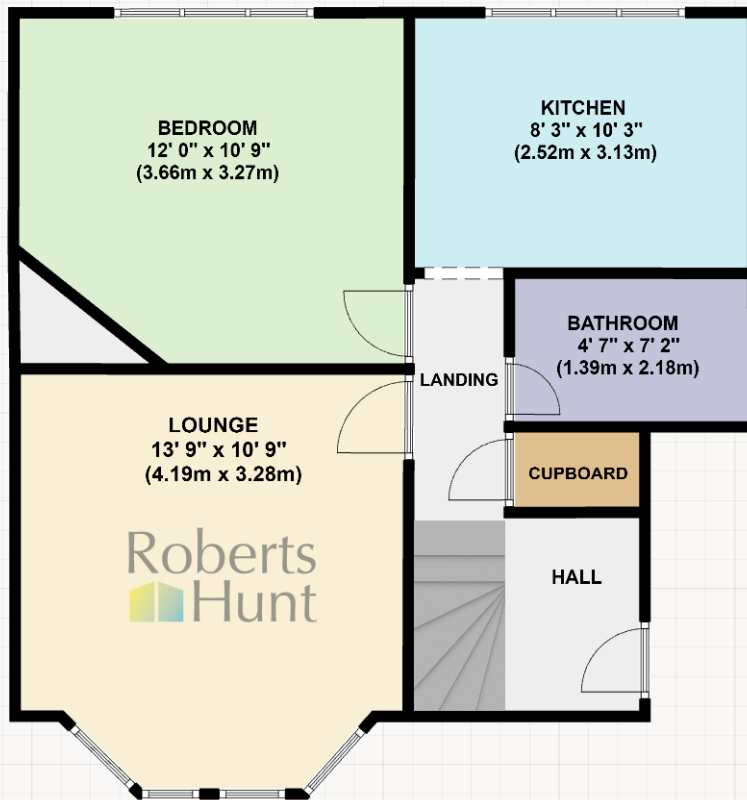

Feltham

343, Bedfont Lane, Feltham, TW14 9SD

02088937618

info@robertshunt.co.uk