

FOR SALE

£230,000

Kale Close, West Kirby, Wirral. CH48 3LE



Extremely Rare Bungalow Close to West Kirby center! This modern semi detached bungalow, situation in a highly sought-after location, is sure to prove a popular choice for buyers keen for manageable single level bungalow living within walking distance of all of West Kirby's amenities and convenience. The property has been well maintained throughout and we encourage an early viewing so as not to miss out on this fantastic opportunity.











## Ground Floor

Approx. 55.9 sq. metres (601.7 sq. feet)

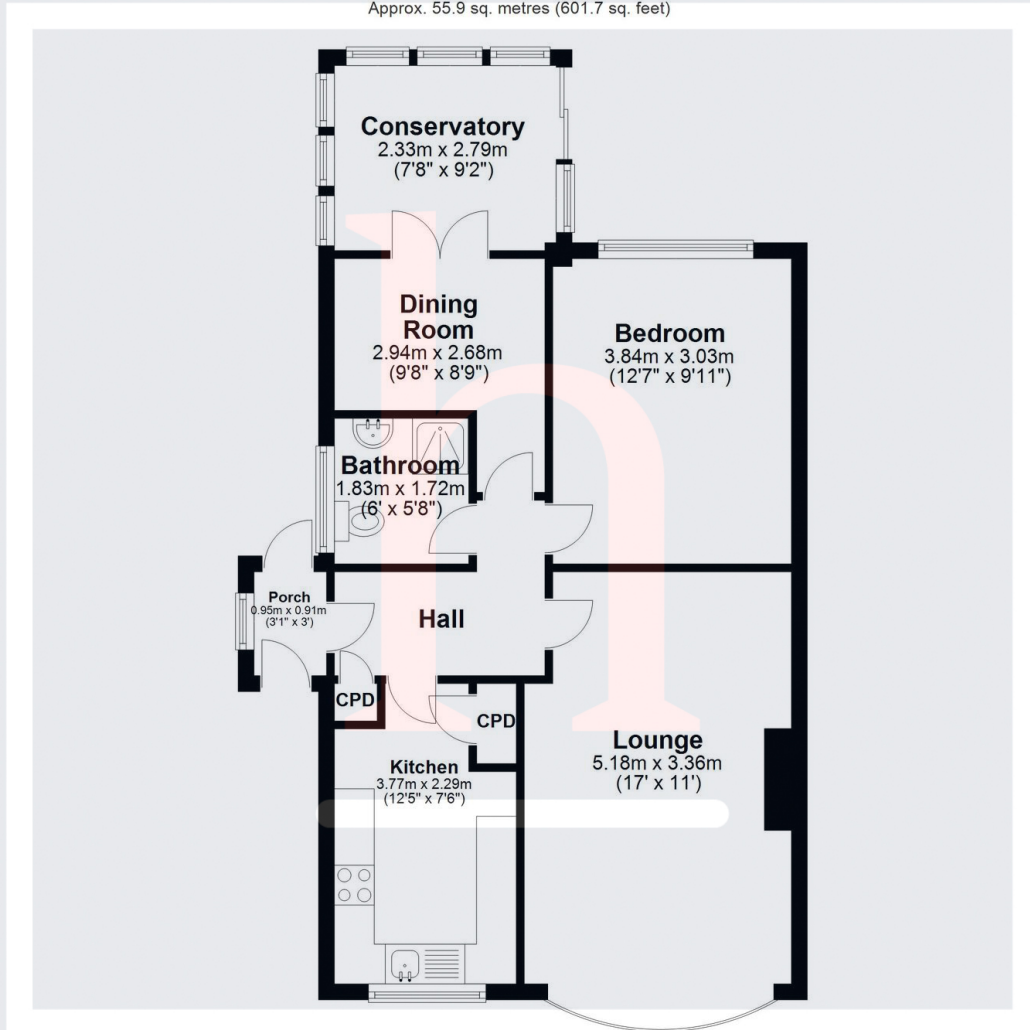

Total area: approx. 55.9 sq. metres (601.7 sq. feet)

### Energy Efficiency Rating

	Current	Potential
<i>Very energy efficient - lower running costs</i>		
(92-100) <b>A</b>		91
(81-91) <b>B</b>		
(69-80) <b>C</b>		
(55-68) <b>D</b>	68	
(39-54) <b>E</b>		
(21-38) <b>F</b>		
(1-20) <b>G</b>		
<i>Not energy efficient - higher running costs</i>		
<b>England, Scotland &amp; Wales</b>		EU Directive 2002/91/EC