

53 Faringdon Avenue, Bromley, Kent, BR2 8BP

Property Images







Ground Floor

Approx. 34.4 sq. metres (369.7 sq. feet)

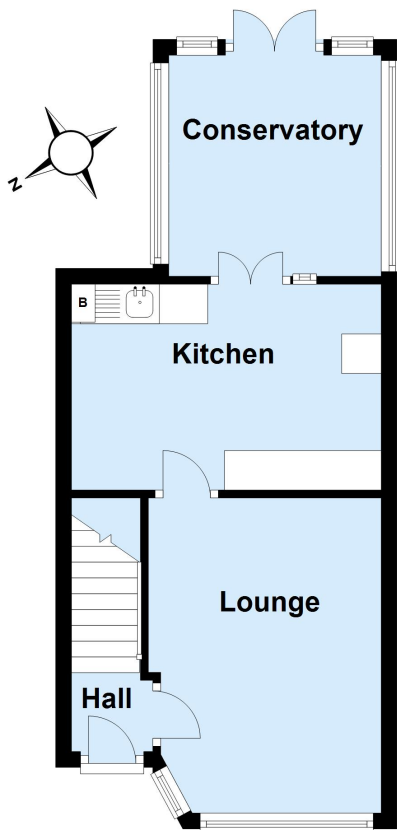

First Floor

Approx. 26.4 sq. metres (283.9 sq. feet)

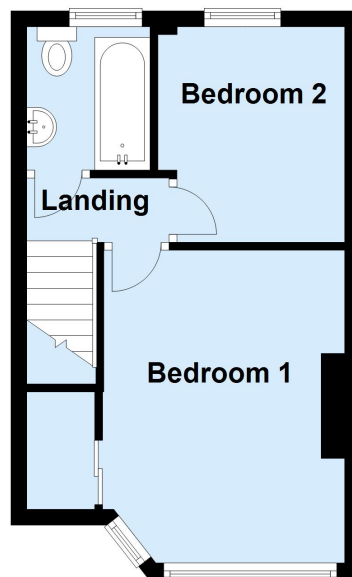

Outbuilding

Approx. 21.8 sq. metres (235.1 sq. feet)

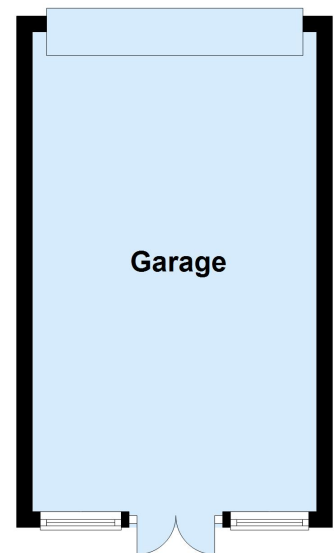

Total area: approx. 82.6 sq. metres (888.8 sq. feet)