



27a Birch Hill Avenue, Onchan, Isle of Man. IM3 4EP

Spacious detached true bungalow in a popular residential location which would benefit from modernisation



£339,950 Freehold

PROPERTY DESCRIPTION

27a Birch Hill Avenue, Onchan is a deceptively spacious detached true bungalow offered as a blank canvas for someone to put their own mark on it. Situated within a quiet residential location the property is perfectly positioned for the amenities of Onchan including shops and schools. The property comprises a large lounge/diner with dual aspect windows, a generous kitchen with access to the rear garden, two spacious double bedrooms and a shower room. Externally there is off road parking in front of the garage, an easily maintained rear garden and small wrap around lawned garden to front.

FEATURES

- Detached True Bungalow
- Quiet Residential Location
- Close to Shops, Schools and Village Walk
- Generous Lounge/Diner plus Kitchen
- 2 Double Bedrooms plus Shower Room
- Single Garage & Off Road Parking
- Easily Maintained Gardens



Property Images



FLOORPLAN



GROUND FLOOR 1092 sq.ft. (101.5 sq.m.) approx.

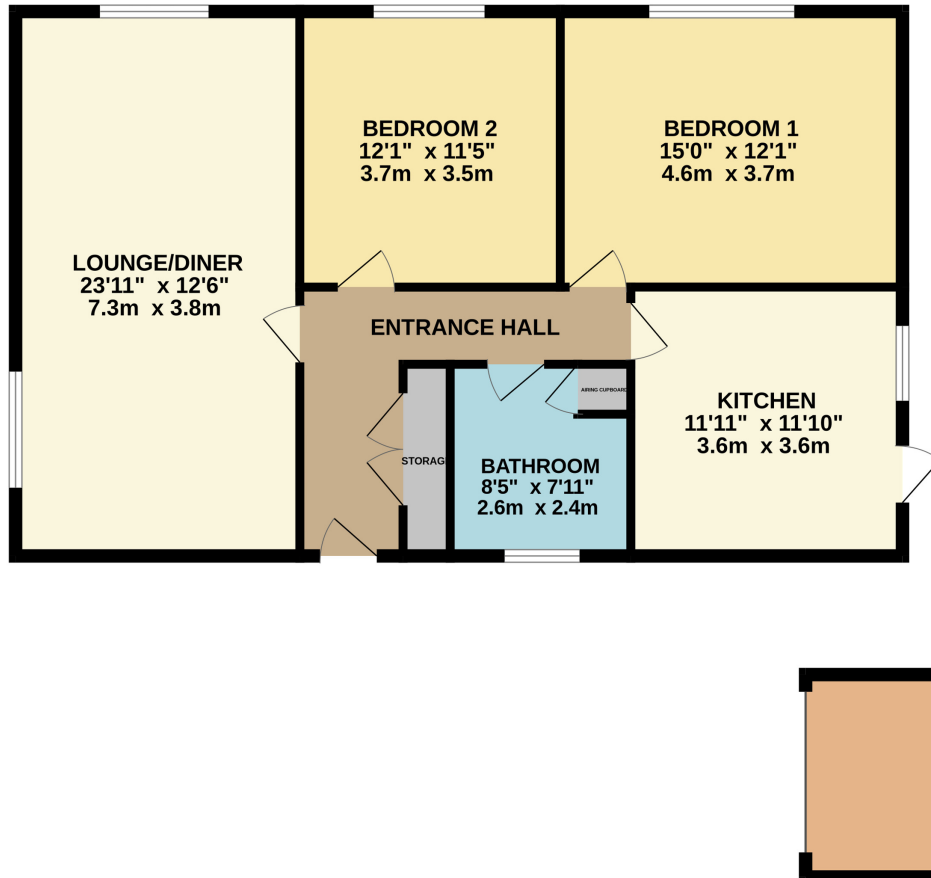

TOTAL FLOOR AREA : 1092 sq.ft. (101.5 sq.m.) approx.
Whilst every attempt has been made to ensure the accuracy of the floorplan contained here, measurements of doors, windows, rooms and any other items are approximate and no responsibility is taken for any error, omission or mis-statement. This plan is for illustrative purposes only and should be used as such by any prospective purchaser. The services, systems and appliances shown have not been tested and no guarantee as to their operability or efficiency can be given.
Made with Metropix ©2025

DISCLAIMER: Whilst Manxmove Ltd believe that these details are correct, neither Manxmove Ltd or their clients guarantee their accuracy in any way. Consequently, these details are not to be used to form part of any legally binding contract. Prospective purchasers or tenants are advised to visit this property to satisfy themselves as to the correctness of these details. Please note, we use wide angle camera lenses in order to show as much of each room as possible. This is not intended to mislead any prospective purchasers or tenants in any way and an honest verbal description is always available prior to viewing if required.

Manxmove Estate Agents - Douglas
Victoria Road, Douglas, IM2 4HD
01624 619966
info@manxmove.im