



**Burrett Road  
Wisbech  
Norfolk  
PE13 3RF**

**Offers in Excess of £225,000**

**bettermove**

## Burrett Road

### Wisbech

Bettermove are proud to present this 3 bedroom semi-detached house in the sought after area of Wisbech available with no forward chain.

The property benefits from double glazing, gas central heating throughout and has off street parking available via the 'in and out' driveway and the garage. The council tax band is A.

The interior of this beautifully presented property comprises a spacious living room, the fitted kitchen with dining area, conservatory, utility room and a convenient WC on the ground floor. The first floor consists of three bedrooms and the family bathroom. The exterior boasts a private rear garden, perfect for enjoying the summer months.

Located in the popular town of Wisbech, the property is close to a range of amenities, including shops, supermarkets, restaurants and pubs. Excellent transport connections can be found from the A47 and many local bus routes.

This exciting opportunity should not be missed! All enquiries can be made through Bettermove on 0330 004 0050.

---

You can secure the purchase immediately by paying an exclusivity deposit of £1,000.

This is not an additional fee and is returned to you on completion.

Paying this deposit ensures that the seller takes the property off the market and reserves it exclusively for you. Therefore, eliminating the risk of being gazumped by another buyer, and incurring aborted costs.

This allows you rights to purchase within a given timeframe (typically 8-12 weeks) which gives you time to prepare funding, surveys, and searches.



Ground Floor

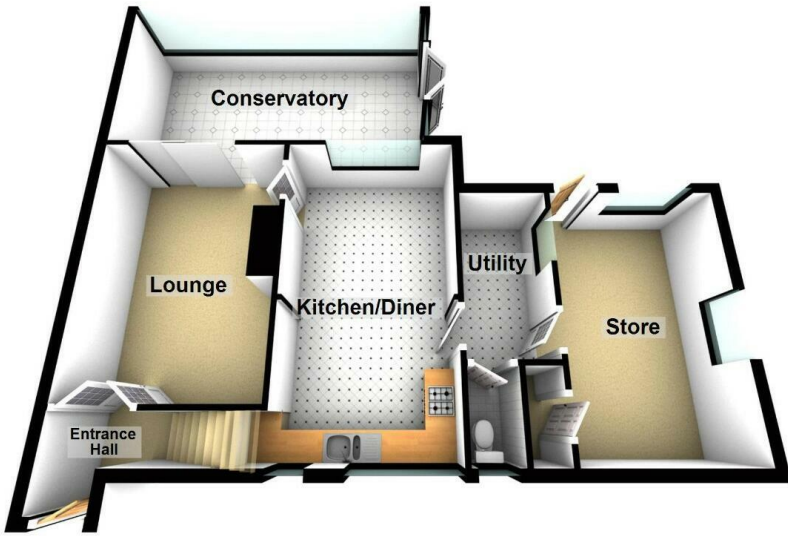

First Floor



Energy Efficiency Rating		
	Current	Potential
<i>Very energy efficient - lower running costs</i>		
(92+) <b>A</b>		
(81-91) <b>B</b>		85
(69-80) <b>C</b>	73	
(55-68) <b>D</b>		
(39-54) <b>E</b>		
(21-38) <b>F</b>		
(1-20) <b>G</b>		
<i>Not energy efficient - higher running costs</i>		
<b>England, Scotland &amp; Wales</b>	EU Directive 2002/91/EC	



20-22 Bridge End, Leeds, LS1 4DJ  
t: 0330 004 0050 e: hello@bettermove.co.uk  
[www.bettermove.co.uk](http://www.bettermove.co.uk)