



Day & Co
ESTATE AGENTS

28 Cavendish Street

Keighley

BD21 3RG



22 Cromer Grove, Keighley, West
Yorkshire, BD21 1AZ

£95,000

T: 01535 664609

W: www.dayandcoestateagents.co.uk

E: keighley@dayandcoestateagents.co.uk

- THROUGH TERRACE HOUSE
 - GAS CENTRAL HEATING & DOUBLE GLAZING
 - NO CHAIN
- TWO BEDROOMS
 - YARD & GARDEN
 - EPC RATING D

SUMMARY

** STONE THROUGH TERRACE, TWO BEDROOMS, LOUNGE & DINING KITCHEN, GAS CENTRAL HEATING, DOUBLE GLAZING, YARD & GARDEN, NO ONWARD CHAIN, EPC RATING D **

FULL DESCRIPTION

Off interest to a variety of buyers is this two bedroom through terrace house situated in this popular and convenient residential location with good access to local schools and Keighley town centre. The accommodation comprises of the living room, dining dining kitchen has a range of base and wall mounted units, under stairs storage cupboard. To the first floor there are two bedrooms, the bathroom has a three piece suite in white comprising of a bath with shower over, WC, wash hand basin. Gas central heating and double glazing. Outside yard and garden. No onward chain, EPC rating is D

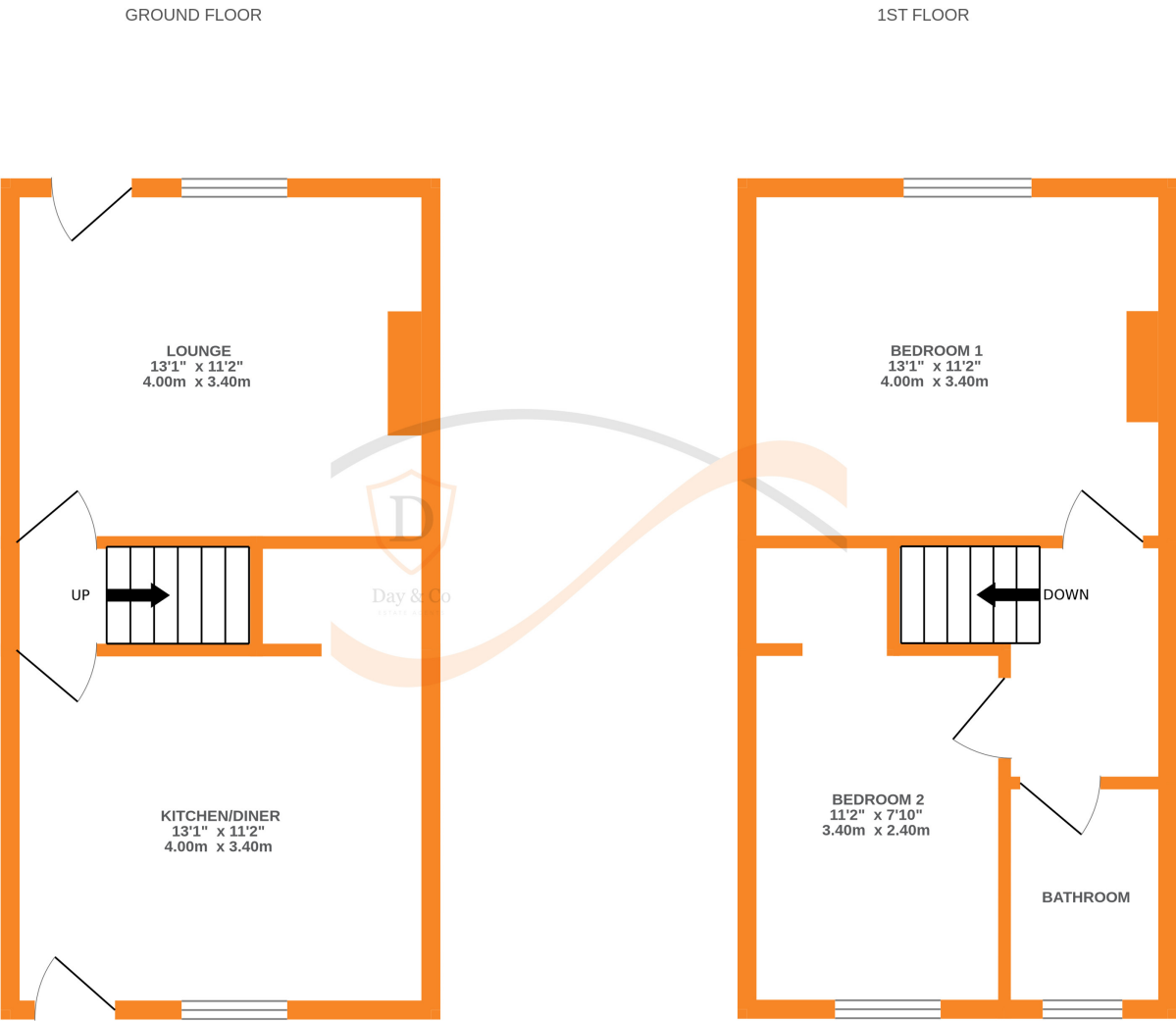

Whilst every attempt has been made to ensure the accuracy of the floorplan contained here, measurements of doors, windows, rooms and any other items are approximate and no responsibility is taken for any error, omission or mis-statement. This plan is for illustrative purposes only and should be used as such by any prospective purchaser. The services, systems and appliances shown have not been tested and no guarantee as to their operability or efficiency can be given.
Made with Metropix ©2025