



FOR SALE

£170,000

New Chester Road, Bromborough, Wirral. CH62 3LE

The perfect first home! This is a tastefully decorated and well maintained three bedroom mid-terrace home in the popular residential area of Bromborough. The property would make an ideal first home and it benefits from being nearby to The Croft Retail Park and motorway links.

The accommodation comprises an entrance hallway, spacious lounge, kitchen with access to the bathroom and conservatory with further access to the WC. To the first floor, there are three good size bedrooms with the master offering a handy storage cupboard. In addition, the property boasts a front garden, lovely rear garden complete with patio area and off-road parking for one car which could be extended to accommodate two.

Ground Floor

Lounge

14' 1" x 12' 10" (4.29m x 3.91m)

Kitchen

14' 2" x 8' 11" (4.32m x 2.72m)

Conservatory

17' 4" x 7' 1" (5.28m x 2.16m)

Bathroom

4' 8" x 5' 10" (1.42m x 1.78m)

WC

2' 6" x 4' 6" (0.76m x 1.37m)

First Floor

Bedroom

17' 3" x 10' 10" (5.26m x 3.30m)

Bedroom

9' 10" x 11' 0" (3.00m x 3.35m)

Bedroom

7' 1" x 8' 2" (2.16m x 2.49m)





Ground Floor

1st Floor

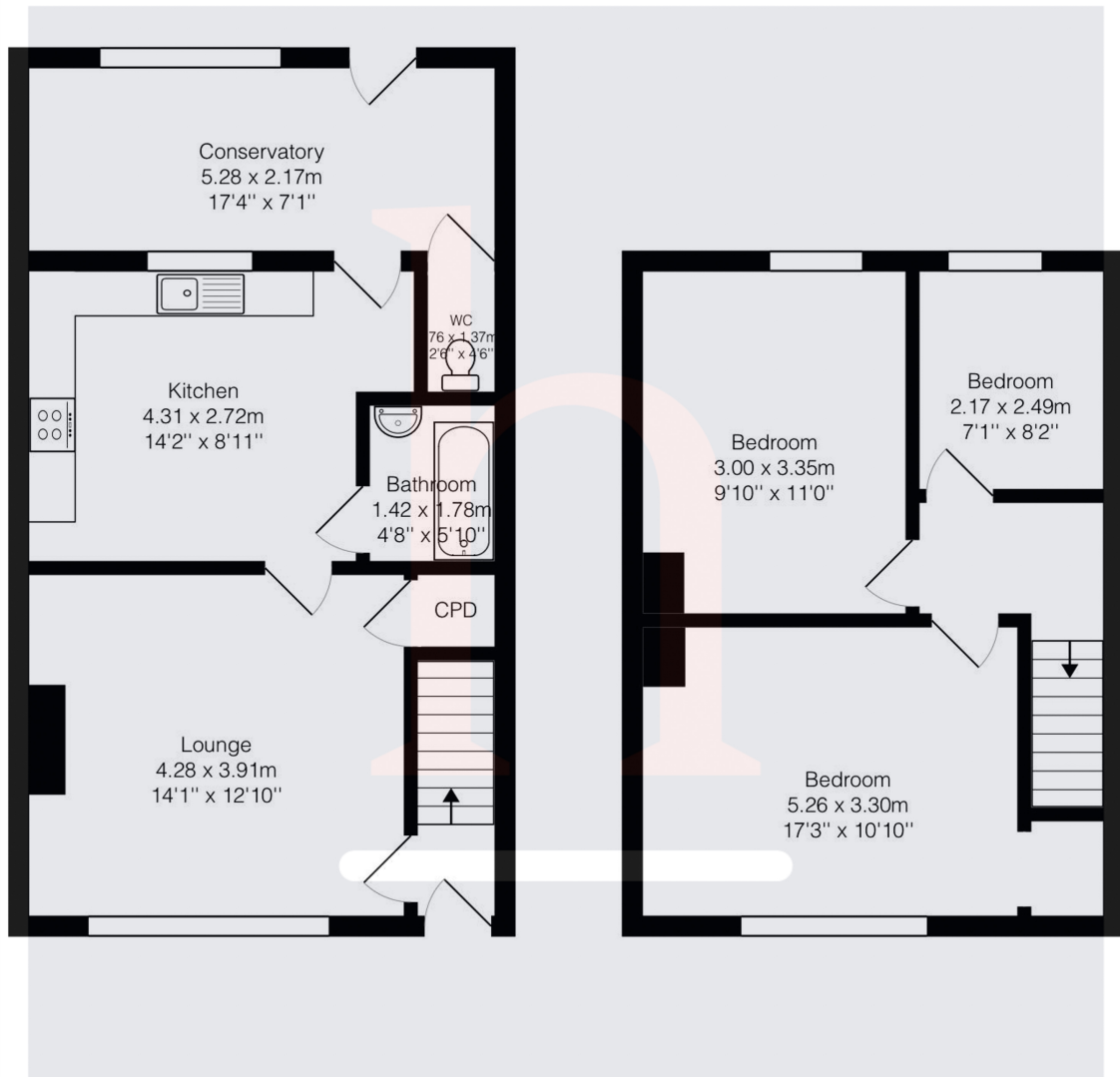

Total Area: 90.4 m² ... 973 ft²

All measurements are approximate and for display purposes only.

Energy Efficiency Rating		Current	Potential
Very energy efficient - lower running costs			
(92+)	A		
(81-91)	B		
(69-80)	C		80
(55-68)	D	56	
(39-54)	E		
(21-38)	F		
(1-20)	G		
Not energy efficient - higher running costs			
England, Scotland & Wales		EU Directive 2002/91/EC	