



# Regal Court

Bancroft | Hitchin | SG5 1LJ  
[www.stonegate-estates.co.uk](http://www.stonegate-estates.co.uk)



# REGAL COURT

## Property Description

Offered with vacant possession is this well-located second floor one bedroom apartment situated in Regal Court, a well-regarded private retirement development situated just off Bancroft in central Hitchin.

The property offers no chain and has communal lounges, residents gardens and a development manager on site.

A spacious kitchen with plumbing for a washing machine, views over Hitchin and a shower room along with a new 153 year lease make this a good retirement choice.

Hitchin town provides a broad range of shops and a regular traditional market, together with a good selection of restaurants, bars and pubs within its historic centre. The town also provides a swimming centre, theatres and a library, whilst the commuter is served by the main line railway station (Kings Cross - 30 minutes) and direct links to the A1(M).



**£115,000 Leasehold**



### Floor Plan

Approx. 37.1 sq. metres (399.4 sq. feet)

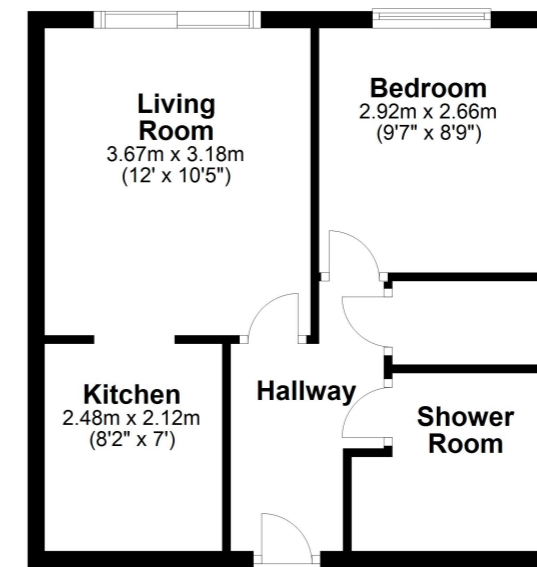

Total area: approx. 37.1 sq. metres (399.4 sq. feet)

All measurements shown are approximate and for guidance only. Garages and workshops are not included in any gross floor areas unless integral to the main building where they will be included.  
Plan produced using PlanUp.



- One Bedroom Retirement Apartment
- New Lease
- Town Centre Location
- Vacant
- Resident House Manager
- Communal Gardens
- Residents Lounge's
- Parking

EPC Rating:

Stonegate Estate Agents

01462 438979

[sales@stonegate-estates.co.uk](mailto:sales@stonegate-estates.co.uk) | [www.stonegate-estates.co.uk](http://www.stonegate-estates.co.uk)

